

**One Hundred and Seventeenth
Annual Meeting**

**SOUTHERN
ASSOCIATION OF
AGRICULTURAL
SCIENTISTS**

2020 Program Book

Louisville, Kentucky
January 31-February 5, 2020



Omni Louisville Hotel
400 S. 2nd Street
Louisville, KY 40202



For their support of the Southern Association of Agricultural Scientists, ***special thanks*** are expressed to:

For the Reception:

**Southern Farm Bureau Life
Insurance Company**

Mr. Randy Veach, Chairman & President
1401 Livingston Lane - 39213-8098
P. O. Box 78
Jackson, Mississippi 39205
(601) 981-7422

For printing of the programs:

LSU AgCenter

Dr. Bill Richardson, Vice-Pres & Dean
101 J. Norman Efferson Hall
110 Union Square
Baton Rouge, LA 70803
(225) 578-4164
Email: brichardson@agcenter.lsu.edu



***Conference participants are encouraged
to thank the sponsors for their support of
SAAS.***

2020

Southern Association of Agricultural Scientists Annual Meeting and Conference

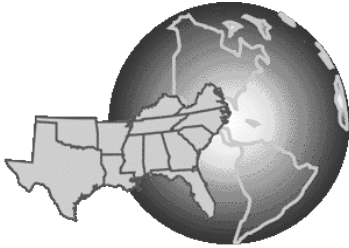

Louisville, Kentucky

SAAS strives to forward the interests of Southern agriculture by bringing agricultural leaders in the educational field and industry together. The association instructs and trains individuals for the purpose of improving or developing their capabilities relating to educational activities in service to the public arena. SAAS also offers young scientists an opportunity to present papers resulting from their research, extension, or other efforts and to exchange knowledge with other leaders.

**Thank you for attending and
taking part in this effort!**

Visit the SAAS website: www.saasinc.org

TABLE OF CONTENTS

SAAS

SAAS Registration	1
SAAS Business Meeting.....	1
Executive Committee Meetings	1

Associations

Associations Registration Information...2	
Programs	
Administrative Heads of Ag	3
Agricultural Communications.....	4
Agricultural Economics	9
Agricultural Education.....	41
Agronomy	44
Biochemistry & Biotechnology*	
Horticultural Science.....	55
Rural Sociological.....	91

*(NOTE: Biochemistry & Biotechnology will not be meeting with SAAS this year.)

SAAS 2019-20 Officers

Executive Committee	104
Association Officers	104

Meeting Room Location.....	107
-----------------------------------	------------

Meeting Room Floor Diagrams

Omni Level 2.....	108
Omni Level 3.....	109

SAAS PROGRAM

SAAS Registration

Sunday, February 02 - 8:00 am - 4:00 pm

Monday, February 03 - 8:00 am - 4:00 pm

Tuesday, February 04 - 8:00 am – Noon
Second Street Prefunction (Second Floor)

SAAS General Business Meeting

Sunday, February 02

4:00 pm – 4:15 pm

Commonwealth 3



SAAS Social & Super Bowl Party

Sponsored by Southern Farm Bureau
 Life Insurance Co.

Jackson, Mississippi and Affiliates

5:00 pm - Sunday, February 02

Griff's Sports Restaurant

133 W. Liberty (directly across street)

Executive Committee Meetings

Sunday, February 02

SAAS Board Meeting

2:30 pm – 3:30 pm

Commonwealth 3

Tuesday, February 04

SAAS Board Breakfast Meeting

7:30 am – 9:30 am

Clifton

REGISTRATION INFORMATION

Fees: When you register on-site, a receipt will be provided for reimbursement. Fees are association fees + SAAS fee (\$60 for professionals, \$5 for graduate students & \$0 for undergrads).

Admin Heads of Agric	Sunday – 8am-4pm Monday – 8am-4pm Tuesday – 8am-Noon 2 nd Street Prefunction – 2 nd Floor
Ag Comm	Sunday – 8am-4pm Monday – 8am-4pm Tuesday – 8am-Noon 2 nd Street Prefunction – 2 nd Floor
Ag Econ	Sunday - Noon-4pm Monday - 7am-5pm Tuesday – 8am-5pm 2 nd Street Prefunction – 2 nd Floor
Ag Educ	Saturday - 3pm-6pm Sunday - 8am-10am Monday - 8am-10am 2 nd Street Prefunction – 2 nd Floor
Agron	Saturday – 10am-4pm Monday - 7am-5pm 2 nd Street Prefunction – 2 nd Floor
Biochem	Not meeting with SAAS this year.
Horticulture	Friday - 7am-6pm Hotel Lobby
	Saturday - 7am-6pm Sunday - 7am-10:45am 2 nd Street Prefunction – 2 nd Floor
Rural Soc	Sunday – 7:45am-3:30pm Monday – 7:45am-3pm 2 nd Street Prefunction – 2 nd Floor

Posters:

All posters will be displayed in
 Olmsted 4 (Level 2).

ADMIN. HEADS OF AGRICULTURE

Southern Association of Agricultural Scientists
Administrative Heads of Agriculture Section
(AHS)

Monday, February 03
11:00 am – 3:00 pm
Administrative Heads of
Agriculture Section (AHS) Meeting
Clifton
Lunch will be served.

AGRICULTURAL COMMUNICATIONS

2020 National Agricultural Communications
Symposium
February 2-3, 2019 | Louisville, Kentucky | Omni
Louisville Hotel
Concurrent with Southern Association of
Agricultural Scientists (SAAS)

Sunday, Feb. 2

7:30 a.m. **Breakfast & Networking,**
Commonwealth 8

8:15 a.m. **Welcome, Introductions &
Updates,** *Commonwealth 8*

8:45 a.m. **Professional Development
Session I,** *Commonwealth 8*

- *Sharpen your focus: A guide to purposeful photography and audience understanding* – Jessica Spence, Tobin Redwine, Carrie Baker, & Lacey Roberts – Texas A&M University (20 min)
- *Operant Subjectivity as reflection and research: What is a Q Sort and why should you care?* – Tobin Redwine, Holli Leggette, Jean Parrella, & Jessica Spence – Texas A&M University (40 min)

9:45 a.m. **Break**

10:00 a.m. **Paper Session I,** *Commonwealth 8*

Looking for Information: An Exploratory Study to Explain Public Information-Seeking Behaviors About Mosquito Control Topics

Shelli D. Rampold, University of Florida; Melissa Cater, Louisiana State University; Ricky W. Telg, University of Florida

What's All the Buzz About? An Assessment of the Online Content Of Florida Mosquito Control Programs

Ashley McLeod-Morin, Michaela Shaw, Caroline Roper Warwick, Ricky Telg, University of Florida

AGRICULTURAL COMMUNICATIONS

Communicating Through Calamity: A Look at Rural and Urban Extension Professionals' Communication Before, During, and After a Hurricane
Angie B. Lindsey, Sandra Anderson, Lauri M. Baker, Kevin W. Kent, University of Florida

11:00 a.m. **Professional Development Session II, Commonwealth 8**

- *Faculty Mentorship Professional Development – Taylor Ruth, University Nebraska-Lincoln; Ricky Telg, University of Florida*

11:45 a.m. **Lunch (on your own)**

1:00 p.m. **Paper Session II, Commonwealth 8**

Leveraging Skype in the Classroom for Science Communication: A Streaming Science – Scientist Online Approach
Peyton N. Beattie, Jamie L. Loizzo, Kevin W. Kent, Christine L. Krebs, Teresa E. Suits, J. C. Bunch, University of Florida

Bats and Beyond: Communicating Wildlife and Climate Change Empathy to Youth Through an Electronic Field Trip
Peyton N. Beattie, Jamie L. Loizzo, Kevin W. Kent, Christine L. Krebs, Teresa E. Suits, J. C. Bunch, University of Florida

Impact of Animating Infographics About Genetic Modification on Information Recall
Jessica Holt, Alexa J. Lamm, Kristin Gibson, Kevan Lamm, University of Georgia; Jason Ellis, Kansas State University; Joy N. Rumble, The Ohio State University

Identifying Roadblocks and Improving Strategies to Foster New Media Technology Adoption in Extension
Kelsey Tully, Jason D. Ellis, Kansas State University

AGRICULTURAL COMMUNICATIONS

2:15 p.m. **Professional Development Session III, Commonwealth 8**

- *Using Yellowdig, a Social Learning Platform, to Promote Authentic Online Student Interaction – Kelsi Opat & TaylorAnn Washburn, Texas Tech University (15 min)*

2:30 p.m. **Break**

2:45 p.m. **Poster Session** (Setup earlier), *Olmstead 4*

4:00 p.m. **SAAS General Business Meeting, Commonwealth 3**

5:00 p.m. **SAAS Social Reception/Super Bowl Party – Griff's Restaurant**

Monday, Feb. 3

7:45 a.m. **Professional Development Session III, Commonwealth 8**

- *Shorten grading time: Using specifications (specs) grading in a writing intensive course – Cara Lawson, Texas Tech University (15 min)*

8:00 a.m. **Paper Session III, Commonwealth 8**

Do Touch that Dial: A Guide to Continuous Response Measurement in Agricultural Communications
Cara R. Lawson, Texas Tech University; Laura M. Fisher, University of Kentucky; Lauren LaGrande, Oregon State University; Kelsi Opat, Texas Tech University

Unobserved Interaction Between Participants and Discussion Topics Within Focus Group Discussions: An Application of Social Network Analysis
Yu Lun Wu, Joy N. Rumble, The Ohio State University; Taylor K. Ruth, University of Nebraska-Lincoln; Alexa J. Lamm, University of Georgia; Jason D. Ellis, Kansas State University

AGRICULTURAL COMMUNICATIONS

Technically Speaking: Technical Skills Needed for Agricultural Communication Baccalaureate Graduates

Arthur Leal, University of Tennessee; Kati Lawson, Ricky Telg, University of Florida; Joy Rumble, The Ohio State University

The Experience of Female Graduate Student Researchers in the Agricultural Sciences

Whitney A. Stone, University of Florida; Catherine E. Dobbins, Maddison Holder, & Abigail Borron, University of Georgia

AGRICULTURAL COMMUNICATIONS

Milk Does a Label Good: An Experimental Study of the Impact of Beverage Labeling on Consumer Perceptions

Sharon P. Wagner, Hart Blanton, Texas A&M University; Tracy Rutherford, Virginia Tech

11:00 a.m. **Business Meeting,**
Commonwealth 8

12:30 p.m. **Adjourn**

9:15 a.m. **Professional Development**
Session IV, Commonwealth 8

- *A sharpened focus: Audience analysis and understanding through GooseChase – Jessica Spence, Tobin Redwine, Carrie Baker, & Lacey Roberts – Texas A&M University*

9:30 a.m. **Break**

9:45 a.m. **Paper Session IV, Commonwealth 8**

Growing Grassroots: Predicting Policy Engagement and Communication Among Members of Agricultural Organizations

Afiya De Sormeaux, Shelli D. Rampold, Ricky Telg, University of Florida

Agriculture, Food, and Natural Resource Opinion Leaders in Online Environments

Tiffany M. Rogers-Randolph, Kansas State University; Lisa K. Lundy, Ricky Telg, University of Florida; Joy N. Rumble, The Ohio State University; Brian Myers, & Angie Lindsey, University of Florida

The Media's Influence on Climate Change Beliefs: A Partisan Comparison

Taylor K. Ruth, University of Nebraska-Lincoln; Blake C. Colclasure, Doane University

AGRICULTURAL ECONOMICS

AGRICULTURAL ECONOMICS

Southern Agricultural Economics Association
52nd Annual Meeting Program
February 1-4, 2020
Omni Louisville Hotel
Louisville, KY

SAEA OFFICERS

President..... Krishna Paudel
President-Elect Tim Woods
Past-President Deacue Fields
Director Luis Ribera
Director Michael Vassalos
Director Chris Boyer
Secretary Nathan Smith
Treasurer Jeffrey L. Jordan
Editors: Michael Reed and
Sayed Saghaian

February 1, 2020 5 pm – 7 pm
New Officer Orientation
Omni Louisville Hotel
Olmsted 2

February 1, 2020 6 pm – 8 pm
Quiz Bowl Orientation and Refreshments
Omni Louisville Hotel
Olmsted 1

February 2, 2020 8:00 am – 2:00 pm
SAEA Executive Council
Clifton

February 2, 2020 8:00 am – 4:00 pm
Quiz Bowl Competition
Cherokee Triangle, Germantown & Old Louisville

February 2, 2020 8:00 am and 4:00 pm
Quiz Bowl Break / Recruitment Fair
Germantown Prefunction

February 2, 2020 12:00pm – 4:00 pm
Registration
Second Street Prefunction

February 2, 2020 2:00 pm – 3:30 pm
Graduate Students Networking Reception
Olmsted 1

February 2, 2020 2:00 pm – 4:00 pm
Department Heads' Meeting
Clifton

AGRICULTURAL ECONOMICS

February 02, 2020 4:00 pm – 4:15 pm
SAAS General Business Meeting
Commonwealth 3

February 02, 2020 5:00 pm
Super Bowl Party
Sponsored by Southern Farm Bureau Life
Insurance Co.
Jackson, Mississippi and Affiliates
Griff's Sports Restaurant
133 W Liberty (directly across street)

February 3, 2020 7:00 am – 5:00 pm
Registration
Second Street Prefunction

February 3, 2020 8 am – 12:00 pm
Quiz Bowl Competition
Cherokee Triangle, Germantown & Old Louisville

February 3, 2020 8:00 am and 4:00 pm
Quiz Bowl Break / Recruitment Fair
Germantown Prefunction

OS1: Organized Symposium
Online Teaching: Are You Closer Than You
Think?
February 3, 2020 8:30 am – 10:00 am
Olmsted 7

Organizer: Roger Brown, University of Kentucky;
Michael Vassalos, Clemson University
Moderator: Roger Brown, University of Kentucky

Participants:

Jerrold Penn, Louisiana State University
Michelle Kibler, Illinois State University
Michael Vassalos, Clemson University
Catherine DiBenedetto, Clemson University
Roger Brown, University of Kentucky

SP01: Selected Papers
Agricultural Production 1
February 3, 2020 8:30 am – 10:00 am
Rye

Session Chair: Richard Nehring, USDA/ERS

What do Late Calving Cows Cost?

By Christopher Boyer (1), Kenneth Burdine (2), Justin Rhinehart (1) and Charles Martinez (3)
1: University of Tennessee; 2: University of Kentucky;
3: Texas A&M University

AGRICULTURAL ECONOMICS

The Role of Social Networks in Precision Leveling and Cover Crops Choices for Producers in the Arkansas Delta

By Victoria Paige Bailey and Kent Kovacs, University of Arkansas

Pest Management: Weed Management and Reliance on Older Herbicides

By Richard Nehring, USDA/ERS

Impact of Climate Change on No-Till Winter Wheat in Texas

By Jared Netardus, Jacob Manlove, Edward Osei and Chandra Andrew, Tarleton State University

Profitability of Pasture Aeration as Affected by Timing

By Michael Peter Popp (1), Amanda J Ashworth (2), Karen Renee Lindsay (1), Phillip R Owens (3) and Melissa McCarver (4)

1: University of Arkansas; 2: USDA ARS Poultry Production and Product Safety Research Unit, Fayetteville, AR, US; 3: USDA-ARS Dale Bumpers Small Farms Research Center, Booneville, AR, US; 4: Beaver Watershed Alliance, Springdale, AR, US

Using Hamiltonian Monte Carlo to Estimate Crop Response Functions with Stochastic Plateaus

By John N. Ng'ombe and B. Wade Brorsen, Oklahoma State University

The Economic Use of Cotton Gin Trash: A Case Study of Lubbock County

By Abidemi Toyosi Adisa and Michael Farmer, Texas Tech University

SP02: Selected Papers Demand Analysis

**February 3, 2020 8:30 am – 10:00 am
Crescent Hill**

Session Chair: Rafael Bakhtavoryan, Texas A&M University-Commerce

Empirical Analysis of Factors Influencing Households' Demand for Omega-3 Enriched Eggs in the United States

By Rafael Bakhtavoryan and Jose Lopez, Texas A&M University-Commerce

U.S. Apparel Import Demand with Source-Differentiated AIDS Model

By Bing Liu (1), Darren Hudson (1), and Jon Devine (2)

1: Texas Tech University; 2: Cotton Incorporated

AGRICULTURAL ECONOMICS

Brisket Demand: Smokin' Hot! Or Low and Slow?

By Charles Canuto Martinez (1), David P. Anderson (2), and Christopher N. Boyer (1)

1: University of Tennessee; 2: Texas A&M University

U.S. Consumer's Intake of Food At Home and Food Away from Home as A Complex Economic System

By Faith Abigail Parum and Senarath Dharmasena, Texas A&M University

Producer Perceptions and Willingness to Adopt Adaptive Multi-Paddock Grazing

By McKenna Elizabeth Clifford and Melissa G.S. McKendree, Michigan State University

The effect of convex self-control cost in real effort and food choices

By Samir Huseynov, Marco A. Palma, and Alexander L. Brown, Texas A&M University

A refined method to elicit consumers' truthful willingness- to-pay for pecan

By Yiwen Zhao and Bachir Kassas, University of Florida

SP03: Selected Papers Agricultural Production and Finance February 3, 2020 8:30 am – 10:00 am Barley

Session Chair: Mark Raulston, Texas A&M University

An Economic Valuation of Biotic Pollination Services in Georgia

By John Bergstrom, Susana Ferreira, and Rachel Pless, University of Georgia

Sensitivity of Representative Farm Financial Viability to Alternative Debt Levels and Interest Rates

By Mark Raulston, Henry L. Bryant, Bart L. Fischer, Joe L. Outlaw, and George M. Knapek, Texas A&M University

Evaluating Strategies to Drought Proof the Ranch

By Justin Reynaldo Benavidez, Pancho J. Abello, David P. Anderson, Charley C. Martinez, and Anastasia W. Thayer, Texas A&M AgriLife Extension

A Portfolio Approach to Crop Histories on Mean Yields

By William Bennett Bradley, Jr (1), Park Eunchun (1), and Stevens Andrew (2)

1: Mississippi State University; 2: University of Wisconsin-Madison

AGRICULTURAL ECONOMICS

Merges and Acquisitions under Market Power: The case of the U.S. Agribusiness Industry

By Yejun Choi (1), Dayton M. Lambert (1), and Carlos O. Trejo-Pech (2)

1: Oklahoma State University; 2: The University of Tennessee

Examining Productivity Growth of Farm Credit System

By Madhav Regmi, New Mexico State University

Food security analyses using binary-outcome models with observable non-binary outcomes

By Anne Oluwatosin Musa, Carlos Enrique Carpio, and Ryan Blake Williams, Texas Tech University

SP04: Selected Papers

International Issues

February 3, 2020 8:30 am – 10:00 am

Butchertown

Session Chair: Felipe Silva, Clemson University

Estimating Demand Elasticities for Rice in Benin

By Ogoudele Simon Codjo (1), Alvaro Durand-Morat (2), Lawton Lanier Nalley (2), Rodolfo Nayga (2), and Eric Wailes (2)

1: University of Florida; 2: University of Arkansas

The Impact of Refugee Immigrants on Germany's Agricultural Trade

By Yunzhe Zhu, University of Kentucky

Substitution or Complement: How do Contractual and Relational Governance Affect Chinese Farmer Cooperative Members' Organizational Commitment?

By Lijun Zeng (1), Junyi Wan (1), and Krishna P. Paudel (2)

1: South China Agricultural University; 2: Louisiana State University (LSU)

To sell or not to sell? The effect of distance to market on Peruvian farmers' decision of marketing their production

By Felipe Silva (1), Michael Vassalos (1), Aaron Turner (1), Mateus Neves (2), and Carlos Freitas (3)

1: Clemson University; 2: Federal University of Viçosa; 3: Rural Federal University of Rio de Janeiro

Application of Stochastic Production Frontier in the Estimation of Technical Efficiency of Village Poultry Subsector in Kenya

By James O. Bukenya (1) and Sylvester S. Ndzovu (2)

1: Alabama A&M University; 2: Sustainable Agriculture Community Development Programme

AGRICULTURAL ECONOMICS

Factors that Affect Feed Efficiency of Rwandan Small-Scale Broiler Production

By Ty Wolaver and Jada Thompson, University of Tennessee

The Effect of Maternal Beliefs on Parental Investment in Rural China

By Meichen Lu and Ellen McCullough, University of Georgia

OS02: Organized Symposium

Policymaking in Agriculture

February 3, 2020 10:15 am – 11:45 am

Olmsted 7

Organizer: Michael Reed, University of Kentucky

Moderator: Michael Reed, University of Kentucky

Participants:

Matt Erickson, Chief Economist, U.S. Senate Agriculture Committee

Bart Fischer, Chief Economist, U.S. House Agriculture Committee

Ryan Quarles, Commissioner of Agriculture, Commonwealth of Kentucky

SP05: Selected Papers

Marketing & Promotion

February 3, 2020 10:15 am – 11:45 am

Rye

Session Chair: Alison Grant, Purdue University

Competition Issues in the United States Beef Industry

By Yuliya Bolotova, Clemson University

Nudging away from plastic bags with charitable donations

By Sapana Bastola (1), Jerrod Penn (1), and Wuyang Hu (2)

1: Louisiana State University (LSU); 2: The Ohio State University

Economic Impact of Agriculture to Texas GDP

By Glenn Conover, Jacob Manlove, and Gracie Martin, Tarleton State University

Factors affecting the adoption of risk management strategies by small farmers in Tennessee

By Sudip Adhikari and Aditya R Khanal, Tennessee State University

AGRICULTURAL ECONOMICS

U.S. Dairy Farm Transition and Exits, 1987 to 2017

By Miyeon Son, Jessica Richard, and Dayton M. Lambert, Oklahoma State University

Distributional Effects of Reducing Meat Production in U.S. Agriculture

By Alison Grant and Jayson Lusk, Purdue University

Mexican Consumers' Preferences for U.S. and Texas Beef

By Manuel de Jesus Garcia and Carlos Enrique Carpio, Texas Tech University

SP06: Selected Papers

Price Analysis

February 3, 2020 10:15 am – 11:45 am

Crescent Hill

Session Chair: Todd Davis, University of Kentucky

A Hedonic Assessment of Beef Bull Attributes with Implicit Market Segmentation

By Minfeng Tang (1), Nathanael M. Thompson (1), Christopher Boyer (2), Nicole J. Widmar (1), Jason L. Lusk (1), Terry S. Stewart (1), Donna L. Lofgren (1), and Nick Minton (1)

1: Purdue University; 2: University of Tennessee, Knoxville

Have Kentucky Grain Farms Stopped Bleeding Working Capital? Prospects for the Next Five Years

By Todd Davis, Jonathan Shepherd, and Tyler Mark, University of Kentucky

The Amenity Value of Green Space in Georgia: A Hedonic Pricing Approach

By Fayu Chong and Susana Ferreira, University of Georgia

Benchmarking Analysis of Cattle Auction Prices in South Texas

By Samuel D. Zapata and David Anderson, Texas A&M University

Modeling the Soft Red Winter Wheat Prices Using Interval-valued Time-Series Data

By Prasanna Suratkhal and Madan Mohan Dey, Texas State University

Evolution of Fed Cattle Carcass Value

By Madeline Gabrielle Poss, Kalyn Coatney, Daniel Rivera, Thu Dinh, Josh Maples, and Randy Little, Mississippi State University

AGRICULTURAL ECONOMICS

Benefits and Costs of Wind Hazard Mitigation

By Leslie Shea Gould (1), Daniel Petrolia (1), Josh Maples (1), Reid Cummings (2), and Seong Yun (1)
1: Mississippi State University; 2: University of South Alabama

SP07: Selected Papers

Demand Analysis and Policy

February 3, 2020 10:15 am – 11:45 am

Barley

Session Chair: Alba Collart, Mississippi State University

The Incomplete Market Mechanism and the Role of the State in Agricultural Development

By Wanki Moon and Juan Taramuel, Southern Illinois University at Carbondale

Does larger package size make us consume more sugar-sweetened beverages?

By Yufeng Luo and Chen Zhen, University of Georgia

Modelling Predatory Journals Behavior Intensity and Survivability

By Carlos Trejo-Pech (1), Jada Thompson (1), and Sharon Thach (2)

1: University of Tennessee; 2: Tennessee State University

Do Federal Farm Programs Affect Efficiency and Productivity?

By Saleem Shaik, North Dakota State University

Household Meat Demand – Consumption and Expenditure Analyses

By Olumide Rinde Aborisade (1), Carlos Enrique Carpio (2), and Tullaya Boonsaeng (2)

1: Abraham Baldwin Agricultural College; 2: Texas Tech University

A Course in Digital Agriculture

By Thanos Gentimis, Maria Bampasidou, and Lawson Connor, Louisiana State University

Consumer Purchasing Response to Genetically Engineered Labeling in Vermont

By Betty Thomas (1), Linlin Fan (2), Andrew Stevens (3), Alba Collart (1), Josh Maples (1), and Ardian Harri (1)

1: Mississippi State University; 2: Penn State University; 3: University of Wisconsin, Madison

AGRICULTURAL ECONOMICS

**SP08: Selected Papers
Agricultural Production 2
February 3, 2020 10:15 am – 11:45 am
Butchertown**

Session Chair: Elizabeth Gabriela Gutierrez, Kansas State University

A risk analysis evaluation of nitrogen management with cover crops in corn production

By Hua Wang, Naveen Adusumilli, and Daniel Fromme, Louisiana State University

An Economic Analysis of Nitrogen Management Practices for Florida Carrot Production

By Fei He, Tatiana Borisova, Kevin Athearn, Charles Barrett, Robert Conway, Hochmuth, and Damian Adams, University of Florida

Optimal Beef Cow Stocking Rates in the U.S. Southern Plains

By Leann Westbrook, Eric DeVuyst, Wade Brorsen, and Laura Goodman, Oklahoma State University

A Farm-Level Economic Analysis on Implementing Water Use Efficiency (WUE) Technologies in Southeastern Wyoming

By Alicia Grahmann (1), Kristiana Hansen (1), and Dannele Peck (2)

1: University of Wyoming; 2: USDA-ARS

Historical financial performance of publicly traded agri-food companies

By Elizabeth Gabriela Gutierrez, Kansas State University

Hemp: The Next American Staple Crop?

By Megan Moore, George Knapek, Outlaw Joe, and Fischer Bart L., Texas A&M University

Evaluating Returns to Crop Insurance in the Mid-South

By Lawson Connor, Louisiana State University

**February 3, 2020 12:00 pm – 1:15 pm
52nd SAEA Annual Meetings Luncheon
Commonwealth 04/05**

**Welcome
Krishna Paudel, SAEA President**

**Presidential Address
Tim Woods, SAEA President-Elect**

**Legends vs. Quiz Bowl Champs
February 3, 2020 1:30 pm – 3:00 pm
Old Louisville**

AGRICULTURAL ECONOMICS

**3MT: Three Minute Thesis Competition
February 3, 2020 1:30 pm – 3:00 pm
Commonwealth 3**

Session Chair: James Larson, University of Tennessee

Consumer Purchasing Response to Genetically Engineered Labeling in Vermont

By Betty Thomas, Mississippi State University

Economics Benefit of Pest Risk Prediction Model: An Agent-Based Model Approach

By Huixin Bian and Zhifeng Gao, University of Florida

Producer Perceptions and Willingness to Adopt Adaptive Multi-Paddock Grazing

By McKenna Elizabeth Clifford and Melissa G.S. McKendree, Michigan State University

The Effect of a Transitional Diet Strategy on Stocker Heifer Performance on Wheat Pasture in the Southern Great Plains Region

By Barrett Moore (1), Wade Brorsen (1), Jon Biermacher (2), Myriah Johnson (2), Bryan Nichols (3) and Evan Whitley (4)

1: Oklahoma State University; 2: Noble Research Institute; 3: Nichols Family Farms Co; 4: Whitley Agriculture Services

The Impact of Cloud Seeding on Small Grain Crops: Evidence from The North Dakota Cloud Modification Project

By Scott William Knowles and Mark Skidmore, Michigan State University

Winning Ugly: Opportunities to Improve Intentions to Purchase Ugly Food

By Ran Li, Louisiana State University

WRP Forest Owners' Willingness to Accept Compensation for Wildlife Habitat Enhancement

By Ana Gutierrez (1), Jerrod Penn (1), Shaun Tanger (2), and Michael Blazier (1)

1: Louisiana State University; 2: Mississippi State University

**OS03: Organized Symposium
Agricultural Economists in Industry
February 3, 2020 1:30 pm – 3:00 pm
Olmsted 7**

Moderator: Krishna Paudel, Louisiana State University

AGRICULTURAL ECONOMICS

Participants:

Irfan Tareen, CenterCard

Basanta Dhungana, Agilent Technologies

Aaron Hobbs, Responsible Industry for a Sound Environment

SP09: Selected Papers

Agricultural Policy

February 3, 2020 1:30 pm – 3:00 pm

Butchertown

Session Chair: Bart L. Fisher, Texas A&M University

Evaluating the Efficacy of the New Annual Forage Insurance Program Dual Use Option

By Natalie A. Graff, Bart L. Fischer, Joe L. Outlaw, and David P. Anderson, Texas A&M University

Cost of a Mandatory Base Update for Federal Farm Programs

By Henry R. Nelson, Joe L. Outlaw, Bart L. Fischer, and J. Marc Raulston, Texas A&M University

Analyzing Dairy Margin Coverage Decisions for Southern Representative Dairies

By Brian Herbst, Bart Fischer, David Anderson, Joe Outlaw, and Natalie Graff, Texas A&M University

Impacts of Grocery Sales Taxes on Public Health in the United States

By Lingxiao Wang (1), Yuqing Zheng (1), Diansheng Dong (2), Hayden Stewart (2), and Harry Mason Kaiser (3)

1: University of Kentucky; 2: United States Department of Agriculture; 3: Cornell University

Regional Trade Enhancement by AGOA

By Jamal Musah (1), Osei-Agyeman Yeboah (1), and Saleem Shaik (2)

1: North Carolina Agriculture and Technical State University; 2: North Dakota State University

Risk Management Options for Hemp Producers

By George M. Knapek, Joe L. Outlaw, Bart L. Fischer, J. Marc Raulston, and Megan L. Moore, Texas A&M University

Effect of Crop Insurance on Cover Crop Adoption

By Rajan Dhakal and Lawson Connor, Louisiana State University (LSU)

AGRICULTURAL ECONOMICS

SP10: Selected Papers

International Policy

February 3, 2020 1:30 pm – 3:00 pm

Crescent Hill

Session Chair: Steven Devadoss, Texas Tech University

Asymmetric Exchange Rate Pass-Through in Southeast Asian Rice Trade

By Taylor Wiseman, Jeff Luckstead, and Alvaro Durand Morat, University of Arkansas

Effects of Yuan Devaluation Against US Dollar on World Cotton Markets

By Stephen Devadoss and Ethan Michael Sabala, Texas Tech University

Can Foreign Direct Investment Promote Energy Conservation and Emission Reduction in China?

By Zuoqiang Chen (1), Rongqing Zheng (1), and Krishna P. Paudel (2)

1: Shihezi University; 2: Louisiana State University (LSU)

Effects of Chinese Import Tariffs on US Pork Exports: A Computable General Equilibrium Model Analysis

By Victoria Tanoh (1), Osei Yeboah (1), and Saleem Shaik (2)

1: North Carolina A&T State University; 2: North Dakota State University

U.S. Potentials of Biofuel Trade: A World-wide Country Analysis

By Ayodele Tope Olofinsao (1), Osei-Agyeman Yeboah (1), and Saleem Shaik (2)

1: L.C.Cooper International Trade Center; 2: North Dakota State University

Farmer Exit Decisions and Climate Change in Mexico

By Ariel Soto Caro and Travis McArthur, University of Florida

Institutional Credibility, Perceptions, and Behavior: New Round Land Certification in China

By Hao Zhang (1), Travis D McArthur (2), and Shuyi Feng (3)

1: Nanjing Agricultural University; 2: University of Florida; 3: Nanjing Agricultural University

AGRICULTURAL ECONOMICS

**SP11: Selected Papers
Demand/Price Analysis
February 3, 2020 1:30 pm – 3:00 pm
Barley**

Session Chair: Senarath Dharmasena, Texas A&M University

Consumer Reactions to Risk Messaging about Arsenic in U.S. Rice

By Sunjin Ahn (1), Clinton Neill (2), and Euncheon Park (1)

1: Mississippi State University; 2: Virginia Polytechnic Institute and State University

Habit Formation in Consumption and Its Impact on Consumer Welfare

By Dong Hee Suh, Korea University

Urbanization and Subsistence Consumption: The Case of China

By Vardges Hovhannisyan (1) and Magdana Kondaridze (2)

1: University of Wyoming; 2: Washington State University

Animal Identification and Disease Traceability in the United States: Market Impacts and Implications

By Hannah Elizabeth Shear and Dustin L. Pendell, Kansas State University

Budget Share Allocation for Fish in Bangladesh: Results from Quantile Regression Analysis of the 2016 Household Income and Expenditure Survey Data

By Madan Mohan Dey and Prasanna Surathkal, Texas State University

Determining the factors affecting the growth of the land value in the greater Dallas - Fort Worth - Arlington: focused on residential land value.

By Toluwani Victor Ogunbayode and Senarath Dharmasena, Texas A&M University

Cocoa in Ecuador: Specialty Varieties and Post-Harvest Practices

By Alexis Villacis (1), Jeffrey Alwang (1), and Victor Barrera (2)

1: Virginia Tech; 2: National Institute of Agricultural Research of Ecuador INIAP

AGRICULTURAL ECONOMICS

**SP 12: Selected Papers
Food Marketing
February 3, 2020 1:30 pm – 3:00 pm
Rye**

Session Chair: Zhifeng Gao, University of Florida

Will the real pro-social justice consumers step forward and pay?

By Arbindra Rimal, Missouri State University

Measuring Residents Perceptions of their Local Food Systems in Southern U.S.

By Azita Varziri, Tim Woods, and Jairus Rossi, University of Kentucky

Information treatment and attribute non-attendance in choice experiments

By Yefan Nian and Zhifeng Gao, University of Florida

Market Potential for Specialty Vegetables in the Southeast USA: Scope and Opportunities for Small Scale Producers

By Lila B. Karki (1), Uma Karki (1), and Srinivasa Rao Mentreddy (2)

1: Tuskegee University; 2: Alabama A&M University

Willingness to Purchase Locally-grown Fresh Produce Online among Online Shoppers

By Jean Dominique Gumirakiza and Spencer Warren Langford, Western Kentucky University

Social Identity and Food Choices

By Jennifer Kee (1), Marco Palma (1), and Michelle Segovia (2)

1: Texas A&M University; 2: University of Missouri

BREAK

**February 3, 2020 3:00 pm – 3:30 pm
Second Street Prefunction**

**JMP: Job Market Paper Competition
February 3, 2020 3:30 pm – 5:00 pm
Barley**

Session Chair: Krishna Paudel, Louisiana State University

Impacts of Groundwater Extraction Policy Instruments Under Certain and Uncertain Thresholds

By Dendra Bhatta and Krishna P. Paudel, Louisiana State University

Intraregional Trade Effects of CAFTA-DR in the Textile and Clothing Industry

By Alejandra Breve Ferrari, Louisiana State University

AGRICULTURAL ECONOMICS

Two Simple Strategies for Reducing Aggregation Bias in Demand System Models

By Wenying Li, Chen Zhen, University of Georgia

Weather Variability, Wealth and Labor Mobility

By Florence Lwiza and Andrew Barkley, Kansas State University

OS04: Organized Symposium

Early Assessment of the 2018 Farm Bill

February 3, 2020 3:30 pm – 5:00 pm

Olmsted 7

Organizer: Bart Fischer, Texas A&M University

Moderator: Joe Outlaw, Texas A&M University

Participants:

Bart Fischer, Texas A&M University

David Anderson, Texas A&M University

Nathan Smith, Clemson University

SP 13: Selected Papers

Agricultural Production 3

February 5, 2017 3:30 pm – 5:00 pm

Crescent Hill

Session Chair: Dayton Lambert, Oklahoma State University

Forage management practices used in U.S. grass-fed beef production

By Isaac Sitienei (1), Jeffrey Gillespie (2), and Guillermo Scaglia (3)

1: Austin Peay State University; 2: USDA-ERS; 3: Louisiana State University (LSU)

Economic Risk Analysis of Modern Irrigation Scheduling Methods on Cotton Production in Georgia

By Anukul Bhattarai, Yangxuan Liu, Amanda R. Smith, Vasileios Liakos, and George Vellidis, University of Georgia

The Role of Public Spending in Shaping Agricultural Land and Labor Productivity in Colombia

By Juan Taramuel and Wanki Moon, Southern Illinois University

Long-term Crop Rotation and Bio-Cover Impacts on No-Tillage Soybean Profitability

By Xia Zhou (1), James Larson (1), Virginia Sykes (1), Amanda Ashworth (2), and Fred Allen (1)

1: The University of Tennessee, Knoxville; 2: USDA-ARS

AGRICULTURAL ECONOMICS

Potential Impact of Innovations in Production and Ginning Technologies on Relative Profitability of Pima and Upland Cotton in the U.S. Southwest

By Pratima Bhandari (1), Ram N. Acharya (1), John Idowu (1), and Carlos B. Armijo (2)

1: New Mexico State University; 2: USDA – ARS

New Yield Response Estimators for Spatially Dense Field and Crop Data: Small Sample Properties and an Empirical Example

By Dayton Lambert and Chellie Hogan, Oklahoma State University

Analyzing the determinants of Technical Efficiency in Crop Production in Sub-Saharan Africa: Evidence from Mali

By Ange Thomas Kakpo, Virginia Tech University

SP 14: Selected Papers

Farm Management and Finance

February 3, 2020 3:30 pm – 5:00 pm

Butchertown

Session Chair: Gregory Ibendahl, Kansas State University

Determinants of adoption and adoption intensity of precision agriculture technologies: Evidence from South Dakota

By Deepthi E. Kolady, Md Mahi Uddin, Evert Vander Sluis, and Allen P. Deutz, South Dakota State University

Economic Feasibility of Brazilian Crop-Livestock Integration System

By Yuri Calil Calil and Luis Ribera, Texas A&M University

Factors Influencing Farmers' Willingness to Mortgage Loan on Land Contractual Rights in China

By Yan Liu (1), YunJia Zheng (1), and Krishna P. Paudel (2)

1: SiChuan Agricultural University; 2: Louisiana State University (LSU)

Do commodity prices affect agricultural land values? If so, how much?

By Albert Boatey and Angela Jungbluth, University of Wisconsin-River Falls

Does Owning Greater Than Average Amounts of Equipment Affect Profitability

By Gregory Ibendahl, Kansas State University

AGRICULTURAL ECONOMICS

The Effects of Irrigation Restrictions on Land Values and Rental Rates in Northwest Kansas

By Chelsea J. Arnold and Mykel R. Taylor, Kansas State University

Potential Effect of Introducing Guar as Rotation Crop on Farm Productivity and Sustainability in the Semiarid Regions

By Ram Acharya, New Mexico State University

SP15: Selected Papers

Natural Resources 1

February 3, 2020 3:30 pm – 5:00 pm

Rye

Session Chair: Lixia He Lambert, Oklahoma State University

A Flood of Construction: Studying the Role of Levees in Urban Floodplain Development

By Will Cameron Georgic (1) and H. Allen Klaiber (2)
1: Kalamazoo College; 2: The Ohio State University

The adoption of multiple best management practices by Florida vegetable and agronomic growers

By Moonwon Soh, Tara Wade, and Tatiana Borisova, UF-IFAS

Small-scale fishers' perceptions about the performance of seasonal closures in the commonwealth of Puerto Rico

By Juan Agar (1), Manoj Shivlani (2), and Daniel Solis (3)

1: Southeast Fisheries Science Center, NOAA Fisheries Service; 2: University of Miami; 3: Florida A&M University

Spatial-Temporal Impacts of Biofuel Growth on Crop Choice, Groundwater Depletion, and Farm Profitability in the High Plain Aquifer Kansas

By Amer Al-Sudani, Gabriel Sampson, and Jason Bergtold, Kansas State University

Does participation in federal conservation program increase conservation? A case study of Louisiana

By Santosh Pathak, Hua Wang, and Naveen C. Adusumilli, Louisiana State University (LSU)

Population and Employment Growth Impact on Water Demand in Oklahoma

By Lixia He Lambert (1), Christopher D. Clark (2), and Larry Sanders (1)

1: Oklahoma State University; 2: University of Tennessee

AGRICULTURAL ECONOMICS

Innovating Ecological Compensation System for Water Resources Management Reform

By Qiongxia Qin (2), Reed Michael (1), and Sayed Saghaian (1)

1: University of Kentucky; 2: Zhejiang Sci-Tech University

February 3, 2020 4:00 pm - 5:00 pm

**Quiz Bowl Break/Recruitment Fair
Germantown Prefunction**

February 3, 2020 5:15 pm – 7:00 pm

**SAEA Business Meeting and Awards Program
Commonwealth 3**

February 3, 2020 6:30 – 8:30 pm

**Undergraduate Student Reception
Tavern on Fourth, Upper Level, 427 South 4th
Street**

February 4, 2020 8:00 am – 5:00 pm

**Registration
Second Street Prefunction**

SAEA Lifetime Achievement Awards Breakfast

**February 4, 2020 8:00 am – 10:00 am
Commonwealth 4**

SAEA recognizes significant and enduring contributions in scholarship or public service to Southern agricultural economics. This award recognizes individual distinguished contributions to the profession over a career. The award winners for 2019 will be recognized at this session and each award recipient will make a short presentation on the highlights of their career and their perspectives on agricultural economics as a professional home.
Session Chair: Deacue Fields, University of Florida

Presenter:

Keith Coble, Mississippi State University

ES: Emerging Scholars

Emerging Scholars Presentations

February 4, 2020 10:30 am – 12:00 pm

Nulu

Session Chair: Tim Woods, SAEA President-Elect, University of Kentucky

AGRICULTURAL ECONOMICS

Presentations:

Sensory and Network Effects on Stated Preference for Vegetables Using a Basket-Based Choice Experiment

By Clinton Neill, Virginia Tech University

Certainty Follow-Up Efficacy under Potential and Actual Hypothetical Bias: A Meta-Analysis

By Jerrod Penn, Louisiana State University

Improving Quality of the U.S. Beef Herd: Industry Structure, Information, and Signaling

By Nathanael Thompson, Purdue University

OS05: Organized Symposium Successful Extension Risk Management Outreach Programming February 4, 2020 10:30 am – 12:00 pm Olmsted 7

Organizer: Ron Rainey, University of Arkansas

Moderator: Ron Rainey, University of Arkansas

Participants:

Laurence Crane, National Crop Insurance Services

Kevin Ellis, National Center for Appropriate Technology

Duncan Chembizi, Alabama A&M University

SP16: Selected Papers Natural Resources 2 February 4, 2020 10:30 am – 12:00 pm Butchertown

Session Chair: Seong Yun, Mississippi State University

Heterogeneity in time preferences for an irrigation investment

By Kent Forrest Kovacs and Heather Snell, University of Arkansas

Do ecological-economic tradeoffs change by types of budget distribution options for forest carbon sequestration in the Central and Southern Appalachian region?

By Seong-Hoon Cho, Bijay P. Sharma, and Young Gwan Lee, University of Tennessee, Knoxville

AGRICULTURAL ECONOMICS

Investigating the Impacts of Agronomic Weather Measures on Rice Production in Sri Lanka

By Nirodha Sudershini De Silva (1), Benaissa Chidmi (2), and Wesley Whittaker (1)

1: Langston University; 2: Texas Tech University

Optimal Control of Smart Wild Pigs in the Mississippi Delta

By Katherine Barkley (1), Seong Yun (1), Kalyn Coatney (1), and Charles Sims (2)

1: Mississippi State University; 2: University of Tennessee, Knoxville

Treatment of Legacy Nitrogen as a Compliance Option to Meet Chesapeake Bay TMDL Requirements

By Kurt Stephenson, Zach Easton, Emily Bock, and William Ferris, Virginia Tech University

A Causal Analysis of Water Conservation Practices on Crop Yields in the Mississippi Delta

By Melody Pinamang (1), Seong Yun (1), Benjamin Gramig (2), and Matthew Interis (1)

1: Mississippi State University; 2: University of Illinois at Urbana Champaign

Estimating Willingness to Pay for Climate Smart Agriculture Technology Adoption in Eastern Uganda: Evidence from Household Survey Data

By Tej K. Gautam, Sarah Kogoya, and Krishna P Paudel, University of Arkansas

SP17: Selected Papers International Issues 2 February 4, 2020 10:30 am – 12:00 pm Crescent Hill

Session Chair: Wei Zhang, University of Kentucky

The Determinants of Moroccan Households' Default in Bank Credits

By Sawssan Boufous, Darren Hudson, Carlos Carpio, and Jaime Malaga, Texas Tech University

Assessing Rice Market Efficiencies in the Democratic Republic of the Congo

By Bailey Elizabeth Peterson-Wilhelm, Lawton Lanier Nalley, Willy Mulimbi, and Alavro Durand, University of Arkansas

The Role of Coffee Futures Market in Price Discovery and Interplay Analysis of Coffee Futures and Spot Market Prices

By Wei Zhang and Sayed Saghaian, University of Kentucky

AGRICULTURAL ECONOMICS

Impacts of US, Mexican, and Canadian Trade Agreement on Commodity and Labor Markets

By Xin Zhao (1), Stephen Devadoss (2), and Jeff Luckstead (1)

1: University of Arkansas; 2: Texas Tech University

The Economics of Global Saturated Fat Intake and Implications for Public Health

By Amelia Ahles and Andrew Muhammad, University of Tennessee, Knoxville

The impacts of Chinese retaliatory tariffs on U.S. cotton industry

By Hongyi Yuan (1), Yangxuan Liu (1), Cesar Escalante (1), and Jing Liu (2)

1: University of Georgia; 2: Purdue University

Food selection norm of Chinese teenagers: Conceptualization and scale development

By Bingcheng Yang (1) and Danyi Qi (2)

1: Sun Yat-sen University/Louisiana State University (LSU); 2: Louisiana State University (LSU)

**SP18: Selected Papers
Consumer Preferences and WTP
February 4, 2020 10:30 am – 12:00 pm
Rye**

Session Chair: John Lai, University of Florida

Consumer Willingness to Pay for Locally Produced Hard Cider

By Kimberly Jensen, David Hughes, Karen DeLong, Hannah Wright, Jamey Menard, and Gill MacKenzie, University of Tennessee

Consumer Milk Expenditures and Preferences for Tennessee Milk

By Sreedhar Upendram, Kimberly Jensen, and Karen DeLong, University of Tennessee

Opportunities to Improve Intentions to Purchase Ugly Food: Estimating U.S. Consumers' Attitudes toward Ugly Food

By Ran Li (1), Jerrod Penn (1), Brian E. Roe (2), and Danyi Qi (1)

1: Louisiana State University (LSU); 2: Ohio State University

Perishable Food Date Label Best Practices and Consumer Willingness to Reduce Food Waste

By Katlin N. Ramy, John Michael Riley, F. Bailey Norwood, and Eric A. Devuyst, Oklahoma State University

AGRICULTURAL ECONOMICS

Consumer Preferences and Willingness to Pay for Melon Attributes

By John Lai (1), Ariana Torres (2), Bridget Behe (3), and Petrus Langenhoven (2)

1: University of Florida; 2: Purdue University; 3: Michigan State University

U.S. Demand for Peanut Butter Alternatives: The Case of Almond Butter, Hazelnut Butter, Walnut Butter and Mixed Nut Butter

By Senarath Dharmasena and Oral Capps, Jr., Texas A&M University

Consumer Preferences for Flowering Trees and Shrubs for Home Landscapes

By Pulkit Marwah, Yu Yvette Zhang, and Mengmeng Gu, Texas A&M University

**February 4, 2020 12:00 pm – 1:30 pm
Lunch Break**

**OS06: Organized Symposium
2020 Southern Livestock Economic Outlook
February 4, 2020 1:30 pm – 3:00 pm
Olmsted 7**

Organizer: Samuel D. Zapata, Texas A&M University, Southern Extension Economics Committee

Moderator: David Anderson, Texas A&M University

Participants:

Beef Outlook for 2020

By Justin Benavidez, Texas A&M University

Pork Outlook for 2020

By Andrew Griffith, The University of Tennessee

Poultry Outlook for 2020

By Kenny Burdine, University of Kentucky

Dairy Outlook for 2020

By Kenny Burdine, University of Kentucky

Hay and Forage Outlook for 2020

By Chris Prevatt, University of Florida

Sheep and Goat Outlook for 2020

By James Jones, Oklahoma State University

**SP19: Selected Papers
Consumer Preferences and WTP
February 4, 2020 1:30 pm – 3:00 pm
Butchertown**

AGRICULTURAL ECONOMICS

Session Chair: Ben Campbell, University of Georgia

Are Consumers Willing to Pay for Conservation Agriculture in Low-Income Countries? The Case of White Maize in the Democratic Republic of the Congo

By Willy Mulimbi, Lawton Lanier Nalley, Rodolfo M. Nayga Jr., and Arya Gaduh, University of Arkansas

Consumers' Preferences for Sustainable Rice Practices in Nigeria

By Glory Esohe Okpiaifo (1), Alvaro Durand-Morat (2), Grant Howard West (2), Lawton Lanier Nalley (2), Rodolfo Nayga Jr (2), and Eric Wailes (2)

1: University of Florida; 2: University of Arkansas

An Enterprise Analysis of Carinata Oilseed Viability as Sustainable Aviation Fuel

By Kevin Alan Robertson, Burton C. English, Carlos Jose Omar Trejo-Pech, Robert J. Menard, James A. Larson, and Chad M. Hellwinckel, University of Tennessee

Consumer Views on Use and Legality of Hemp Based Products

By Justin Campbell, Julie Campbell, Adam Rabinowitz, and Ben Campbell, University of Georgia

Welfare and Budget Allocation Impacts of the Elimination of Fossil Fuel Subsidies: The Case of Ecuador

By Oscar Sebastian Sarasty and Carlos Enrique Carpio, Texas Tech University

Alternative production practices and the role of consumer choice: willingness-to-pay analyses

By Amanda Wecker, Nichole L. Busdieker-Jesse, and Arbindra Rimal, Missouri State University

The Temporariness of Migrations and Household Consumption in China

By Le Wen (1) and Krishna P Paudel (2)
1: South China Agricultural University; 2: Louisiana State University (LSU)

SP20: Selected Papers Production Economics

**February 4, 2020 1:30 pm – 3:00 pm
Crescent Hill**

Session Chair: Stephen Lira, Noble Research Institute

Economic Potential of Multi-crop, Multi-Year Healthy Soil Production Systems for Water-Limiting Cropland Acres in Oklahoma

By Stephen Lira, Jon Biermacher, and Jim Johnson, Noble Research Institute

AGRICULTURAL ECONOMICS

Does Crop Yield Risk Differ across Soil Types? Evidence from Mississippi Variety Trials

By Amadeo Fosu Panyi, Mississippi State University

Does Crop Yield Risk Differ across Soil Types? Evidence from Mississippi Variety Trials

By Amadeo Fosu Panyi, Mississippi State University

Mid-Season Production Throttles: An Analysis of the Intra-Seasonal Field Crop Yield-Price Relationship in the US

By Nicholas Jon Pates and Tyler Berkley Mark, University of Kentucky

The Impact of Five-Year Plan on the Development of Agricultural Quality and Regional Difference Analysis

By Yali Han (1), Junyi Wan (1), and Krishna P. Paudel (2)

1: South China Agricultural University; 2: Louisiana State University (LSU)

On the Road Again: Potential Regional Price Impacts of ELD Regulation

By Anastasia W. Thayer (1), Justin R. Benavidez (2), Charley C. Martinez (3), and David P. Anderson (2)

1: Utah State University; 2: Texas A&M University; 3: University of Tennessee

Did Mechanization Improve Small Farmers' Efficiency?

By Min Shi (1), Krishna P. Paudel (2), and Fengbo Chen (1)

1: South China Agricultural University; 2: Louisiana State University (LSU)

An Evaluation of Irrigation Efficiency in Rice Production in Eastern Arkansas: A Meta Analysis

By Tej K. Gautam, K. Bradley Watkins, Chris G. Henry, Jarrod T. Hardke, Ralph Mazzanti, and Ron Baker, University of Arkansas

SP21: Selected Papers

**Regional Economics and Rural Development 2
February 4, 2020 1:30 pm – 3:00 pm
Rye**

Session Chair: Lijia Mo, University of Houston

Banks' Sustainable Growth Challenge under Economic Recessionary Pressure

By Maoyong Zheng and Cesar L. Escalante, University of Georgia

Analyzing and Identifying Peer-to-Peer Housing Loan Default Risk Factors by a Logit Modelling

By Lijia Mo, University of Houston

AGRICULTURAL ECONOMICS

Effect of Wage Growth on Rural/Urban Labor Demand

By Jacob Manlove (1) and Clint Neil (2)
1: Tarleton State University; 2: Virginia Tech

Factors Impacting Satisfaction with a Cooperatives Mobile and Web-based Information Platforms

By Niranjana Jayaramu and Dr. Conrad Lyford, Texas Tech University

A Note on the Locational Determinants of the Agricultural Supply Chain

By Anders Taliesin Van Sandt and Craig Wesley Carpenter, Texas A&M University

Do Regional Differences Matter in Broadband Policy?

By Hyun Ji Lee, Texas Tech University

Agricultural Cooperative Mergers and Efficiency Gains: An Ex-Ante Analysis

By Eric Makafui Ofori, Elizabeth Yeager, and Brian Briggeman, Kansas State University

BREAK

**February 4, 2020 3:00 pm – 3:30 pm
Second Street Prefunction**

**OS07: Organized Symposium
2020 Southern Crops Economic Outlook
February 4, 2020 3:30 pm – 5:00 pm
Olmsted 7**

Organizer: Todd Davis, University of Kentucky, Southern Extension Economics Committee

Moderator: Nathan Smith, Clemson University

Corn Outlook for 2020

By Todd Davis, University of Kentucky
Wheat and Sorghum Outlook for 2020
By Samuel Zapata, Texas A&M University
Soybean Outlook for 2020
By Aaron Smith University of Tennessee

Cotton Outlook for 2020

By Yangxuan Liu, University of Georgia

Peanut Outlook for 2020

By Adam Rabinowitz, University of Georgia

**SP22: Selected Papers
Regional Economics and Rural Development
February 4, 2020 3:30 pm – 5:00 pm
Butchertown**

AGRICULTURAL ECONOMICS

Session Chair: Tyler Mark, University of Kentucky

An Empirical Analysis of Heirs' Property and Persistent Poverty

By Steven Cornell Turner (1), Cassandra Johnson Gaither (2), and Ardian Harri (1)
1: Mississippi State University; 2: USDA, Forest Service

Impact of Oil and Gas Easements on Erath County Property Values

By Sierra Rash, Jacob Manlove, Chandra Andrew, and Brant Poe, Tarleton State University

A Different Analysis of Rural Development's (RD) Business and Industry (B&I) Loan Guarantee Program: The Impact on Sales Tax Revenue in Oklahoma Communities

By Ty Rope Smith, Brian E. Whitacre, Notie Lansford, and Dave Shideler, Oklahoma State University

Recovering Missing Yield Data: Ramifications for USDA's ARC-CO Program

By Zach Ishee, Eunchun Park, Ardian Harri, and Keith H. Coble, Mississippi State University

Untangling the Spatio-Temporal Correlation of Wind Turbine Location

By Tyler Mark (1), Nicholas Pates (1), and Mathias Ritter (2)
1: University of Kentucky; 2: Humboldt University

Understanding the regional economic impact of adopting agricultural Best Management Practices (BMPs) in the Upper Floridan Aquifer (UFA) region

By Unmesh Koirala (1), Damian Adams (1), Fei He (1), Guy Hancock (2), Amanda Smith (2), and Kevin Athearn (1)
1: University of Florida; 2: University of Georgia

Market Integration and Price Discovery of Regional Land Markets in Texas

By Tian Su, Senarath Dharmasena, David J. Leatham, and Charles E Gilliland, Texas A&M University

**SP23: Selected Papers
Cost/Benefit Analysis and Policy
February 4, 2020 3:30 pm – 5:00 pm
Crescent Hill**

Session Chair: Huixin Bian, University of Florida

AGRICULTURAL ECONOMICS

Economic Benefits of the Aerial Application Industry in the United States: Aerial Herbicide Application Ban Scenario

By Senarath Dharmasena (1) and Daniel Martin (2)
1: Texas A&M University; 2: United States
Department of Agriculture

Is the Sectoral Energy Demand driven by Source of Energy?

By Saleem Shaik (1), Kwame Addey (1), and Osei Yeboah (2)
1: North Dakota State University; 2: North Carolina
A&T State University

Impacts of Tariffs and Trade Agreements on Japanese Wine Imports by Source

By Emily Katherine Greear and Andrew Muhammad,
University of Tennessee, Knoxville

Economics Benefit of Pest Risk Prediction Model: An Agent-Based Model Approach

By Huixin Bian and Zhifeng Gao, University of Florida

A CASTLE-IV Method of Aggregation Bias

By Qiongxia Qin, University of Kentucky

Ginseng based forest farming as sustainable income diversification opportunity for landowners

By Prabodh Illukpitiya, Avis Ortiz, and Tegegne Fisseha, Tennessee State University

H-2A program in the Delta States: Program Use, Programmatic Hiccups and Concerns for Policy Makers

By Maria Bampasidou and Whitney McKinzie,
Louisiana State University (LSU)

SP24: Selected Papers

Potpourri

February 4, 2020 3:30 pm – 5:00 pm
Rye

Session Chair: Natalia Isabel Valdez Gonzalez,
Texas A&M University

Misplaced Values: Exploring Divergent Communication Soft-Skill Value Perceptions Between Agriculture Business Leaders and Agriculture Business Undergraduates

By Andrew Brown and Joey Mehlhorn, University of
Tennessee at Martin

Does homeownership improve education outcome in Georgia?

By Jyotsna Ghimire and Ramesh Ghimire, University
of Georgia

AGRICULTURAL ECONOMICS

How correlations among biodiversity, ecosystem services, and socioeconomic benefits as conservation objectives affect spatial targeting and synergic or tradeoff relationships

By Young Gwan Lee (1), Paul R. Armsworth (1),
Gengping Zhu (1), Bijay P. Sharma (1), Christopher
D. Clark (1), Burton C. English (1), Daniel J. Hayes
(2), and Seong-Hoon Cho (1)
1: University of Tennessee, Knoxville; 2: University of
Maine

Assessment of Water Usage and Producer Attitudes of Groundwater in the Southern region of the Ogallala Aquifer

By Cutter Smith (1), Mallory Vestal (1), Bridget
Guerrero (1), Kunlapath Sukcharoen (1), and Bill
Golden (2)
1: West Texas A&M University; 2: Kansas State
University

Posters

February 4, 2020 3:30 pm – 5:00 pm
Olmsted 4

Posters will be on display Monday and Tuesday.
Presenters will be available during this time for
questions.

An Examination of Cointegration Relations between Natural Gas Futures and Spot Price

By Penghui Gao, University of Georgia

Providing Service Learning Opportunities to Stimulate Global Awareness in Agribusiness Students

By Joey Mehlhorn, Sandy Mehlhorn and Rachna
Tewari, University of Tennessee at Martin

Teaching Forward Contracts in Undergraduate Courses in Agribusiness Programs

By Yuliya Bolotova, Clemson University

Profitability of Beef Cattle Best Management Practices in South Texas: Conversion from Bred Cows to Heifers for Replacements

By Alan Mac Young, Joe Paschal, Steven Klose, and
Gregg Kaase, Texas A&M AgriLife Extension

Geographical Diversification in Agriculture at the U.S. Regional Level

By Kunlapath Sukcharoen, West Texas A&M
University

AGRICULTURAL ECONOMICS

Estimating Costs of Reducing Environmental Emissions from a Dairy Farm: Multi-Objective Epsilon-Constraint Optimization versus Single Objective Constrained Optimization

By Nasim Ebadi, Darrell Bosch, and Robin White, Virginia Tech

The Economics of On-Farm Rice Drying in Arkansas

By Clayton Jacob Parker, Lawton Lanier Nalley, Alvaro Durand-Morat, and Micheal Popp, University of Arkansas

Willingness-to-Pay for Halal and Branded Poultry in Northern Mozambique

By Alison Jewel Creasey, Lawton Lanier Nalley, Grant West, and Amy Farmer, University of Arkansas

The Effect of a Transitional Diet Strategy on Stocker Heifer Performance on Wheat Pasture in the Southern Great Plains Region

By Barrett Moore (1), Wade Brorsen (1), Jon Biermacher (2), Myriah Johnson (2), Bryan Nichols (3), and Evan Whitley (4)

1: Oklahoma State University; 2: Noble Research Institute, LLC.; 3: Nichols Family Farms Co.; 4: Whitley Agriculture Services

Feasibility and Impact of Adopting a Proposed Solution to Citrus Greening

By Audrey Rizk and Ariel Singerman, University of Florida

Financing Herd Building for Beginning Ranchers

By Abby M. ShalekBriski, and Eric A. DeVuyst and Cheryl S. DeVuyst, Oklahoma State University

An Overview of the New Agricultural Disaster Aid Provisions

By Kate Wright, Texas A&M University

Price-Induced Feed Substitution: Implications for Feed and Livestock Industries

By Dong Hee Suh, Korea University

Trust Issues in Agricultural Cooperative

By Kishor Luitel (1) and Sanja Zivkovic (2)

1: Middle Tennessee State University; 2: Texas Tech University

The Impacts of Cognitive Ability in Preference Reversal: Evidence from Consumer Evaluation of Sustainable Food Products

By Xiaohan Wei and Xuqi Chen, University of Tennessee

AGRICULTURAL ECONOMICS

Willingness to Pay for Climate Change Mitigation: College Students' Perceptions in Tennessee and Kentucky

By Abigayle Bartholomew Sartain (1), Rachna Tewari (1), Mark Simpson (1), Joseph Mehlhorn (1), Naveen Musunuru (2), and Brian Parr (2)

1: The University of Tennessee at Martin; 2: Murray State University

Do Environmental Attitudes Track Business Cycles? Evidence from the Great Recession

By Jackson Newbury and Susana Ferreira, University of Georgia

Investigating the Adoption of NRCS Conservation Practices in Arkansas from 1980-2018

By Samuel E. King (1), Aaron M. Shew (1), Hanna L. Ford (2), Jackson D. Cothren (2), and Steven Green (1)

1: Arkansas State University; 2: University of Arkansas

Long Grain Rice Price, Oil Price, and International Demand Drive Medium Grain Rice Price in the US

By GwanSeon Kim (1), Jun Ho Seok (2), and Aaron Shew (1)

1: Arkansas State University; 2: Korea Rural Economic Institute

The Mediating Effect of Rural Labor Transfer due to Agricultural Mechanization and Its Impact on Farm Household Income

By Xiaoli Zhang (1), Lin Zhu (1), and Krishna P. Paudel (2)

1: Shihezi University; 2: Louisiana State University (LSU)

Determining Community's Financial Capability to Pay for Water Infrastructure Upgrades in Tennessee

By Hari P Regmi and Sreedhar Upendram, University of Tennessee, Knoxville

Local Food Purchasing Frequency by Locavores across Market Channels Comparison between National and Kentucky Food Consumers

By Mahla Zare Mehrjerdi and Tim Woods, University of Kentucky

An Empirical Analysis of Demand for Honey and Other Sweeteners in the United States

By Vardges Hovhannisyian, Christopher Bastian, Chian Jones Ritten, and Meri Hambaryan, University of Wyoming

AGRICULTURAL ECONOMICS

The Impact of Agribusiness in the High Plains Trade Area

By DeDe Jones (1), Justin Benavidez (1), Rebekka Dudensing (2), and Bridget Guerrero (3)
1: Texas A&M AgriLife Extension; 2: Texas A&M University; 3: West Texas A&M University

Shopping for Food at Traditional and Modern Retail Outlets: Evidence from Uganda

By Yawotse Dgidula-Enyo Nouve and Wojciech J. Florkowski, University Georgia

Interaction of Willingness to Pay for Gene Edited Products and Physical Activity

By Kaitlyn Melton (1), J. Ross Pruitt (1), and Marco A Palma (2)
1: University of Tennessee at Martin; 2: Texas A&M University

Sustainable Prices to Support Food Equity at Mobile Markets

By Rebekka Dudensing (1), Blane Council (2), Andrea Abel (3), Heather Helman (3), and Carolina Mueller (4)
1: Texas A&M AgriLife Extension Service; 2: Texas A&M University; 3: FarmShare Austin; 4: Central Texas Young Farmers Coalition

Factors Alleviating Financial Risk in the Case of Small-Scale Producers: An Extension Approach

By Lila B. Karki, Uma Karki, and Raymon Shange, Tuskegee University

Why Don't Low Income Households Purchase Fruits and Vegetables? Findings from African American Communities in Nashville, Tennessee

By Aditya R Khanal, Sudip Adhikari, and Fisseha Tegegne, Tennessee State University

Involvement in Decision Making: Women, Young and New & Beginning Producers

By Whitney Richelle McKinzie and Maria Bampasidou, Louisiana State University (LSU)

A Benefit-Cost Analysis of Management Strategies for Giant Salvinia in Northwest Louisiana

By Colt Hardee, Jerrod Penn, and Rodrigo Diaz, Louisiana State University (LSU)

Comparative Economic Analysis of Alfalfa Hay vs Pellet Production

By Prabodh Illukpitiya, Desiree Robertson, and Fisseha Tegegne, Tennessee State University

AGRICULTURAL ECONOMICS

Economic Implications of Combining Poultry Litter with Wood Chips for Bio-based Energy Production in the United States

By Krishna P Paudel (1), Rajan Parajuli (2), Doleswar Bhandari (3), Chandra Theegala (1), and Huizhen Niu (1)
1: Louisiana State University (LSU); 2: North Carolina State University; 3: New Mexico State Univ.

Economic Impact of a Noval Pull-Type Combine has on Production of Small Grains for Small Farms

By Sierra Howry, Matthew Digman, Nick Hovel, Anaiah Legare, and David Foerster, University of Wisconsin-River Falls

Economic Feasibility of Rain-Water Harvesting: A Case Study at Morehead State University

By Caitlyn J. Clark and Vijay Subramaniam, Morehead State University

Hemp Production In Eastern Kentucky: A Case Study at Morehead State University

By Brock Dean, Travis C. White, Brent Rogers, and Vijay Subramaniam, Morehead State University

Analyzing the Determinants of Technical Efficiency in Crop Production in Sub-Saharan Africa: Evidence from Mali

By Ange Thomas Kakpo, Virginia Tech University

Integrated Modeling of Potential Water Conservation Strategies in the Central Ogallala Region

By Sydney Reynolds (1), Bridget Guerrero (1), Bill Golden (2), and Mani Rouhi Rad (3)
1: West Texas A&M University; 2: Kansas State University; 3: Colorado State University

Analyzing High Value Vegetable Seed Production in the Texas Panhandle

By MariKate Crouch (1), Bridget Guerrero (1), Charles Rush (2), and James Gray (2)
1: West Texas A&M University; 2: Texas A&M AgriLife Research

Imported Rice and Local Rice Substitutability in Ghana

By Eric Makafui Ofori, Tian Xia, and Francis Tsiboe, Kansas State University

Farmer Awareness of Sustainable Forest Initiatives

By Brianna Dominique Cobb, Louisiana State University (LSU)

February 4, 2020 6:00 – 8:00 pm

SAEA Reception

Churchill Downs (buses will be provided)

AGRICULTURAL EDUCATION

SOUTHERN REGION CONFERENCE OF THE AMERICAN ASSOCIATION FOR AGRICULTURAL EDUCATION

2020 PROGRAM

HELD IN CONJUNCTION WITH THE MEETING OF THE SOUTHERN ASSOCIATION OF AGRICULTURAL SCIENTISTS (SAAS)

February 1 – February 4, 2020 – Louisville,
Kentucky

Southern Association of Agricultural Scientists (SAAS) Agricultural Education Division Officers

President and Conference Co-Chairs: Barry Croom,
University of Georgia and Don Edgar, University of
Georgia

Past President: Barbara Kirby, NC State University

American Association for Agricultural Education (AAAE) Southern Region Officers

President: Travis Park, NC State University
Vice-President/President Elect: Tracy Rutherford,
Virginia Tech

Secretary: Wendy Warner, NC State University

Saturday, February 1st

3:00 – 6:00 pm Registration, *Second Street
Prefunction*

Sunday, February 2nd

8:00 – 9:00 am Graduate Student Breakfast,
Commonwealth 5 (pre-registered graduate students)

8:00 – 10:00 am Registration, *Second Street
Prefunction*

8:45 – 9:15 am Vespers, *Commonwealth 2*

9:30 – 10:00 am Agricultural Education Opening
Session, *Commonwealth 2*

10:15 – 11:45 am Concurrent Research Session I –
15 minute presentations, 15 minutes of discussion
Session A, *Olmsted 2*
Session B, *Nulu*
Session C, *Olmsted 1*

AGRICULTURAL EDUCATION

12:00 – 1:30 pm Luncheon and introduction of
graduate students and new faculty, *Commonwealth 5*

1:30 – 2:15 pm Committee Meetings
Membership Services, *Oak*
Program Improvement, *Rye*

2:15 – 3:00 pm Professional Development, *Charred
Research, Barley*

2:45 – 4:00 pm Innovative Poster Session,
Olmsted 4

4:00 pm SAAS General Business Meeting,
Commonwealth 3

5:00 pm SAAS Reception/ Super Bowl Party
Griff's 133 W Liberty St. (across the street)

Monday, February 3rd

8:00 – 10:00 am Registration, *Second Street
Prefunction*

8:00 – 9:00 am Continental Breakfast, *Olmsted
Prefunction*

9:00 – 10:30 am Concurrent Research Session II
15 minute presentations, 15 minutes of discussion
Session D, *Nulu*
Session E, *Olmsted 2*
Session F, *Olmsted 1*

10:45 – 11:45 am SR-AAAE Business Meeting
Session I, *Olmsted 2*
Travis Park, SR-AAAE President

12:00 – 1:30 pm Luncheon and Distinguished
Lecture, *Commonwealth 6/7*

1:30 – 2:45 pm Research Poster Session, *Olmsted 4*

3:00 – 4:30 pm Professional Development Sessions,
*Each workshop will be 25 minutes in length and will
be run three times. Participants will choose three
workshops to attend and will rotate through.*
Session A, *Commonwealth 8*
Session B, *Olmsted 1*
Session C, *Olmsted 2*
Session D, *Olmsted 5*

5:30 – 7:30 pm Host State Social, *The Kentucky
Derby Museum at Churchill Downs*
704 Central Ave. Louisville, KY 40208
Transportation provided by bus

AGRICULTURAL EDUCATION

Tuesday, February 4th

8:30 – 9:30 am SR-AAAE Business Meeting Session II, *Olmsted 2*
Travis Park, SR-AAAE President

9:45 – 11:15 am Concurrent Research Session III –
15 minute presentations, 15 minutes of discussion
Session G, *Olmsted 1*
Session H, *Old Louisville*
Session I, *Olmsted 2*

11:30 – 1:30 pm Awards Luncheon,
Commonwealth 5

SR-AAAE Conference Adjourns After Lunch

AGRONOMY

The Southern Regional Branch of American
Society of Agronomy

HELD IN CONJUNCTION WITH THE MEETING OF
THE
SOUTHERN ASSOCIATION OF AGRICULTURAL
SCIENTISTS (SAAS)

SATURDAY, FEBRUARY 1, 2020

REGISTRATION: 10:00 AM - 4:00 PM

LOCATION: SECOND STREET PREFUNCTION

POSTER SESSION 1:00 PM - 4:00 PM

AUTHORS PRESENT FROM 1:00 PM- 3:00 PM

LOCATION: OLMSTEAD 4

UNDERGRADUATE STUDENT POSTER
COMPETITION - CROPS AND SOILS

Influence of Fertilizer Additives on Crabgrass
(*Digitaria sanguinalis*) Biomass Production.
Cheyenne Simmons, *Mississippi State
University*; **Rocky W. Lemus**, *Mississippi State
University*; **Brett Rushing**, *Mississippi State University*

Effect of KI on Leaf Mineral Uptake in Soybean
Plants.
Haley Beasley, *Mississippi Valley State
University*; **Manju Pande**, *Mississippi Valley State
University*; **Mardarius Mann**, *Mississippi Valley State
University*; **Mudlagiri Goli**, *Mississippi Valley State
University*

Aggregation and Soil Organic Carbon Pools
Following Tillage-Cover Crop Practices.
Carrie Ann Followell, *Murray State University*; **Iin P.
Handayani**, *Murray State University*; **David L
Ferguson**, *Murray State University*

Physiological Effect of Melatonin on Plants.
Kayla Reynolds, *Mississippi Valley State
University*; **Manju Pande**, *Mississippi Valley State
University*

Paraquat Use As a Soybean Harvest Aid in the
Southeastern U.S.: Developing Relationships
between Timing, Yield, Seed Moisture, and
Vegetation Index.
Andrew Russell, *Abraham Baldwin Agricultural
College*; **Emma Tyre**, *Abraham Baldwin Agricultural
College*; **Alex McLemore**, *Abraham Baldwin
Agricultural College*; **Michael J Maw**, *Abraham
Baldwin Agricultural College*

AGRONOMY

GRADUATE STUDENT POSTER COMPETITION – M.S. STUDENTS

Physiological Characteristics Determining Drought Tolerant in Peanuts.

Qiong Zhang, Auburn University; Xiaoxing Zhen, Auburn University; Charles Yiwu Chen, Auburn University; William Batchelor, Auburn University; Alvaro Sanz-Saez, Auburn University

Impact of Winter Cover Crop Grazing on Soil Health in Southeastern Cropping Systems.

Hayley Crowell, Auburn University; Audrey V. Gamble, Auburn University; Yucheng Feng, Auburn University; Kip Balkcom, USDA/ARS

Influence of Conservation Tillage on Water-Use Efficiency and Yield of Peanut.

Sujata Bogati, University of Georgia; Monique Leclerc, University of Georgia; Ronald Scott Tubbs, University of Georgia; Gengsheng Zhang, University of Georgia; Walter Scott Monfort, University of Georgia-Tifton; Navjot Singh, University of Georgia

Evaluation of Soybean (Glycine max) Yield Potential Following Sub-Optimal Plant Populations.

Lou Adams, Mississippi State University; J. Trenton Irby, Mississippi State University; Alanna B. Scholtes, Mississippi State University

Evaluation of Insect Dynamics in Southeastern Cover Cropping Systems.

Joseph Akins, Auburn University

Physiological Variance of Soybean Under High Night Temperature Stress.

Tianchu Shu, Auburn University; Alvaro Sanz-Saez, Auburn University

Studying the Relationship between Water Use Efficiency and Yield in Elite Soybean Lines in Alabama.

Mary Durstock, Auburn University; Maria Luisa Buchailot, University of Barcelona; Alvaro Sanz Saez de Jauregui, Auburn University

GRADUATE STUDENT POSTER COMPETITION – PH.D. STUDENTS

Optimum Nitrogen Fertilizer Rate and Timing Management of Corn When Following a Rye Cover Crop.

Daniel Quinn, University of Kentucky; Hanna Poffenbarger, University of Kentucky; Chad D Lee, University of Kentucky

AGRONOMY

The Dollars and Sense of Nitrogen Application on Summer Annual Forage Mixtures.

Kelly Mercier, University of Kentucky; Christopher D. Teutsch, University of Kentucky; Samuel Ray Smith, University of Kentucky; Kenny Burdine, University of Kentucky; Edwin L. Ritchey, University of Kentucky; Eric Vanzant, University of Kentucky

Root-Specific Chemical Profiling of Winter Wheat Cultivars in No-till Systems.

Rebecca K. McGrail, University of Kentucky; David H. McNear Jr., University of Kentucky; David Van Sanford, University of Kentucky

Carinata Yield and Physiological Response to Nitrogen Levels.

Mahesh Bashyal, University of Florida; Michael J. Mulvaney, University of Florida West Florida Research & Education Center; Dewey Lee, University of Georgia; Ramon G Leon, North Carolina State University; Gabriel Maltais-Landry, University of Florida; Chris Wilson, University of Florida; John Erickson, University of Florida

The Effect of Previous Summer Crops on the Seed and Oil Yield of Brassica Carinata.

Joseph Enye Iboyi, University of Florida West Florida Research & Education Center; Michael J. Mulvaney, University of Florida West Florida Research & Education Center; Ramon G Leon, North Carolina State University; Kipling S. Balkcom, USDA-ARS; Ian M Small, University of Florida North Florida Research & Extension Center; Pratap Devkota, West Florida Research and Education Center

Assessment of Hybrids and Plant Populations in a Narrow-Row Corn Production System.

John J. Williams, Mississippi State University; W. Brien Henry, Mississippi State University; Normie W. Buehring, Mississippi State University

PROFESSIONAL POSTER – CROPS

Economic Feasibility of Grazing Summer Cover Crops and Intercropping in No-till Winter Wheat Production in the Texas Rolling Plains.

Yubing Fan, Texas A&M AgriLife Research; Partson Mubvumba, Texas A&M AgriLife Research; Paul B. DeLaune, Texas A&M AgriLife Research; Seong C. Park, Tennessee Tech University

Farmers' Investment Decisions on Winter Cover Crops in Dryland Cotton Production.

Yubing Fan, Texas A&M AgriLife Research; Paul B. DeLaune, Texas A&M AgriLife Research; Partson Mubvumba, Texas A&M AgriLife Research; Seong C. Park, Tennessee Tech University

AGRONOMY

Cover Cropping in Organic Farming Systems in Texas.

Jonathan Moreno, Texas A&M University Agronomy Society; **Ronnie W. Schnell**, Texas Agrilife Research; **Nithya Rajan**, Texas A&M University

Comparison of Desktop and Handheld Near-Infrared Spectroscopy Devices to Determine Forage Nutritive Value.

Miguel S. Castillo, North Carolina State University; **Juan J. Acosta**, North Carolina State University

A Geospatial Decision-Support System for Mississippi Corn Producers.

Patrick J. English, Mississippi State University; **Sherri L. DeFauw**, Ascend Geospatial LLC

Enhanced Efficiency Nitrogen Formulation Effect on Tall Fescue - Red Clover Mixed Species Pasture Productivity.

Kathryn M. Payne, Virginia Tech; **Samuel Ray Smith**, University of Kentucky; **Ben Goff**, West Virginia University Extension Service

Seeding RATE Implications for Single-ROW and Twin-ROW Soybean Production in the Mississippi DELTA.

Richard E. Turner, Mississippi State University; **M. Wayne Ebelhar**, Mississippi State University
Influence of Planting Date on Summer Annuals Grass Biomass and Nutritive Value.
Rocky W. Lemus, Mississippi State University; **O'Neal Nicolas**, Mississippi State University; **J Daniel Rivera**, Mississippi State University; **Brett Rushing**, Mississippi State University; **Noah Frank**, Mississippi State University

Leaf Photosynthetic Activity and Pod Maturity Profile of Peanuts Treated with Different Fungicides.

Cristiane Pilon, University of Georgia-Tifton; **Leticia A. Moreno**, University of Georgia; **Gurpreet Virk**, University of Georgia; **Timothy Brenneman**, University of Georgia; **Albert K. Culbreath**, University of Georgia; **John Snider**, University of Georgia-Tifton

Cellulose Nanocrystals from Cellulosic Biomass Waste: Unique Green Material for Product Development across Industries with Income Generating Potential.

Hari Pratap Singh, Fort Valley State University; **Venkata Nagendra Degala**, Fort Valley State University; **Quaneisha L. Woodford**, Fort Valley State University; **Zandria Chambers**, Fort Valley State University

AGRONOMY

PROFESSIONAL POSTER – SOILS

Reducing Ammonia Emissions from Poultry Litter with a New Litter Amendment.

Philip A. Moore Jr., USDA-ARS; **Kelsey Anderson**, University of Arkansas; **Jerry Martin**, USDA/ARS; **Amanda J. Ashworth**, USDA-ARS

What Is the Nutrient Composition of FGD Gypsum Litter after Five Flocks.

Dexter B. Watts, USDA-ARS; **H. Allen Torbert**, USDA-ARS

SUNDAY, FEBRUARY 2, 2019

Registration: 7:00 AM - 5:00 PM

LOCATION: Second Street Prefunction

GRADUATE STUDENT ORAL COMPETITION – PH.D. STUDENTS

Location: Olmsted 3

7.55 AM	Opening Remarks
8.00 AM	<u>Temperature Effects on Aqueous Selenium Removal By Cattail and Duckweed.</u> Michael P. Natrass , Mississippi State University
8.15 AM	<u>Nitrogen Contribution from Peanut Residues to Brassica Carinata.</u> Mahesh Bashyal , University of Florida
8.30 AM	<u>Carinata Yield Is Optimized at 6 Kg Seed per Hectare Rate Regardless of Tillage Regime Used.</u> Joseph Enye Iboyi , University of Florida West Florida Research & Education Center; Michael J. Mulvaney , University of Florida West Florida Research & Education Center; Kipling S. Balkcom , USDA-ARS; Ramdeo Seepaul , North Florida Research & Education Center; Ramon G Leon , North Carolina State University; Pratap Devkota , West Florida Research and Education Center; Ian M Small , University of Florida North Florida Research & Extension Center; David L. Wright , University of Florida
	48

AGRONOMY

8.45 AM	<p><u>Optimum Nitrogen Fertilizer Rate and Timing Management of Corn Following a Rye Cover Crop.</u> Daniel Quinn, University of Kentucky; Hanna Poffenbarger, University of Kentucky; Chad D Lee, University of Kentucky</p>
9.00 AM	<p><u>Effect of Winter Cover Crop on Canopy Coverage and Subsequent Effect on a Peanut Cotton Rotation.</u> Ana Julia Azevedo, University of Georgia-Tifton; R. Scott Tubbs, University of Georgia-Tifton; William F. Anderson, USDA-ARS; Alisa Coffin, USDA-ARS Southeast Watershed</p>
9.15 AM	<p><u>Effect of Prohexadione Calcium, a Plant Growth Regulator, on Peanut Growth and Yield in Arkansas, Georgia, Mississippi, South Carolina and North Carolina.</u> Sara E. Pelham, University of Georgia-Tifton; Walter Scott Monfort, University of Georgia-Tifton; R. Scott Tubbs, University of Georgia-Tifton; David L. Jordan, North Carolina State University; Travis Faske, University of Arkansas; Dan Anco, Clemson University; Jason M. Sarver, Indigo Ag; Connor Ferguson, Mississippi State University</p>
9.30 AM	<p><u>Are Cover Crops Worth It? Assessing Soil Benefits and Production Costs in a Corn and Soybean Rotation in Northwestern Mississippi.</u> Alayna Jacobs, The University of Kentucky</p>
9.45 AM	<p><u>Quantifying Inhibitory Impacts of Soil Nitrogen on Biological Nitrogen Fixation Potential in Guar.</u> Philip Osei Hinson, Texas A&M University; Curtis Adams, Texas A&M AgriLife Research; Rajan Shrestha, Texas A&M University; Jennifer MacMillan, Texas A&M University</p>
10.00-10.15 AM	Break
10.15 AM	<p><u>Environmental Implications of Conservation Management in Mid-Southern, Irrigated Corn.</u> Gene Spencer, Mississippi State University; Jason Krutz, Mississippi State University; Drew M. Gholson, Mississippi State Delta Research Center; Martin A. Locke, USDA-ARS</p>

AGRONOMY

10.30 AM	<p><u>Growth and Nodulation Response in Guar at Different Soil Moisture Levels and Post-Deficit Recovery Potential upon Moisture Restoration.</u> Rajan Shrestha, Texas A&M University; Curtis Adams, Texas A&M AgriLife Research; Philip Osei Hinson, Texas A&M University; Jennifer MacMillan, Texas A&M University</p>
10.45 AM	<p><u>Integrated Use of Organic and Inorganic N Fertilizers to Improve Crop N Use Efficiency and to Reduce the N Leaching Losses.</u> Bhupinder Jatana, Clemson University ; Christopher Kitchens, Clemson University; Christopher L. Ray, Clemson University; Nishanth Tharayil, Clemson University</p>
11.00 AM	<p><u>Using UAV and Multispectral Images to Assess Late-Season Physiological Responses of Peanuts to Different Planting Dates.</u> Chiara Rossi, University of Georgia-Tifton; Adao F. dos Santos, University of Georgia; Lorena Lacerda, University of Georgia; George Vellidis, University of Georgia-Tifton; Cristiane Pilon, University of Georgia-Tifton</p>
11.15 AM	<p><u>Acquisition Pattern of Physiological Quality in Peanut Seeds Under Irrigated and Drought Conditions.</u> Leticia de Aguila Moreno, University of Georgia-Tifton; Cristiane Pilon, University of Georgia-Tifton; Adao F. dos Santos, University of Georgia; Marshall C. Lamb, USDA-ARS; R. Scott Tubbs, University of Georgia-Tifton; Timothy L. Grey, University of Georgia</p>
11.30 AM	<p><u>Root Phenotyping of Winter Wheat for Phosphorus Acquisition.</u> Rebecca K. McGrail, University of Kentucky; David Van Sanford, University of Kentucky; David H. McNear Jr., University of Kentucky</p>
11.45 PM	<p><u>Evaluation of Narrow-Row Corn (<i>Zea mays</i> L.) Production in the Mid-South.</u> John J. Williams, Mississippi State University; W. Brien Henry, Mississippi State University; Normie W. Buehring, Mississippi State University; Christopher A. Daves, Bayer CropScience</p>
12.00 PM	Adjourn 50

AGRONOMY

GRADUATE STUDENT ORAL COMPETITION – M.S. STUDENTS

Location: Olmsted 3

1.25 PM	Opening Remarks
1.30 PM	<u>Analyzing the Effectiveness of Winter Cover Cropping of Reducing Pollutant Loads in the Mississippi Alluvial Valley.</u> Thomas Badon , Mississippi State University; Joby Czarnecki , Mississippi State University; Beth Baker , Mississippi State University
1.45 PM	<u>Effect of Varying Storage Environments and Planting Conditions on Seedling Emergence of Peanut.</u> Caleb Weaver , University of Georgia-Tifton; W. Scott Monfort , University of Georgia-Tifton; Cristiane Pilon , University of Georgia-Tifton; Timothy L. Grey , University of Georgia; Ronald Scott Tubbs , University of Georgia
2.00 PM	<u>Testing the Impact of USDA Rhizobia Accessions on Nodulation, Nitrogen Assimilation, and Productivity of Guar.</u> Jennifer MacMillan , Texas A&M University; Curtis Adams , Texas A&M AgriLife Research
2.15 PM	<u>Physiological and Yield Response to Uniform Vs Non-Uniform Plant Stands of Varying Plant Populations for Non-Irrigated Cotton.</u> Brad Davis , University of Georgia-Athens; R. Scott Tubbs , University of Georgia-Tifton; John Snider , University of Georgia-Tifton; Robert Kemerait , University of Georgia
2.30 PM	<u>Analyzing the Effectiveness of Cover Crops in Reducing Pollutant Loads in the Mississippi Alluvial Valley.</u> Thomas Badon , Mississippi State University; Joby Czarnecki , Mississippi State University; Beth Baker , Mississippi State University
2.45 PM	<u>Peanut Plant Response to Vegetative Injury Occurring at Different Intensity and Stage of Growth.</u> Hayden B Godwin , University of Georgia Tifton Campus; R. Scott Tubbs , University of Georgia-Tifton; Cristiane Pilon , University of Georgia-Tifton; W. Scott Monfort , University of Georgia-Tifton; Wesley M Porter , University of Georgia - Tifton; James Houx , National Crop Insurance Services; Mark E. Zarnstorff , National Crop Insurance Services

AGRONOMY

3.00-3.15 PM	Break
3.15 PM	<u>Evaluation of Soybean (Glycine max) Yield and Quality Following Delayed Harvest Conditions.</u> Lou Adams , Mississippi State University; J. Trenton Irby , Mississippi State University; Jason Bond , Mississippi State University; Thomas W. Allen , Mississippi State University; William Maples , Mississippi State University; Alanna B. Scholtes , Mississippi State University
3.30 PM	<u>Evaluating Nest Detection Methods When Reviewing Videos As Opposed to Maps Produced from Unmanned Aerial Vehicles (UAVs) Equipped with Thermographic Imaging Technologies.</u> Lori M. Hearon , Mississippi State University; Jesse Morrison , Mississippi State University
3.45 PM	<u>Interactions between Landscape Topography and Cover Crops in a Southeastern Corn Cropping System.</u> Sam J Leuthold , University of Kentucky; Ole Wendroth , University of Kentucky; Montse Salmerón , University of Kentucky; Erin Haramoto , University of Kentucky; Hanna Poffenbarger , University of Kentucky
4.00 PM	<u>Effect of Cultivar, Fungicide Program, and Harvest Date on Germination and Vigor of Saved Peanut Seed.</u> Matthew Stuart , University of Georgia-Tifton; Walter Scott Monfort , University of Georgia-Tifton; Cristiane Pilon , University of Georgia-Tifton
4.15 PM	<u>Determining the Optimum Planter Downforce Settings in Soybeans.</u> Tyler Soignier , Clemson University ; Michael Plumblee , Clemson University
4.30 PM	Adjourn

4:00 pm SAAS General Business Meeting, Commonwealth 3

5:00 pm SAAS Reception/ Super Bowl Party – Griff's Sports Restaurant, 133 W Liberty St. (across the street)

AGRONOMY

MONDAY, FEBRUARY 3, 2019

PROFESSIONAL ORAL – CROPS

Location: Olmsted 3

7.55 AM	Opening Remarks
8.00 AM	<u>Variations in Field Level P and K Fertilizer Additions Based on Grid Sampling.</u> <i>M. Wayne Ebelhar, Mississippi State University; Richard E. Turner, Mississippi State University</i>
8.15 AM	<u>Identifying Practical Soil Health Indicators in Semi-Arid Environments.</u> <i>Paul B. DeLaune, Texas A&M AgriLife Research; Katie L. Lewis, Texas A&M AgriLife Research; Partson Mubvumba, Texas A&M AgriLife Research; Joseph A. Burke, Texas Agrilife Research-Lubbock</i>
8.30 AM	<u>Yield Response of Elite Eastern Gamagrass Genotypes to Post Harvest Nitrogen Application.</u> <i>Dylan Hollowell, Mississippi State University</i>
8.45 AM	<u>Agronomic Practices Regarding Industrial Hemp Production for Cannabinoids: A Pilot Study in Florida.</u> <i>Rui Yang, University of Florida; Erin Berthold, University of Florida; Josh Freeman, University of Florida; Sarah Benevenuto, University of Florida</i>
9.00 AM	<u>A Mesoporous Silica Nanoparticle Technology Applied in Dilute Nutrient Solution Accelerated Establishment of Zoysiagrass.</u> <i>Curtis Adams, Texas A&M AgriLife Research; John Erickson, University of Florida</i>
9.15 AM	<u>Increasing Seeding Rates and Nitrogen Rates for Irrigated Corn - Practical Considerations.</u> <i>M. Wayne Ebelhar, Mississippi State University; Brien Henry, Mississippi State University; Richard E. Turner, Mississippi State University</i>
9.30 AM	<u>Interaction of Planting Systems and Management Inputs for Soybean Production in the Mississippi Delta.</u> <i>Richard E. Turner, Mississippi State University; M. Wayne Ebelhar, Mississippi State University; J. Trenton Irby, Mississippi State University; Bobby R. Golden, Mississippi State University</i>

AGRONOMY

9.45 AM	<u>Integrated Alfalfa Production Systems in Mississippi.</u> <i>Rocky W. Lemus, Mississippi State University; Brett Rushing, Mississippi State University; Joshua Andrew White, Mississippi State University; Josh Maples, Mississippi State University</i>
10.00 AM	<u>Economic Impact of Increased Seeding Rates in Single Row Peanut in Georgia.</u> <i>W. Scott Monfort, University of Georgia-Tifton; Ronald Scott Tubbs, University of Georgia; Jennifer T Miller, University of Georgia Cooperative Extension Service</i>
10.15 AM	<u>Effect of Irrigation on Twin-Row Vs. Single-Row Soybean in the Humid Mississippi Delta.</u> <i>Srinivasa Rao Pinnamaneni, USDA-ARS; Saseendran Anapalli, USDA-ARS; Reddy Krishna, USDA-ARS; Fisher Daniel, USDA-ARS; Nacer Bellaloui, USDA-ARS; Nacer Bellaloui, USDA-ARS; Ruixiu Sui, USDA-ARS</i>
10.30 AM	<u>Nitrogen Credits from Peanut to Wheat.</u> <i>Michael J. Mulvaney, University of Florida West Florida Research & Education Center; Arun D Jani, University of Florida; Ramon G Leon, North Carolina State University; John Erickson, University of Florida; Heather A Enloe, University of Florida</i>
10.45 PM	Adjourn

11:00 AM-12:00 PM Agronomy Business Meeting and Awards

Location: **Olmsted 3**

HORTICULTURE

PROGRAM

2020 Annual Meeting
January 31 - February 2, 2020
Louisville, KY

84rd Year
Southern Region
American Society for Horticultural Science

100th Year
Horticulture Section
Southern Association of Agricultural Scientists

FRIDAY

7:00 am - 6:00 pm **Registration**
Building Room: Omni Hotel
Lobby

8:30 am - 5:00 pm **Southern Fruit Workers**
Building Room: Omni
Olmsted 2

10:00 am - 12:00 pm **ACB Club Share and
Networking**
Building Room: Omni Old
Louisville

12:00 pm - 5:00 pm **ACB Group Activities,
Tour, and Meal**
Building Room: TBA

1:00 pm - 4:45 pm **Watermelon Research
Group**
Building Room: Omni
Olmsted 3

1:00 pm - 5:00 pm **Horticulture
Administrators**
Building Room: Omni
Clifton

5:00 pm - 6:00 pm **Executive Committee
Meeting**
Building Room: Omni
Clifton

5:00 pm - until **ACB Mixer**
Building Room: TBA

SATURDAY

7:00 am - 6:00 pm **Registration**
Building Room: Second
Street Prefunction

8:00 am - 10:00 pm **Poster Set Up Room**
Building Room: Omni
Olmsted 4

8:00 am - 12:00 pm **J. Benton Storey
Horticulture Judging
Contest Setup**
Building Room: Omni
Olmsted 5

8:00 am - 11:15 am **Extension and Education
Section**
Building Room: Omni Old
Louisville

HORTICULTURE

8:00 am - 10:30 am **J. B. Edmond
Undergraduate Student
Paper Competition.**
Building Room: Omni
Cherokee Triangle

8:30 am - 4:00 pm **Watermelon Research
Group**
Building Room: Omni
Olmsted 3

10:00 am - 12:00 pm **Posters Authors Pin Up
Posters**
Building Room: Omni
Olmsted 4

10:45 am - 3:15 pm **Norman F. Childers M.S.
Student**
Building Room: Omni
Olmsted 6

12:00 pm - 5:00 pm **Poster Session Viewing**
Building Room: Omni
Olmsted 4

12:00 pm - 5:00 pm **J. Benton Storey
Horticulture Judging
Contest**
Building Room: Omni
Olmsted 5

1:00 pm - 4:00 pm **Fruit Crops Section**
Building Room: Omni Old
Louisville

1:00 am - 2:45 am **Floriculture,
Ornamentals and Turf
Section**
Building Room: Omni
Olmsted 1

3:30 pm - 5:15 pm **Warren S. Barham Ph.D.
Student Paper
Competition**
Building Room: Omni
Olmsted 6

SUNDAY

7:00 am - 10:45 am **Registration**
Building Room: Second
Street Prefunction

8:00 am - 10:45 pm **Poster Session Viewing**
Building Room: Omni
Olmsted 4

8:00 am - 9:30 am **Vegetable Crops Section**
Building Room: Omni Oak

8:00 am - 8:45 am **Floriculture,
Ornamentals and Turf
Section**
Building Room: Omni
Charred

8:00 am - 10:45 am **Fruit Crops Section**
Building Room: Omni
Barley

8:00 am - 9:00 am **Postharvest &
Biotechnology Section**
Building Room: Omni
Wheat

HORTICULTURE

- 9:00 am - 10:45am **ACB Business Meeting**
Building Room: Omni
Commonwealth 3
- 11:00 am - 12:30 pm **Annual Business Meeting and Award Program**
Building Room: Omni
Commonwealth 3
- 1:00 pm - 3:00 pm **Poster Session Take Down**
Building Room: Omni
Olmsted 4
- SAAS Program**
- 2:30 pm - 3:30 pm **SAAS Board Meeting**
Building Room: Omni
Commonwealth 3
- 4:00 pm - 5:00 pm **SAAS General Business Meeting**
Building Room: Omni
Commonwealth 3
- SAAS Super Bowl Party**
5:00 - until **Griff's Sports Restaurant**
(across street from hotel)

REGISTRATION

- Friday 7:00 am - 6 pm,
Hotel Lobby
- Saturday 7:00 am - 6 pm,
Second Street Prefunction
- Sunday 7:00 am - 10:45 am
Second Street Prefunction

FRIDAY, January 31, 2020

ACB Activities

- Building:** Omni
Room: Old Louisville
Time: 10:00 - 12:00 Club Share
12:00-5:00 Activity/Tour TBA
6:00 – Mixer TBA
- Presiding:** Rhiannon de la Rosa, ACB-President
Nate Phillips, ACB Advisor

SRASHS Executive Committee Meeting

- Building:** Omni
Room: Clifton
Time: 5:00 - 6:30
Presiding: Leo Lombardini, Chair

Working Groups

Listed at end of program

SATURDAY, February 1, 2020

STUDENT COMPETITIONS

HORTICULTURE

J. BENTON STOREY UNDERGRADUATE JUDGING CONTEST

- Building:** Omni
Room: Olmsted 5
Time: 8:00 - 12:00 Judging Contest Set-Up
12:00-5:00 Judging Contest
5:00 -until Scoring contest
- Presiding:** Robert Eicgas, ACB President-Elect
Steve Still, ACB Advisor for contest

J. B. EDMOND UNDERGRADUATE STUDENT PAPER COMPETITION

- Building:** Omni
Room: Cherokee Triangle
- Presiding:** Rhiannon de la Rosa, ACB-President,
Moderator
Bodie Pennisi, SRASHS President,
Courtesy Welcome to Undergrads
Chris Marble, Section Chair & Judging
Coordinator

Abstracts: To publish abstract in *HortScience*, see instructions at end of program. Submit on disk at meeting or email to Chair: marblesc@ufl.edu

Order of Presentations: roughly 15 min intervals

Assessing Variability of Nutritional Potency for Oil obtained from 'Pawnee' and 'Kanza' Pecans Grown at Various Locations in Oklahoma.

Jonathan Fenhaus¹, Niels Maness² and Lu Zhang²,
¹Department of Biology and Chemistry, University of Science and Arts of Oklahoma, Chickasha, OK 73018, ²Department of Horticulture and Landscape Architecture, Oklahoma State University, Stillwater, OK 74078. (jfen8162@usao.edu)

Comparison of Nut Growth with Heat Unit Accumulation for Pecans Planted in Different Geographical Locations in Oklahoma.

Skylar Baldwin¹, Lu Zhang², Charles Rohla³, Charles Fontainer² and Niels Maness², ¹College of Agriculture and Life Sciences, Mississippi State University, B.S. Hood Road, MS 39762, ²Department of Horticulture & Landscape Architecture, Oklahoma State University, Stillwater, OK 74078, ³Noble Research Institute, Ardmore, OK 73401. (luzhang@okstate.edu)

Exclusion of Major Insect Pests from Squash Utilizing Row Covers.

DeAnthony Price*, L.K. Carrier, and L. Brandenberger, 358 Agriculture Hall, Department of Horticulture and Landscape Architecture, Oklahoma State University, Stillwater, OK 74078-6027. (dprice5@stallions.abac.edu)

Methods of Informal Assessment. Adeline Holder* and Shelley Mitchell., Department of Horticulture and Landscape Architecture, 358 Ag Hall, Oklahoma State University, Stillwater, OK 74078. (adholder14@hotmail.com)

HORTICULTURE

Persistence and Water Use Rates of Selected Zoysiagrasses under Moderate Shade. Roy Stovall* and Charles Fontanier, Department of Horticulture and Landscape Architecture, 358 Ag Hall, Oklahoma State University, Stillwater, OK 74078. (charles.fontanier@okstate.edu)

The Biofiltration Ability of *Asparagus densiflorus* to Remove Sulfur Dioxide from the Indoor Atmosphere. Rhiannon A. de la Rosa^{1*} and Mary C. Savin², ¹Department of Horticulture, University of Arkansas, Fayetteville, AR 72701, ²105B Agriculture Building, Crop, Soil and Environmental Science, University of Arkansas, Fayetteville, AR 72701. (radelaro@email.uark.edu)

Tomato Cultivar Trials and Quality Analysis for Local Fresh Markets. Ty Bowman*, L.K. Carrier, and L. Brandenberger, 358 Agriculture Hall, Department of Horticulture and Landscape Architecture, Oklahoma State University, Stillwater, OK 74078-6027. (ty.bowman@langston.edu)

Using In-Vitro Screening to Find Sources of Tolerance to *Armillaria* spp. in *Prunus*. John Nisbet*, Sarah Miller, Guido Schnabel, Gregory Reighard and Ksenija Gasic, Department of Plant and Environmental Sciences, Clemson University, SC 29634-0310. (kgasic@clemson.edu)

NORMAN F. CHILDERS M.S. GRADUATE STUDENT PAPER COMPETITION

Building: Omni

Room: Olmsted 6

Presiding: Amy Wright, Chair

Abstracts: To publish abstract in *HortScience*, see instructions at end of program. Submit on disk at meeting or email to Chair: wrigham@auburn.edu

Order of Presentations: roughly 15 min intervals

A Comparative Study of Single Versus Double Plastic Covers of High Tunnels on the Growth and Yield of Kale. Arjun Kafle* and Sanjun Gu, Cooperative Extension, North Carolina A&T State University, Greensboro, NC 27401. (akafle@aggies.ncat.edu)

Assessments of Cane Characteristics and Fruit Quality of Blackberries Grown on the Rotating Cross-Arm trellis and T-trellis. Erika Henderson¹, Amanda McWhirt², Jackie Lee³, and Renee Threlfall⁴. ¹W. Maple St., Department of Horticulture, University of Arkansas, Fayetteville, AR 72701, ²2301 S. University, Department of Horticulture, University of Arkansas, Little Rock, AR 72204, ³1749 State Hwy 818, University of Arkansas Fruit Research Station, Clarksville, AR 72830, ⁴2650 N. Young Avenue, Food Science Department, University of Arkansas, Fayetteville, AR 72704

HORTICULTURE

Comparison of Trunk Wraps in their Ability to Protect Kiwifruit Vines from Freeze Injury. Joshua S. Cook^{1*}, James D. Spiers¹, Elina D. Coneva¹, James R. Kessler¹, and Edgar L. Vinson², 101 Funchess Hall, Department of Horticulture, Auburn University, Auburn, AL 36849, ²Chilton Research & Extension Center, 120 County Road 756, Clanton, Alabama 35045. (jsc0068@auburn.edu)

Economic Feasibility of Creating Value-added Products from Farmers Market Surplus. Morgan R. Gramlich^{1*}, Renee T. Threlfall², and Amanda L. McWhirt³, ¹316 Plant Science, Horticulture Department, University of Arkansas, Fayetteville, AR 72701, ²2650 N. Young Avenue, Food Science Department, University of Arkansas, Fayetteville, AR 72704, ³2301 S. University, Cooperative Extension Service, University of Arkansas, Little Rock, AR 72204. (mrgramli@email.uark.edu)

Effect of Hydrogen Cyanamide on Flower Production of Golden Kiwifruit. Jacob T. Kelley^{1*}, James D. Spiers¹, James R. Kessler¹, Elina D. Coneva¹, and Edgar L. Vinson², ¹Department of Horticulture, Auburn University, Auburn, Alabama 36849, ²Chilton Research & Extension Center, 120 County Road 756, Clanton, Alabama 35045. (jtk0016@auburn.edu)

Effect of pH on cucumber growth and nutrient availability in a de-coupled aquaponic system with minimal solids removal. Caroline E. Blanchard^{1*}, Daniel E. Wells¹, Jeremy M. Pickens², and David M. Blersch³, ¹Department of Horticulture, Auburn University, Auburn, AL 36849, ²Ornamental Horticulture Research Center, Mobile, AL 36689, ³Department of Biosystems Engineering, Auburn University, Auburn, AL 36849. (ceb0116@auburn.edu)

Evaluation of Row Covers in Yield Performance of Leafy Green Vegetables in Organic Management System. Kripa Dhakal* and Dilip Nandwani, Department of Agriculture and Environmental Sciences, Tennessee State University, Nashville, TN 37209 (dnandwan@tnstate.edu)

Factors Influencing Incidence and Severity of Bronzing Skin Disorder in Peach. John Mark Lawton*, Juan Carlos Melgar and Guido Schnabel, Department of Plant and Environmental Sciences, Clemson University, 105 Collings Street, Clemson, SC, 29634. (jlawton@g.clemson.edu)

Huanglongbing-associated Preharvest Fruit Drop in Sweet Orange. Sukhdeep Singh^{1*}, Tripti Vashisth¹, Christopher Vincent¹, and Fernando Alferez², ¹University of Florida, IFAS, Citrus Research and Education Center, 700 Experiment Station Road, Lake Alfred, FL 33850, ²University of Florida, IFAS, Southwest Florida Research and Education Center,

HORTICULTURE

2685 FL-29, Immokalee, FL 34142.
(sukhdeepsingh@ufl.edu)

Mapping the Primocane-Fruiting Locus in Blackberry (*Rubus subgenus Rubus*). Mitchell E. Armour^{1*}, Margaret L. Worthington¹, and Bode A. Olukolu², ¹Dept. of Horticulture, 316 Plant Science Building, University of Arkansas, Fayetteville, AR 72701, ²Dept. of Entomology & Plant Pathology, 352 Plant Biotechnology Building, University of Tennessee, Knoxville, TN 37996.
(mearmour@uark.edu)

Physiological and Quality Characteristics of Arkansas-grown Hops. James O. McCleelan^{1*}, Renee T. Threlfall¹, Amanda L. McWhirt², and Jackie Lee³, ¹2650 N. Young Avenue, Food Science Department, University of Arkansas, Fayetteville, AR 72704, ²2301 S. University, Cooperative Extension Service, University of Arkansas, Little Rock, AR 72204. ³1749 State Hwy 818, Fruit Research Station, University of Arkansas, Clarksville, AR 72830.
(jomccleelan@uark.edu)

Postharvest Changes of Physical and Chemical Fruit Quality Characteristics in Three Commercial Blueberry Types During Cold Storage. Rion T. Mooneyham^{1*}, Savithri U. Nambeesan², D. Scott NeSmith¹, Renée M. Allen³, Dario J. Chavez¹, and Rachel A. Itle¹, ¹Department of Horticulture, University of Georgia, 11109 Experiment Street Griffin, GA 30223, ²Department of Horticulture, University of Georgia, 1111 Miller Plant Science Building, Athens, GA 30602, ³University of Georgia Extension, 203 South Dixon Street, Suite 3, Alma, GA 31510. (rionmoon@uga.edu)

Results of a Two Year Study on the Performance of Table Grape Cultivar Jupiter with Cluster Thinning Treatments Under High Tunnels at Two Locations in Arkansas. Jose Hernandez*, Virginia Beasley, Karlee Pruitt, and M. E. Garcia, Department of Horticulture, University of Arkansas, Fayetteville, AR 72701. (megarcia@uark.edu)

The Effect of Leaching Fraction-Based Irrigation on Fertilizer Longevity and Leachate Nutrient Content in a Greenhouse Environment. Claire E. Krofftt^{1*}, Jeremy M. Pickens², Adam F. Newby³, Glenn B. Fain¹, and Jeff L. Sibley¹, ¹101 Funchess Hall, Department of Horticulture, Auburn University, Auburn, AL 36849, ²Ornamental Horticulture Research Center, P.O. Box 8276, Mobile, AL 36608, ³1300 Hickory Lane, Auburn, AL 36830 (cek0054@auburn.edu)

The Impact of Daughter-plant Harvest Technique and Nitrate: Ammonium Ratio on Asexual Reproduction in Day-neutral Strawberry (*Fragaria x ananassa* cv. 'Albion'). Xiaonan Shi* and Mark Hoffmann, Department of Horticultural Science, North Carolina State University, Raleigh, NC 27695.
(xshi8@ncsu.edu) 61

HORTICULTURE

Educating Scientists on Grower Needs Related to Indoor Plant Propagation. Kristin E. Gibson*, Alexa J. Lamm, and Fallys Masambuka, Department of Agricultural Leadership, Education, and Communication, University of Georgia, Athens, GA 30602. (kristin.gibson@uga.edu)

Two Year Study of Marketability Attributes of Jupiter Table Grape Grown Under High Tunnels at Two Locations in Arkansas. Virginia Beasley^{1*}, Renee Threlfall², Jose Hernandez¹, Karlee Pruitt¹, and M. E. Garcia¹, ¹316 Plant Science, Department of Horticulture, University of Arkansas, Fayetteville, AR 72701, ²2650 N. Young Ave. Food Science Department, University of Arkansas, Fayetteville, AR 72701. (megarcia@uark.edu)

Use of Plant Growth Regulators to Induce Uniform Flowering in Low-chill Peach Cultivar 'UFBest'. Bikash Adhikari^{1*}, Tripti Vashisth¹, Jeffrey G Williamson², and Ali Sarkhosh². ¹700 Experiment Station Rd, Citrus Research and Education Center, Horticultural Sciences Department, University of Florida, Lake Alfred, FL 33850, ²Fifield Hall, 2550 Hull Rd, Horticultural Sciences Department, University of Florida, Gainesville, FL 32611 (b.adhikari@ufl.edu)

WARREN S. BARHAM Ph.D. GRADUATE STUDENT PAPER COMPETITION

Building: Omni

Room: Olmsted 6

Presiding: Amy Wright, Chair

Abstracts: To publish abstract in *HortScience*, see instructions at end of program. Submit on disk at meeting or email to Chair: wrigham@auburn.edu

Order of Presentations: roughly 15 min intervals

A Comparison of Instrumental and Sensory Approaches to Evaluating Texture Profiles in Muscadine. T.M. Chizk^{1*}, Margaret L. Worthington¹, Renee T. Threlfall², ¹Department of Horticulture, 316 Plant Science Building, University of Arkansas, Fayetteville, AR, 72701, ² Food Science Building B-3, University of Arkansas, Fayetteville, AR 72701. (tmchizk@uark.edu)

Detection of the Gummy Stem Blight Pathogens in Watermelon Using Quick Field-Adapted Technologies. Jorge Reyes^{1*}, Caterina Villari², Marin Brewer³, Bhabesh Dutta³ and Cecilia McGregor¹, ¹Department of Horticulture, ²Warnell School of Forestry & Natural Resources, ³Department of Plant Pathology, University of Georgia, Athens, GA 30605 (jorgereyes155@uga.edu)

Discrete Blue and Red Narrowband Wavelengths Alter Flavor Volatile Profiles in Hydroponically Grown 'Italian Large Leaf' Basil. Hunter

HORTICULTURE

Hammock*, Dean Kopsell, and Carl Sams,
Department of Plant Sciences, University of
Tennessee, Knoxville, TN 37996.
(hhammoc1@vols.utk.edu)

Effect of an Inactivated Yeast Foliar Spray on Ripening and Harvest Attributes of Chambourcin Wine Grapes. Sarah E. Mayfield* and Renee T. Threlfall, 2650 N. Young Avenue, Food Science Department, University of Arkansas, Fayetteville, AR 72704. (sem013@email.uark.edu)

Effect of Ethylene De-greening Treatment on Fruit Quality and Postharvest Storage Life of HLB-affected Mandarin Cultivars. Faisal Shahzad^{1*}, Jeffrey K. Brecht², Yu Wang¹, Fred Gmitter¹, Mark A. Ritenour³ and Tripti Vashisth¹, ¹700 Experiment Station Rd, Citrus Research and Education Center, Lake Alfred, FL 33850, ²Horticulture Sciences Department, IFAS, Gainesville, University of Florida, FL 32611, ³Indian River Research and Education Center, Fort Pierce, University of Florida, FL 34945-3138. (amiabu@ufl.edu)

Effect of Honey as a Rooting Adjuvant on Rooting of Rosa 'Red Cascade' Stem Cuttings. Anthony T. Bowden^{1*}, Patricia R. Knight¹, Christine Coker¹, Sean Broderick², Eugene K. Blythe³, Hamidou Sakhanokho⁴, and Ebrahiem Babiker⁴, ¹Coastal Research and Extension Center, South Mississippi Branch Experiment Station, P.O. Box 193, Poplarville, MS 39470, ²Truck Crops Branch Experiment Station, 2024 Experiment Station Rd., Crystal Springs, MS 39059, ³College of Agriculture, Auburn University, Auburn, AL 36849, ⁴USDA-ARS Southern Horticultural Lab., P.O. Box 287, Poplarville, MS 39470. (ab1001@msstate.edu)

Effect of sand-injection and air-injection cultivation on creeping bentgrass. Naba Amgain* and Charles Fontanier, Department of Horticulture and Landscape Architecture, 358 Ag Hall, Oklahoma State University, Stillwater, OK 74078. (Naba@okstate.edu)

Effect of Total Immersion Auxin Application Method on Florida Azalea Survivability and Root Response. Jenny B. Ryals^{1*}, Patricia R. Knight¹, Daryl R. Chastain², Lloyd E. Ryals III³, Christine E. H. Coker⁴, Gary R. Bachman⁴, Jim DelPrince⁴, Patricia R. Drackett⁵, and Anthony T. Bowden¹. ¹Coastal Research and Extension Center, Mississippi State University, Poplarville, MS 39470, ²Delta Research and Extension Center, Mississippi State University, Stoneville, MS 38776, ³Mississippi Department of Agriculture and Commerce, Bureau of Plant Industry, Mississippi State, MS 39762, ⁴Coastal Research and Extension Center, Mississippi State University, Biloxi, MS 39532, ⁵The Crosby Arboretum, Mississippi State University, Picayune, MS 39466 (j.ryals@msstate.edu)

HORTICULTURE

Efficacy of Bagging as an Alternative Insect and Disease Management Tool for Peach (*Prunus persica* L.) in Florida. David Campbell^{1*}, Jennifer Gillett-Kaufman², Ali Sarkhosh¹, Jeffrey Brecht¹, and Danielle Treadwell¹, ¹Department of Horticultural Sciences, University of Florida, Gainesville, FL 32611, ²Department of Entomology, University of Florida, Gainesville, FL 32611. (campbell@ufl.edu)

Evaluation of Humic Substances on Yield Performance and Quality of Cantaloupe (*Cucumis melo* L.) in Organic Management System. ZaDarreyal Wiggins* and Dilip Nandwani, Department of Agriculture and Environmental Sciences, Tennessee State University, Nashville, TN 37209 (dnandwan@tnstate.edu)

Evaluation of Humic Substances on Yield Performance of Watermelon (*Citrullus lunatus* [Thunb.] Matsum and Nakai) in Organic Production System. Onyekachukwu Akaeze* and Dilip Nandwani, Department of Agriculture and Environmental Sciences, Tennessee State University, Nashville, TN 37209 (dnandwan@tnstate.edu)

Feasibility of Genomic Selection for Brown Rot Tolerance in Peach. Wanfang Fu*, Cassia da Silva Linge, Ralph Burrell and Ksenija Gasic, Department of Plant & Environmental Sciences, Clemson University, 105 Collings St., Clemson, SC 29634. (wfu@clemson.edu)

Influence of Fertilizer Placement on Growth of Eclipta (*Eclipta prostrata*) and its Competition Effect on Ligustrum (*Ligustrum lucidum*) and Boxwood (*Buxus microphylla*). Yuvraj Khamare*, S. Christopher Marble and Annette Chandler., University of Florida/IFAS, Mid-Florida Research and Education Center, Apopka, FL, 32703. (ykhamare@ufl.edu)

Water Use Pattern and Intrinsic Antioxidant Machinery Confer Tetraploid Volkamer Lemon Tolerance to Various Water-Deficit Scenarios. Muhammad Fasih Khalid^{1,2*}, Sajjad Hussain¹, Muhammad Akbar Anjum¹, Christopher Vincent², Shakeel Ahmad¹, Muhammad Arif Ali¹ and Raphael Morillon³, ¹Faculty of Agricultural Sciences and Technology, Bahauddin Zakariya University, 60800 Multan, Pakistan. ²Citrus Research and Education Center, University of Florida, 33850 Lake Alfred, FL, United States. ³Equipie "Structure Evolutive des Agrumes, Polyploidie et Amelioration Genetique", SEAPAG-UM AGAP-Department BIOS-CIRAD Station de Roujol 97170 Petit Bourg/Guadeloupe, France. (civince@ufl.edu)

POSTERS

Building: Omni
Room: Olmsted 4

HORTICULTURE

Presiding: Yan Chen, Chair

Abstracts: To publish abstract in *HortScience*, see instructions at end of program. Submit on disk at meeting or email to Chair: yachen@agcenter.lsu.edu

Set-Up Room: Saturday, 8:00-10:00

Mount Posters: Saturday, 10:00-noon

Poster Viewing

Saturday noon to 5:00 pm

Sunday 8:00-10:45 am

Authors at their poster:

Saturday, 1:00-3:00 pm even numbered posters

Saturday, 3:00-5:00 pm odd numbered posters

Take-down: Sunday, 1:00–3:00 pm

Student Poster Competition

UG = Indicates undergraduate poster titles

G = Indicates graduate poster titles

Floriculture, Ornamentals and Turf

1G) Honeybee (*Apis mellifera* L.) Visits to Crepe Myrtle (*Lagerstroemia indica* L.) Vary According to Proximity to Pollinator-Friendly Plants. Canaan Sutton*, Taryn Bazhaw, Martin Mendieta, Michaela Bledsoe, and Derald A. Harp, College of Agricultural Sciences and Natural Resources, Texas A&M University-Commerce, Commerce, TX 75429. (Derald.Harp@tamuc.edu)

2) Systematic Strategies to Manage Crape Myrtle Bark Scale (*Acanthococcus lagerstroemiae*). Runshi Xie¹, Bin Wu¹, Michael E Merchant², Erfan Vafaie², Yan Chen³, David Held⁴, Gary W. Knox⁵, Yu Zhang⁶, Jim Robbins⁷, Derald Harp⁸, and Mengmeng Gu^{2*}, ¹Department of Horticultural Sciences, Texas A&M University (TAMU), ²Texas A&M AgriLife Extension, ³LSU AgCenter Hammond Research Station, ⁴Department of Entomology and Plant Pathology, Auburn University, ⁵University of Florida IFAS, ⁶Department of Agricultural Economics, TAMU ⁷University of Arkansas-CES, ⁸Department of Agricultural Sciences, TAMU-Commerce. (mgu@tamuc.edu)

3UG) Honeybee (*Apis mellifera* L.) Visits to Crepe Myrtle (*Lagerstroemia indica* L.) Vary According to Cultivar and Month. Taryn Bazhaw*, Canaan Sutton, Martin Mendieta, Michaela Bledsoe, and Derald A. Harp, College of Agricultural Sciences and Natural Resources, Texas A&M University-Commerce, Commerce, TX 75429. (Derald.Harp@tamuc.edu)

HORTICULTURE

4G) Mechanical Control of Crepe Myrtle Bark Scale (*Acanthococcus lagerstroemiae* Kuwana). Michaela Bledsoe*, Canaan Sutton, Taryn Bazhaw, Martin Mendieta, and Derald A. Harp, College of Agricultural Sciences and Natural Resources, Texas A&M University-Commerce, Commerce, TX 75429. (Derald.Harp@tamuc.edu)

5) Increasing Sustainability of Residential Areas Using Rain Gardens to Improve Pollutant Capture, Biodiversity and Ecosystem Resilience. Amy Wright^{1*}, Jennifer Morash¹, and Charlene LeBleu². ¹Department of Horticulture, ²Program of Landscape Architecture, Auburn University, Auburn, AL 36849. (wrigham@auburn.edu)

6UG) A Comparison of Pan Traps to Insect Transects for Pollinator Monitoring in Crepe Myrtle (*Lagerstroemia indica* L.). Martin Mendieta*, Michaela Bledsoe, Canaan Sutton, Taryn Bazhaw, and Derald A. Harp, College of Agricultural Sciences and Natural Resources, Texas A&M University-Commerce, Commerce, TX 75429. (Derald.Harp@tamuc.edu)

7G) Pretreatment Techniques for Seed Propagation in *Ratibida columnifera* (Nutt.) Wooten & Standl. Kaitlin Hopkins^{1*}, Michael A. Arnold¹, Charles R. Hall¹, H. Brent Pemberton², and Marco A. Palma³, ¹Department of Horticultural Sciences, Texas A & M University, College Station, TX 77843-2133, ²Texas A&M AgriLife Research and Extension Center at Overton, 710 N FM 3053, P.O. Box 200, Overton, TX 75684, ³Department of Agricultural Economics, Texas A&M University, 2124 TAMU, College Station, TX 77843-2124. (hopkinska@tamu.edu)

8) An Overview of the Mississippi State University Extension Farmer Florist Series. Christine Coker^{1*}, James DelPrince¹, Benedict Posadas¹, Eric Stafne², Patricia Knight², and Christian Stephenson³, ¹MSU Coastal Research and Extension Center, 1815 Popp's Ferry Road, Biloxi, MS 39532. ²South Mississippi Branch Station, 810 Hwy. 26W, Poplarville, MS 39470, ³MSU Extension-Hancock County, 856 Ste. B, Hwy 90, Bay St. Louis, MS 39520. (christine.coker@msstate.edu)

9UG) Floral Bud and Fruit Development in *Hibiscus sabdariffa*. Imhotep Charles* and T.W. Zimmerman, University of the Virgin Islands Agricultural Experiment Station, RR#1 Box 10,000, Kingshill, VI 00850. (charlesimhotepctec@yahoo.com)

HORTICULTURE

- 10G) Effect of Sample Collection Methods on Anthocyanins in Crape Myrtle Flower Petals.** Jenny B. Ryals^{1*}, Patricia R. Knight¹, Ebrahiem Babiker², Christine E. H. Coker³, Gary R. Bachman³, Daryl R. Chastain⁴, Guihong Bi⁵, Ben Posadas³, and Lavinne Stringer². ¹Coastal Research and Extension Center, Mississippi State University, Poplarville, MS 39470, ²Thad Cochran Southern Horticultural Lab, USDA-ARS, Poplarville, MS 39470, ³Coastal Research and Extension Center, Mississippi State University, Biloxi, MS 39532, ⁴Delta Research and Extension Center, Mississippi State University, Stoneville, MS 38776, ⁵Department of Plant and Soil Sciences, Mississippi State University, Mississippi State, MS 39762. (j.ryals@msstate.edu)
- 11) Consumer Preferences and Willingness to Pay for Poinsettia Varieties (*Euphorbia pulcherrima* L.).** Caitlin McLeod* and Christine Coker, Patricia Knight, James DelPrince, Gary Bachman, Benedict Posadas and Scott Langlois, Coastal Research and Extension Center Mississippi State University, MS 39532. (cm1410@msstate.edu)
- 12UG) Asexual propagation of *Bucida buceras*: Air layering versus Groundlayering.** Eliam Sanchez Palaez*, M. Morgan and T.W. Zimmerman, University of the Virgin Islands Agricultural Experiment Station, RR#1 Box 10,000, Kingshill, VI 00850. (elansape00@hotmail.com)
- 13G) Effect of Pre-emergence Herbicides and Mulches on Rooting of Nursery Cuttings and Weed Control.** Isha Poudel* and Anthony Witcher, Department of Agricultural and Environmental Sciences, Otis L. Floyd Nursery Research Center, Tennessee State University, McMinnville, TN, 37110. (ipoudel@my.tnstate.edu)
- 14) Identification and Management of *Praxelis clematidea*; A New and Troublesome Weed in Central Florida.** S. Chris Marble*, Yuvraj Khamare, and Annette Chandler, Department of Environmental Horticulture, University of Florida, Mid-Florida Research and Education Center, 2725 S. Binion Rd., Apopka, FL 32703. (marblesc@ufl.edu)
- 15UG) Compost Substrate Amendments for Spicebushes.** Allie Maternowski, Winston Dunwell, Iin Handayani, Dava Hayden, Dwight Wolfe, and Virginia Travis. School of Agriculture, Murray State University, Murray, KY. (amaternowski1@murraystate.edu)

HORTICULTURE

- 16G) Light response curves for creeping bentgrass under temporal shade.** Naba Amgain* and Charles Fontanier., Department of Horticulture and Landscape Architecture, 358 Ag Hall, Oklahoma State University, Stillwater, OK 74078. (Naba@okstate.edu)
- 17) Multi-year Monitoring of Crapemyrtle Bark Scale Crawler Population across Louisiana.** Yan Chen^{1*}, Rodrigo Diaz², Mengmeng Gu³, Michael E Merchant³, Erfan Vafaie³, ¹Louisiana State University AgCenter Hammond Research Station, 21549 Old Covington Hwy., Hammond LA, ²Louisiana State University AgCenter Department of Entomology, Life Science Bldg. Baton Rouge, LA, ³Texas A&M AgriLife Extension. (yachen@agcenter.lsu.edu)
- 18UG) Influence of Cutting Type and Stem Position on Spring Cuttings of Pascagoula™ Crape Myrtle.** J. Skylar Baldwin^{1*}, Patricia R. Knight², Scott L. Langlois², Eugene K. Blythe², Jenny B. Ryals², Christine E. H. Coker³, Gary R. Bachman³, and Jim DelPrince³. ¹Department of Biochemistry, Molecular Biology, Entomology, and Plant Pathology, Mississippi State University, Mississippi State, MS 39762, ²Coastal Research and Extension Center, Mississippi State University, Poplarville, MS 39470, ³Coastal Research and Extension Center, Mississippi State University, Biloxi, MS 39532 (jsb702@msstate.edu)
- 19UG) Surface Temperature Measurements in An Urban Agricultural System as A Crop Grows.** K'Ori Terry*, Dr. Leigh Whittinghill, and Dr. Gebremedhin Maheteme. College of agriculture, Communities and the Environment, Kentucky State University, Frankfort, 40601. (kori.terry@kysu.edu)
- Fruit Crops**
- 20G) Using Paper Bags for Growing Peaches in Backyard Gardens: a New Horticultural Practice in the United States.** Ann Kule*, Juan Carlos Melgar, Department of Plant and Environmental Sciences, Clemson University, Clemson, SC 29634. (akule@clemson.edu)
- 21G) Biological and Biochemical Physiognomies of Pineapple Genotypes Grown under the Greenhouse Conditions in the Southern United States.** ASM Harun Sorker*, Zelalul Adam and Shahidul Islam¹, ¹Department of Agriculture /Agricultural Regulations, University of Arkansas at Pine bluff, 153 Woodard Hall, Pine Bluff, AR 71601. (islams@uapb.edu)

HORTICULTURE

- 22) **Yield Performance of Three Fall Fruiting Blackberry Selections Grown Organically in Kentucky.** Jeremiah D. Lowe*, Kirk W. Pomper, and Sheri B. Crabtree. College of Agriculture, Communities, and the Environment, Kentucky State University, Cooperative Extension Building, Frankfort KY 40601-2355. (jeremy.lowe@kysu.edu)
- 23G) **Effects of NAA, AVG, and 1-MCP on Preharvest Fruit Drop, Fruit Maturity, and Quality of 'AU Golden Sunshine' Kiwifruit.** Jacob T. Kelley^{1*}, James D. Spiers¹, James R. Kessler¹, Elina D. Coneva¹, and Edgar L. Vinson², ¹Department of Horticulture, Auburn University, Auburn, Alabama 36849, ²Chilton Research & Extension Center, 120 County Road 756, Clanton, Alabama 35045. (jtk0016@auburn.edu)
- 24G) **Leaf and flower morphology of Ecuadorian *P. serotina* subsp. *Capuli*.** Sakshi Pathania^{1*}, Juan C. Carrasco², Carlos R. Chavez², Luis Fiallos³, and Dario J. Chavez¹, ¹University of Georgia, Department of Horticulture, Griffin, GA, USA; ²Faculty of Natural Resources, Escuela Superior Politécnica de Chimborazo, Riobamba, Ecuador; ³Faculty of Livestock Sciences, Escuela Superior Politécnica de Chimborazo, Riobamba, Ecuador. (sp28191@uga.edu)
- 25) **Precocious Fruit Production in 2 Year Old Bark Inlay Grafted Pawpaw Trees.** Sheri B. Crabtree^{1*}, Jeremiah D. Lowe¹, Kirk W. Pomper¹, and R. Neal Peterson², ¹College of Agriculture, Communities, and the Environment, Kentucky State University, Cooperative Extension Building, Frankfort KY 40601, ²Peterson Pawpaws, Harpers Ferry, WV 25425. (sheri.crabtree@kysu.edu)
- 26G) **Rapid Digital Imaging Approach for Screening Red Drupelet Reversion in Blackberry.** T.M. Chizk*, Margaret L. Worthington, and John R. Clark, Department of Horticulture, 316 Plant Science Building, University of Arkansas, Fayetteville, AR, 72701. (tmchizk@uark.edu)
- 27G) **Apple Fruit Size Is Enhanced with Increasing 6-BA Application Number.** Krittika Tonapi^{1*}, Anish Malladi¹ and Tom Kon², ¹1111 Miller Plant Sciences, Department of Horticulture, University of Georgia, Athens, GA 30602, ²Department of Horticultural Sciences, North Carolina State University, Mountain Horticultural Crops and Research and Extension Center, 455 Research Drive, Mills River, NC, 28759. (kvt71052@uga.edu)

HORTICULTURE

- 28G) **The Backbone of Fruit: Cell Wall Polysaccharides in Grafted and Non-grafted 'Liberty' Watermelon at Varying Levels of Hollow Heart.** Marlee A. Trandel^{*1}, Penelope Perkins-Veazie¹, Suzanne Johanningsmeier², Jonathan Schultheis³ and Chris Gunter³, ¹North Carolina State University, Department of Horticultural Sciences, 600 Laureate Way, Plants for Human Health Institute, Kannapolis NC 28081, ²North Carolina State University, Department of Food, Bioprocessing and Nutrition Sciences, 400 Dan Allen Drive, Schaub Hall, Raleigh NC 27606, ³North Carolina State University, Department of Horticultural Sciences, 2721 Founders Drive, Kilgore Hall, Raleigh NC 27606. (matrande@ncsu.edu)
- 29G) **Effect of Biochar on Root Morphology and Nutrient Content in Muscadine Grape (*Vitis rotundifolia* L.).** Yuru Chang* and Ali Sarkhosh, Horticultural Sciences Department, University of Florida, Gainesville, FL 32611-0690. (changyuru@ufl.edu)
- 30G) **Physiological Responses of Six Prunus Rootstocks Submitted to Waterlogging Stress.** Trequan McGee^{1*}, Ali Sarkhosh¹, Jose Chaparro¹, and Tom Beckman²; ¹Horticultural Sciences Department, University of Florida, Gainesville, FL 32611. ²USD-ARS, Fruit and Tree Nut Research, Byron, GA (trequanmcgee@ufl.edu)
- 31G) **Effect of Rootstock Cultivar on Consumer Quality Attributes of 'Aztec Fuji' Apple.** Dylan Teel^{*}, Elina Coneva, Floyd M. Woods, and Nylan. Holmes. Department of Horticulture, Auburn University, Auburn, AL 36849-5408. (edc001@auburn.edu)
- Vegetable Crops**
- 32G) **Selection of Stable Bush-Type Southern Appalachian Heirloom Snap Beans.** Mary A. Mahan* and Brian M. Leckie, School of Agriculture, Tennessee Tech University, Cookeville, TN 38505. (bleckie@tntech.edu)
- 33UG) **Insect Populations in Screened and Unscreened Summer Squash (*Cucurbita pepo*).** DeAnthony Price*, L.K. Carrier, and L. Brandenberger, 358 Agriculture Hall, Department of Horticulture and Landscape Architecture, Oklahoma State University, Stillwater, OK 74078-6027. (dprice5@stallions.abac.edu)

HORTICULTURE

- 34G) Small Farm Evaluation of Bush-Type Southern Appalachian Heirloom Snap Beans.** Erik Koehler* and Brian M. Leckie, School of Agriculture, Tennessee Tech University, Cookeville, TN 38505. (bleckie@tntech.edu)
- 35UG) Quality Evaluations of Fresh Market Tomatoes (*Lycopersicon esculentum* L.).** Ty Bowman*, L.K. Carrier, and L. Brandenberger, 358 Agriculture Hall, Department of Horticulture and Landscape Architecture, Oklahoma State University, Stillwater, OK 74078-6027. (ty.bowman@langston.edu)
- 36) Compost Type and Rate Effects on Plant Yield and Mineral Nutrients in Bell Pepper (*Capsicum annum* L.).** Juan C. Díaz-Pérez*. Department of Horticulture, Tifton Campus, University of Georgia, Tifton, GA 31793 (jcdiaz@uga.edu)
- 37) Comparative Study of Ginger Mineral Nutrient Contents.** Guochen Yang*, Julia Robinson, Sanjun Gu, Zhongge (Cindy) Lu, William Lashley, and Bryce Holms, College of Agriculture and Environmental Sciences, North Carolina A&T State University, Greensboro, NC 27411. (yangg@ncat.edu)
- 38G) Differential Lead (Pb) Accumulation in Cold Season Vegetables and Raised Garden Bed Barrier Evaluations for Safer Gardening.** Celine Richard*, Kiki Fontenot, Edward Bush, Taylor Bryant, and Heather Kirk-Ballard, School of Plant, Environmental, and Soil Sciences, Louisiana State University Agricultural Center, Baton Rouge, LA 70803. (crich99@lsu.edu)
- 39G) Utilization of KASP Assays for Marker Assisted Selection of Key Watermelon Traits.** Samuel Manthi*¹, Geungjoo Lee² and Cecilia McGregor¹, ¹Department of Horticulture, University of Georgia, 1111 Plant Sciences Building, Athens, GA 30602, USA, ²Department of Horticulture, Chungnam National University, Daejeon 34134, Republic of Korea. (Samuel.Josiah@uga.edu)
- 40) Characterization of Southern Appalachian Heirloom Snap Beans using Genotyping by Sequencing.** Brian M. Leckie* and Michael Best, School of Agriculture, Tennessee Tech University, Cookeville, TN 38505. (bleckie@tntech.edu)
- 41UG) Influence of Deflowering on Jicama Production.** Milan Philbert* and T.W. Zimmerman, University of the Virgin Islands

HORTICULTURE

- Agricultural Experiment Station, RR#1 Box 10,000, Kingshill, VI 00850. (milkphilbert@gmail.com)
- 42G) Warm and Cool LED Supplements Impact Key Flavor Volatiles in Hydroponically Grown 'Purple Petra' Basil.** Hunter Hammock*, Dean Kopsell, and Carl Sams, Department of Plant Sciences, University of Tennessee, Knoxville, TN 37996. (hhammoc1@vols.utk.edu)
- 43G) Bulk Segregant Analysis Identification of Four Gummy Stem Blight Resistance Loci in Wild Watermelon Relatives.** Lincoln Adams* and Cecilia McGregor. 1401 Miller Plant Sciences, Institute of Plant Breeding, Genetics, and Genomics, University of Georgia, Athens, Georgia 30605. (Lincoln.Adams@uga.edu)
- 44UG) The Influence of Single and Double-Rows on Sweetpotato Production.** Kervin Mathurin* and T.W. Zimmerman, University of the Virgin Islands Agricultural Experiment Station, RR#1 Box 10,000, Kingshill, VI 00850. (kervinmathurin@gmail.com)
- 45) Effect of Slow Release Fertilizer on Mineral Nutrition and Fruit Yield in Bell Pepper (*Capsicum annum* L.).** Juan C. Díaz-Pérez*. Department of Horticulture, Tifton Campus, University of Georgia, Tifton, GA 31793 (jcdiaz@uga.edu)
- 46G) Growth and Yield of Pak Choi in High Tunnels of Single- and Double-Layers of Plastic Covers.** Arjun Kafle* and Sanjun Gu. Cooperative Extension, North Carolina A&T State University, Greensboro, NC 27401. (akafle@aggies.ncat.edu)
- 47UG) Squash Bug Ovipositional Preference within *Cucurbita pepo*.** Grayson DeLay*, Chelsea Sanders, and Brian M. Leckie, School of Agriculture, Tennessee Tech University, Cookeville, TN 38505. (bleckie@tntech.edu)
- 48G) Impact of a Shaded High Tunnel Effects for Organically-Grown Summer Lettuce in Georgia.** Savannah Laur* and T. Coolong., Department of Horticulture, University of Georgia, Athens, GA 30602 (sal98292@uga.edu)
- 49UG) Ovipositional Preference of Silverleaf Whitefly on Benchmark Acylsugar Tomato Breeding Lines.** Brianah Castleberry^{1*}, Erik Koehler¹, Martha A. Mutschler², and Brian M. Leckie¹, ¹School of Agriculture, Tennessee Tech University, Cookeville, TN 38505, ²School of Integrated Plant Science, Plant

HORTICULTURE

Breeding and Genetics Section, Cornell University, Ithaca, NY 14853.
(bleckie@tntech.edu)

- 50) **“Every Piece a Work of Art”: Ella Grant Campbell, Florist.** James M. DelPrince, Mississippi State University Coastal Research and Extension Center, 1815 Poppo Ferry Rd., Biloxi, MS 39532.
(JDelPrince@pss.msstate.edu)

Post-Harvest and Biotechnology

- 51G) **Role of Mineral Nutrition in Citrus Fruit Quality and Postharvest Storage Life of HLB-affected Mandarin cv. ‘LB8-9’ (Sugar Belle®).** Faisal Shahzad^{1*}, Jeffrey K. Brecht², Yu Wang¹, Fred Gmitter¹, Mark A. Ritenour³ and Tripti Vashisth¹, ¹Citrus Research and Education Center, 700 Experiment Station Rd, Lake Alfred, FL 33850, ²Horticulture Sciences Department, IFAS, Gainesville, University of Florida, FL 32611, ³Indian River Research and Education Center, Fort Pierce, University of Florida, FL 34945. (amiabu@ufl.edu)
- 52G) **Effects of Cooling and Postharvest Storage Methods on the Quality of Broccoli (*Brassica oleracea* var. *Italica*).** Sarah E. Parker^{1*}, Jennifer R. Wheeler¹, Curtis R. Luckett², Dennis E. Deyton¹, Carl E. Sams¹, ¹Department of Plant Science, Institute of Agriculture, University of Tennessee, Knoxville, TN 37996, ²Department of Food Science, Institute of Agriculture, University of Tennessee, Knoxville, TN 37996.
(sparke53@utk.edu)
- 53G) **Working to Better Understand Postharvest Fresh Keeping Quality in Blueberry through Differential Gene Expression Analyses.** Rion T. Mooneyham^{1*}, Yi-Wen Wang², Savithri U. Nambeesan², Dario J. Chavez¹, and Rachel A. Itle¹, ¹Department of Horticulture, University of Georgia, 1109 Experiment Street Griffin, GA 30223, ²Department of Horticulture, University of Georgia, 1111 Miller Plant Science Building, Athens, GA 30602. (rionmoon@uga.edu)
- 54G) **Phytochemical Profile in Finger Lime (*Citrus australasica*).** Bikash Adhikari^{1*}, Manjul Dutt¹ Tripti Vashisth¹, ¹700 Experiment Station Rd, Citrus Research and Education Center, Horticultural Sciences Department, University of Florida, Lake Alfred, FL 33850, (b.adhikari@ufl.edu)

HORTICULTURE

Cross-Commodity

- 55G) **Evaluation of Saffron (*Crocus sativa* L.) in Four Growing Systems.** Pradip Poudel^{*}, Hideka Kobayashi, Shawn Lucas and Leigh Whittinghill, College of agriculture, Communities and the Environment, Kentucky State University, Frankfort, 40601.
(Pradip.Poudel@kysu.edu)
- 56) **Impact of Winemaking Techniques on Characteristics of Enchantment Wine.** Sarah E. Mayfield^{1*}, Renee T. Threlfall¹, and John R. Clark², ¹2650 N. Young Avenue, Food Science Department, University of Arkansas, Fayetteville, AR 72704, ²316 Plant Science, Horticulture Department, University of Arkansas, Fayetteville, AR 72701.
(sem013@email.uark.edu)
- 57UG) **Comparison of Hydroponic American Ginseng (*Panax quinquefolius*) in Response to the Absence of Specific Nutrients.** Elizabeth Clippard^{1*}, Nate Phillips², Song Cui², Robert Eichas², and Ying Gao², ¹Biology Department, ²School of Agriculture, Middle Tennessee State University, Murfreesboro TN, 37132.
(elizabeth.clippard@gmail.com)
- 58G) **Effect of Cooking Methods on the Bioactive Compounds and Physiological Functions of Sweetpotato Leaves (*Ipomoea batatas* L. Lam).** Mosammat Briti Rabbani^{*}, Zelalul Adam and Shahidul Islam, Department of Agriculture /Agricultural Regulations, University of Arkansas at Pine Bluff, 153 Woodard Hall, Pine Bluff, AR 71601. (islams@uapb.edu)
- 59) **Anticipating Farmers Market Surplus for Creating Value-added Products.** Morgan R. Gramlich^{1*}, Renee T. Threlfall², and Amanda L. McWhirt³, ¹316 Plant Science, Department of Horticulture, University of Arkansas, Fayetteville, AR 72701, ²2650 N. Young Avenue, Food Science Department, University of Arkansas, Fayetteville, AR 72704, ³2301 S. University, Cooperative Extension Service, University of Arkansas, Little Rock, AR 72204.
(mgramli@email.uark.edu)
- 60UG) **The Distinction of Antioxidant Capacity of Colored Sweetpotatoes (*Ipomoea batatas* L.) and Its Tops in Relation to Polyphenolic Contents.** Jameka Hartson^{*}, Zelalul Adam and Shahidul Islam, Department of Agriculture /Agricultural Regulations, University of Arkansas at Pine Bluff, 153 Woodard Hall, Pine Bluff, AR 71601. (islams@uapb.edu)

HORTICULTURE

SECTION TITLES

EXTENSION AND EDUCATION

Building: Omni

Room: Old Louisville

Presiding: Mike Schnelle, Chair Extension
Richard Harkess, Chair Education

Abstracts: To publish abstract in *HortScience*, see instructions at end of program. Submit on disk at meeting or email to Chair: mike.schnelle@okstate.edu, or richard.harkess@msstate.edu

Education

8:00 The Utilization of User Fees to Manage Greenhouses and Growth Chambers at Public and Land Grant Universities. Kennedy Mayfield-Smith*, Alexa J. Lamm, Robert Stougaard, Department of Agricultural Leadership, Education, and Communication, University of Georgia, Athens, GA 30602 (Kennedy.Mayfieldsmith@uga.edu)

Extension

8:15 Using Motivations and Benefits to Calculate Match for Extension Master Gardener Volunteers. Sheri Dorn^{1*}, Svoboda Pennisi¹, Ellen Bauske², and Uttam Bhattarai³, ¹Department of Horticulture, University of Georgia, Griffin, GA 30224, ²Department of Plant Pathology, University of Georgia, Griffin, GA 30224, ³Experimental Statistics, University of Georgia, Griffin, GA 30224. (sdorn@uga.edu)

8:30 Horticulture CSI: The Latest Clues in the Search for the Long Beach Red Radish. Gary R. Bachman^{1*}, Christine E.H. Coker¹ and Patricia R. Knight², ¹Coastal Research and Extension Center, Mississippi State University, 1815 Popps Ferry Road, Biloxi, MS 38532, ²Coastal Horticulture Research, South Mississippi Branch Station, Poplarville, MS 39470. (gary.bachman@msstate.edu)

8:45 Indoor Plant Growers' Preferred Sources of Agricultural Information. Fally Masambuka-Kanchewa*, Kristin E. Gibson and Alexa J. Lamm, Department of Agricultural Leadership and Communication, University of Georgia, Four Towers, Suite 209, 405 College Station Road, Athens, GA 30602. (fallys.masambuka@uga.edu)

9:00 Industrial Hemp Pilot Program at A&T Provides Guidance to Small Farmers in North Carolina. Sanjun Gu^{1*}, Guochen Yang² and Valerie Giddings³, ¹Cooperative Extension, ²Department of Natural Resources and

HORTICULTURE

Environmental Design, ³Department of Family and Consumer Sciences, North Carolina A&T

State University, Greensboro, NC 27401. (sgu@ncat.edu)

9:15 Break

9:30 Modernizing Extension Publications: A Case Study of U.S. Landscape Design Resources. Cheryl R. Boyer*, Jianqiao Luan, and Gregory Davis. Department of Horticulture and Natural Resources, Manhattan, KS 66506. (crboyer@ksu.edu)

9:45 Dealing a Winning Strategy: An Integrated Pest Management Card Deck for Extension Learning. Cheryl R. Boyer^{1*}, Frannie L. Miller², and Brooke M. Garcia², ¹Department of Horticulture and Natural Resources, Kansas State University, Manhattan, KS 66506, ²Department of Entomology, Kansas State University, Manhattan, KS 66506. (crboyer@ksu.edu)

10:00 Implementation of an LSU AgCenter K-12th School Garden Leadership Workshop to Assess and Teach Basic Horticulture Skills. Celine Richard^{1,2*}, Kiki Fontenot², Edward Bush^{1,2}, Pam Blanchard¹ and Carl Motsenbocker^{1,2}, ¹Louisiana State University, Baton Rouge, LA 70803; ²Louisiana State University Agricultural Center, Baton Rouge, LA 70803. (crich99@lsu.edu)

10:15 Trail Users' Perceptions of Plant Species as a Tool for Future Design in Restoring Degraded Landscapes. Rachel Bechtold*, Catherine W. Shoulders, Jennie Popp, Lisa Wood, Elena Garcia, and Donald M. Johnson, Department of Agricultural Education, Communications and Technology, University of Arkansas, Fayetteville, AR 72701. (cshoulde@uark.edu)

10:30 Break

10:45 The Effectiveness of an Online Webinar Platform for Training Cooperative Extension Agents in Blueberry Production. Amanda McWhirt^{1*}, Bill Cline², Ryan Neal³, Lizzy Herrera¹ and Mary Poling⁴. ¹2301 S. University, Department of Horticulture, University of Arkansas Cooperative Extension Service, Little Rock, AR 72204, ²3800 Castle Hayne Rd, Department of Entomology and Plant Pathology, Horticultural Crops Research Station, North Carolina State University, Castle Hayne, NC 28429, ³1204 SW 14th St. Suite 2, Benton County University of Arkansas Cooperative Extension Service,

HORTICULTURE

Bentonville, AR 72712, ⁴2301 S. University, Department of Information Technology, University, University of Arkansas Cooperative Extension Service, Little Rock, AR 72204. (amcwhirt@uaex.edu)

- 11:00 Promoting Tall Ridged Beds to Improve Plant Stand, Growth and Production of Vegetable Crops in Areas Prone to Flooding Conditions.** Ramón A. Arancibia. University of Missouri Extension, WC Region, Butler, MO 64730. (Raa522@missouri.edu)

FLORICULTURE, ORNAMENALS AND TURF

Building: Omni

Room: Olmsted 1

Presiding: Jeb Fields, Chair

Abstracts: To publish abstract in *HortScience*, see instructions at end of program. Submit on disk at meeting or email to Chair: Jeb Fields, jfields@agcenter.lsu.edu

- 1:00 Short-term Effects of Basal Stem Glufosinate Applications to Nursery Trees.** Anthony L. Witcher*, Department of Agricultural and Environmental Sciences, Otis L. Floyd Nursery Research Center, Tennessee State University, 472 Cadillac Ln., McMinnville, TN 37110. (awitcher@tnstate.edu)
- 1:15 From Pot to Reservoir: Tracking Nitrogen Movement at a SC Nursery.** Sarah A. White^{1*}, John C. Majsztrik¹, William H.J. Strosnider², Lauren M. Garcia Chance³, Natasha L. Bell⁴, and Daniel R. Hitchcock⁵, ¹E-143 Poole Agricultural Center, Department of Plant and Environmental Sciences, Clemson University, Clemson, SC 29634, ²2306 Crabhall Rd, Belle W. Baruch Institute for Marine and Coastal Sciences, University of South Carolina, Georgetown, SC 29442, ³East 5th Street, Department of Engineering, East Carolina University, Greenville, NC 27858, ⁴177 Hobcaw Rd. Department of Agricultural Sciences, Clemson University, Georgetown, SC 29442 (swhite4@clemson.edu)
- 1:30 Substrate stratification: A media management strategy for increased resource efficiency.** Jeb S. Fields^{1*}, James S. Owen, Jr.², and James Altland², ¹Hammond Research Station, 21549 Old Covington Hwy, Louisiana State University Agricultural Center, Hammond, LA 70403, ²Hampton Roads Agricultural Research and Extension Center, 1444 Diamond Springs Rd., Virginia Tech, Virginia Beach, VA 23455, and ³USDA-ARS, 1680 Madison Ave., Wooster, OH 44691. (JSFields@agcenter.lsu.edu)

HORTICULTURE

- 1:45 Analysis of energy use and its impact on carbon footprint of four greenhouse model systems.** Dewayne L. Ingram¹, Charles R. Hall² and Joshua Knight¹, ¹Department of Horticulture, University of Kentucky, Lexington, KY 40506 and ²Department of Horticulture, Texas A&M University, College Station, TX 77843. (dingram@uky.edu)
- 2:00 Break**
- 2:15 Carbohydrate allocation of creeping bentgrass under temporal shade.** Saydi Loewer, Naba Amgain*, Paden House, and Charles Fontanier. Department of Horticulture and Landscape Architecture, 358 Ag Hall, Oklahoma State University, Stillwater, OK 74078. (Naba@okstate.edu).
- 2:30 Boxwood dieback: A new disease of boxwood in the United States.** Raj Singh, Plant Pathology and Crop Physiology Department, 434 Life Sciences Building, Louisiana State University Agricultural Center, Baton Rouge, LA 70803. (rsingh@agcenter.lsu.edu)
- 2:45 Climate change raises unforeseen challenges to plant development and specification for sustainable 21st century built environments.** Michael A. Arnold*, Department of Horticultural Sciences, Texas A&M University, College Station, TX 77843. (ma-arnold@tamu.edu)

FRUIT CROPS

Building: Omni

Room: Old Louisville

Presiding: Justin Scheiner, Chair

Abstracts: To publish abstract in *HortScience*, see instructions at end of program. Submit on disk at meeting or email to: jscheiner@tamu.edu

- 1:00 Canopy Management Evaluation of Three Arkansas Table Grape Cultivars: Gratitude, Faith, and Jupiter Grown Under a High Tunnel System.** Jose Hernandez^{1*}, Virginia Beasley¹, Karlee Pruitt¹, and M. E. Garcia¹, 316 Plant Science, Department of Horticulture, University of Arkansas, Fayetteville, AR 72701. (megarcia@uark.edu)
- 1:15 Post-harvest Storage Performance of Three Table Grape Cultivars: Gratitude, Faith, and Jupiter Under a High Tunnel System.** Virginia Beasley^{1*}, Renee Therfall², Jose Hernandez¹, Karlee Pruitt¹, and M. E. Garcia¹, 316 Plant Science, Department of Horticulture, University of Arkansas, Fayetteville, AR 72701, ²2650 N.

HORTICULTURE

Young Ave. Food Science Department,
University of Arkansas, Fayetteville, AR 72701.
(megarcia@uark.edu)

1:30 Link Between Fruit Development and Mature Fruit Drop in Huanglongbing-Affected Sweet Orange (*Citrus sinensis*). Lisa Tang*, Sukhdeep Singh, and Tripti Vashisth, Citrus Research and Education Center, University of Florida, Lake Alfred, FL 33850.
(tvashisth@ufl.edu)

1:45 Update on UGA Research for Irrigation and Fertilization Practices for Young Peach Trees in the Southeastern United States. Bruno Casamali¹, Marc W. van Iersel², and Dario J. Chavez^{*1}, ¹1109 Experiment St., Depart of Horticulture, Univ of Georgia, Griffin, GA 30223, ²1111 Miller Plant Science Bldg., Depart of Horticulture, Univ of Georgia, Athens, GA 30602 (dchavez@uga.edu)

2:00 Identifying Quality and Sensory Attributes of Arkansas-grown Hops. Renee T. Threlfall^{1*}, Arnout VanDamme¹, James O. McCleelan¹, Amanda L. McWhirt², and Jackie Lee³, ¹2650 N. Young Avenue, Food Science Department, Univ of Arkansas, Fayetteville, AR 72704, ²2301 S. University, Cooperative Extension Service, Univ of Arkansas, Little Rock, AR 72204. ³1749 State Hwy 818, Fruit Research Station, Univ of Arkansas, Clarksville, AR 72830. (rthrelf@uark.edu)

2:15 Break

2:30 Consumer Sensory Attributes of Arkansas Fresh-Market Blackberry Cultivars that Impact Marketability. Renee T. Threlfall^{1*}, John R. Clark², and Margaret L. Worthington², ¹2650 N. Young Avenue, Food Science Department, University of Arkansas, Fayetteville, AR 72704, ²316 Plant Science, Horticulture Department, University of Arkansas, Fayetteville, AR 72701.
(rthrelf@uark.edu)

2:45 Evaluating the Potential for Contamination of Grapevine Petiole Versus Whole Leaf Tissue Samples for Nutrient Analysis. Justin Scheiner* and Fran Pontasch, Depart of Horticultural Sciences, Texas A&M Univ, Texas A&M AgriLife Extension, TAMU, College Station, TX 77843. (jscheiner@tamu.edu)

3:00`Effect of Foliar Application of ERGER on Growth and Fruit Quality of Peach cv. 'UFSun'. Shirin Shahkoomahally and Ali Sarkhosh. Department of Horticultural Science, Uneristy of Floriday, Gainesville, FL 32611.
(s.shahkoomahally@ufl.edu)

HORTICULTURE

3:15 Two Year Evaluation of Biopesticide Combinations for Plasticulture Strawberries Grown in High Tunnels in Arkansas. M. Elena Garcia^{*1}, Karlee Pruitt¹, Russ Wallace², ¹316 Plant Science, Department of Horticulture, University of Arkansas, Fayetteville, AR 72701, ² 1102 East FM 1294, Texas A&M University, Lubbock, TX 79403.
(megarcia@uark.edu)

3:30 Post-harvest Broad Mite (*Polyphagotarsonemus latus*) Infestations in Arkansas Blackberry. Aaron J. Cato, 2301 South University Ave, Department of Horticulture, University of Arkansas, Little Rock, AR, 72204. (acato@uaex.edu)

3:45 Freezing Temperature Responses of Flower Stigmas on "Pawnee", "Kanza" and "Maramec" Pecan Trees. Lu Zhang*, Niels Maness and Justin Moss, Department of Horticulture & Landscape Architecture, Oklahoma State University, Stillwater, OK 74078. (luzhang@okstate.edu)

Sunday, February 2, 2020

ACB BUSINESS MEETING

Building: Omni

Room Commonwealth 3

Time: 9:00 – 10:45

Presiding: Rhiannon de la Rosa, President

ANNUAL BUSINESS MEETING AND AWARDS PROGRAM

Building: Omni

Room: Commonwealth 3

Time: 11:00-12:30

Presiding: Bodie Pennisi, President

POSTER VIEWING

& TAKE-DOWN

POSTERS

Building: Omni

Room: Olmsted 4

Presiding: Yan Chen, Chair

Poster Viewing: Sunday 8:00-10:45

Poster Take-down: Sunday, 1:00 – 3:00

SECTION TITLES

VEGETABLE CROPS

Building: Omni

Room: Oak

Presiding: Peter Dittmar, Chair

Abstracts: To publish abstract in *HortScience*, see instructions at end of program. Submit on disk at meeting or email to Chair:
pdittmar@ufl.edu

HORTICULTURE

- 8:00 Effect of Carolina Strongback Watermelon Rootstock on Grafted Greenhouse Cucumber Production.** Richard L. Hassell*, Coastal Research and Education Center, Clemson University, Charleston, SC 29414. (rhassel@clemson.edu)
- 8:15 Evaluating Nutrient Uptake in Leafy Greens and Vegetable Crop Species Grown in Peat-based Substrate and Hydroponics.** Lauren Houston and Ryan Diskson. Department of Horticulture, University of Arkansas, 311 Plant Science Building, Fayetteville, AR 72701.
- 8:30 Effect of multi-cropped plastic mulching on yellow squash and zucchini production.** Andre Luiz Bicaia da Silva*, Joara Secchi Candian, Elizanilda Ramalho do Rego. Department of Horticulture, University of Georgia, Tifton, GA 31793. (adasilva@uga.edu)
- 8:45 Farmers' Opinions of Cover Crop Integration in Specialty Crop Systems in Puerto Rico and St. Croix, USVI.** Danielle Treadwell^{1*}, Jose Perez¹, Stuart Wiess², and David Campbell¹. ¹P.O. Box 110690, Horticultural Sciences Department, University of Florida-IFAS, Gainesville, FL 32611, ²University of the Virgin Islands (UVI) Agricultural Experiment Station (AES), RR#1, Box 10000, Kingshill, U.S. Virgin Islands 008050 (dttreadw@ufl.edu)
- 9:00 Break**
- 9:15 Weed Control in Bok Choy following Cover Crops with and without S-metolachlor.** Peter J. Dittmar^{1*} and Nathan Boyd². ¹Horticultural Sciences Department, University of Florida, Gainesville, FL 32611, ²Gulf Coast Research and Extension Center, Wimauma, FL 33598. (pdittmar@ufl.edu)
- 9:30 Comparison of Tomato Genotypes Grown Under Conventional and Organic Production System for Nutrient Composition and Fruit Quality.** Dilip R. Panthee^{1*} and Penelope Perkins-Veazie². ¹Department of Horticultural Science, North Carolina State University, Mountain Horticultural Crops Research & Extension Center, 455 Research Dr., Mills River, NC 28759. ²Department of Horticultural Science, North Carolina State University, Plants for Human Health Institute, NC Research Campus, 600 Laureate

HORTICULTURE

- FLORICULTURE, ORNAMENTALS AND TURF**
- Building:** Omni
Room: Charred
Presiding: Jeb Fields, Chair
Abstracts: To publish abstract in *HortScience*, see instructions at end of program. Submit on disk at meeting or email to Chair: Jeb Fields, jfields@agcenter.lsu.edu
- 8:00 Current and future supply and demand for growing media in North America.** Brian E. Jackson, Department of Horticultural Science, NC State University, Raleigh, NC 27695. (Brian_Jackson@ncsu.edu)
- 8:15 Advancements in soilless substrates: Engineering, composition, and amendments.** Brian E. Jackson, Department of Horticultural Science, NC State University, Raleigh, NC 27695. (Brian_Jackson@ncsu.edu)
- 8:30 Marketing Matters: Interpreting survey-based heatmaps to understand consumer preferences for elements of Facebook posts designed to market petunias online.** Anissa M. Zagonel^{1*}, Lauri M. Baker², Cheryl R. Boyer³, and Hikaru H. Peterson⁴, ¹Center for Rural Enterprise Engagement, University of Florida, Gainesville, FL 32611, ²Department of Agricultural Education and Communication, University of Florida, Gainesville, FL 32611, ³Department of Horticulture and Natural Resources, Kansas State University, Manhattan, KS 66506, ⁴Department of Applied Economics, University of Minnesota, St. Paul, MN 55108. (azagonel@ufl.edu)
- 8:45 Transdisciplinary work in horticulture: The center for rural enterprise engagement.** Cheryl R. Boyer^{1*}, Hikaru H. Peterson², and Lauri M. Baker³. ¹Department of Horticulture and Natural Resources, Kansas State University, Manhattan, KS 66506, ²Department of Applied Economics, University of Minnesota, St. Paul, MN 55108, ³Department of Agricultural Education and Communication, University of Florida, Gainesville, FL 32611. (crboyer@ksu.edu)
- 9:00 Break**
- 9:15 Rain or irrigation: A container plant producer's challenge.** Tom Yeager*, Department of Environmental Horticulture, University of Florida, IFAS, Gainesville, FL 32611. (yeagert@ufl.edu)

HORTICULTURE

- 9:30 Fertilizer strategies to improve post-production performance of container-grown petunia.** Ryan Dickson, Department of Horticulture, University of Arkansas, Fayetteville, AR 72701. (ryand@uark.edu)
- 9:45 Evaluating peat substrate amended with wood products for effects on nitrogen immobilization and plant performance with petunia.** Kalyn Helms, Department of Horticulture, University of Arkansas, Fayetteville, AR 72701 (kmhelms@uark.edu)
- 10:00 Improving Nursery Crop Pest Management with Precision Pesticide Application Technology.** Amy Fulcher^{1*}, Lauren Fessler¹, Wesley Wright², Heping Zhu³, Trystan Bordeau¹, and Luc Nadaud¹, ¹ Department of Plant Sciences, 2505 E.J. Chapman Drive, University of Tennessee, Knoxville, TN 37996-4500, ² Biosystems Engineering and Soil Science, 2506 E.J. Chapman Drive, University of Tennessee, Knoxville, TN 37996-4531, and ³USDA-ARS, 1680 Madison Ave., Wooster, OH 44691. (afulcher@utk.edu)

FRUIT CROPS

- Building:** Omni
Room: Barley
Presiding: Justin Scheiner, Chair
Abstracts: To publish abstract in *HortScience*, see instructions at end of program. Submit on disk at meeting or email to Chair: jscheiner@tamu.edu
- 8:00 Higher Renovation Pruning Height Improves Early Yields of 'Woodard' Rabbiteye Blueberry.** Eric T. Stafne^{1*} and Barbara J. Smith², ¹South Branch Experiment Station, Coastal Research and Extension Center, Mississippi State University, 810 Hwy 26 West, Poplarville, MS 39470, ²USDA-ARS Thad Cochran Southern Horticultural Laboratory, 810 Hwy 26 West, Poplarville, MS 39470. (eric.stafne@msstate.edu)
- 8:15 Additional Nitrogen Application May Reduce White Drupelet Disorder in 'Sweetie Pie' Blackberry.** Eric T. Stafne^{1*} and Barbara J. Smith², ¹South Branch Experiment Station, Coastal Research and Extension Center, Mississippi State University, 810 Hwy 26 West, Poplarville, MS 39470, ²USDA-ARS Thad Cochran Southern Horticultural Laboratory, 810 Hwy 26 West, Poplarville, MS 39470. (eric.stafne@msstate.edu)

HORTICULTURE

- 8:30 Assessment of Size Controlling Peach Rootstocks for High Density Orchards in Alabama.** Elina D. Coneva, 101 Funchess Hall, Department of Horticulture, Auburn University, Auburn, AL 36849. (Edc0001@auburn.edu)
- 8:45 Response of Young Field-Grown Kiwifruit (*Actinidia chinensis* Planch. and *A. deliciosa* A. Chev.) Plants to Fall Frost.** Tim Hartmann^{1*}, David Creech², Larry Stein³, and Justin Scheiner¹ ¹Department of Horticultural Sciences, Texas A&M University, College Station, Texas 77843 ²SFA Gardens, Stephen F. Austin State University, Nacogdoches, TX 75962, ³Department of Horticultural Sciences, Texas A&M University, Uvalde, TX 78802 (t-hartmann@tamu.edu)
- 9:00 Breeding for Prunus Rootstock Tolerance to Replant Diseases.** Ksenija Gasic^{1*}, Sarah Miller¹, Goran Barac², Christopher Saski¹, Guido Schnabel¹ and Gregory Reighard¹, ¹Department of Plant and Environmental Sciences, Clemson University, Clemson, SC 29634-0310, ²Faculty of Agriculture, University of Novi Sad, Novi Sad 21000, Serbia . (kgasic@clemson.edu)
- 9:15 Break**
- 9:30 Evaluation of Growth and Physiological Responses of HLB Affected Citrus Trees to Thermotherapy.** Pawan Kumar*, Megan Dewdney, Evan Johnson and Tripti Vashisth, Citrus Research and Education Center, University of Florida/IFAS, 700 Experiment Station Rd. Lake Alfred, FL 33850. (tvashisth@ufl.edu)
- 9:45 Exploring Potassium Balance in Southeastern Peach Orchards.** Brian T. Lawrence^{1*}, Qi Zhou^{2,1}, and Juan Carlos Melgar¹, ¹Department of Plant and Environmental Sciences, Clemson University, Clemson, SC 29631, ²University of California Cooperative Extension, Santa Clara County, 1553 Berger D. Bldg. 1, San Jose, CA 95112. (btlawre@g.clemson.edu)
- 10:00 History, Inventory and Contributions of the Small Fruit Program at Stephen F. Austin State University.** David Creech* and Malcolm Turner, SFA Gardens, Stephen F. Austin State University, Nacogdoches, TX 75962. (dcreech@sfasu.edu)
- 10:15 Effect of Calcium Sulfate on Southern Highbush Blueberry Establishment.** Erick D. Smith^{1*}, Chelsea Matewe², Jonathan Oliver², ¹Department of Horticulture, University

HORTICULTURE

of Georgia – Tifton Campus
31793, ²Department of Pathology, University of
Georgia – Tifton Campus 31793.
(ericks@uga.edu)

- 10:30 Fruit Characterization of Ecuadorian *P. serotina* subsp. *Capuli*.** Sakshi Pathania^{1*}, Juan C. Carrasco², Carlos R. Chavez², Luis Fiallos³, and Dario J. Chavez¹ ¹University of Georgia, Department of Horticulture, Griffin, GA, USA; ²Faculty of Natural Resources, Escuela Superior Politécnica de Chimborazo, Riobamba, Ecuador; ³Faculty of Livestock Sciences, Escuela Superior Politécnica de Chimborazo, Riobamba, Ecuador. (sp28191@uga.edu)

POSTHARVEST AND BIOTECHNOLOGY

Building: Omni

Room: Wheat

Presiding: Anne Randle, Chair

Abstracts: To publish abstract in *HortScience*, see instructions at end of program. Submit on disk at meeting or email to Chair: arandle@uga.edu

- 8:00 Partial Extraction of Aromatic Compounds from Dehydrated Herbs: Basil (*Ocimum* sp. L.) and Cilantro (*Coriandrum sativum* L.).** Niels Maness^{1*}, Elif Kalkan¹, Jasreen Sekhon², Carol Jones³, and Donna Chr¹, ¹Department of Horticulture and L.A., 358 Ag. Hall, Oklahoma State University, Stillwater, OK 74078, ²Department of Culinary Arts and Food Science, Drexel University, 3141 Chestnut Street, Philadelphia, PA 19104, ³Department of Biosystems and Agricultural Engineering, 216 Ag. Hall, Oklahoma State University, Stillwater, OK 74078. (niels.maness@okstate.edu)

- 8:15 Diabetes to Cancer: Plants in Oklahoma That Can Make a Difference.** Niels Maness^{1*}, Jonathan Fenhaus², Katelyn Stenmark¹ and Lu Zhang¹, ¹Department of Horticulture and Landscape Architecture, Oklahoma State University, Stillwater, OK 74078, ²Department of Biology and Chemistry, University of Science and Arts of Oklahoma, Chickasha, OK 73018. (niels.maness@okstate.edu)

- 8:30 Postharvest Extraction of Pecan Oil: Quantitation of Tocopherols, Tocotrienols and Squalene in Oklahoma Pecan Cultivars.** Jonathan Fenhaus^{1*}, Niels Maness² and Lu Zhang², ¹ Department of Biology and Chemistry, University of Science and Arts of Oklahoma, Chickasha, OK 73018, ²Department

HORTICULTURE

of Horticulture and Landscape Architecture,
Oklahoma State University, Stillwater, OK
74078. (jfen8162@usao.edu)

- 8:45 Harvesting, Extraction Processing and Purification of Podophyllotoxin from Eastern Red Cedar (*Juniperus virginiana* L.) in Oklahoma.** Katelyn Stenmark* and Niels Maness, Department of Horticulture and Landscape Architecture, Oklahoma State University, Stillwater, OK 74078. (katie.stenmark@okstate.edu)
- 9:00 Hollow heart disorder and its relationship to cell wall pectins in grafted and non-grafted 'Liberty' watermelon.** Marlee A. Trandel^{1*}, Penelope Perkins-Veazie¹, Suzanne Johanningsmeier², Jonathan Schultheis³ and Chris Gunter³, ¹North Carolina State University, Department of Horticultural Sciences, 600 Laureate Way, Plants for Human Health Institute, Kannapolis NC 28081, ²North Carolina State University, Department of Food, Bioprocessing and Nutrition Sciences, 400 Dan Allen Drive, Schaub Hall, Raleigh NC 27606, ³North Carolina State University, Department of Horticultural Sciences, 2721 Founders Drive, Kilgore Hall, Raleigh NC 27606. (matrande@ncsu.edu)
- 9:15 Break**
- 9:30 Pumpkin Postharvest: Stem Retention and Moisture with Storage.** Penelope Perkins-Veazie^{1*}, Jonathan Schultheis² and Travis Birdsell³, ¹Plants for Human Health Institute, Department of Horticultural Science, North Carolina State University, Kannapolis, NC 28081, ²2721 Founders Dr, Department of Horticultural Science, North Carolina State University, Raleigh, NC 27695, ³134 Government Circle Suite 202, Jefferson, NC 28640. (penelope_perkins@ncsu.edu)
- 9:45 Evaluating Rhubarb as a New Crop for North Carolina.** Penelope Perkins-Veazie^{1*}, Danelle Cutting², Der Holcomb³, Lenny Rogers³, Kira Sims⁴, Hunter Barrier⁵, Matt Lenhardt⁶, Lauren Hill⁷, April Vigardt⁸, Michael Fine⁹ and Elina Snyder¹⁰, ¹Plants for Human Health Institute, Department of Horticultural Science, North Carolina State University, Kannapolis, NC 28081, ²217 S Main St, Salisbury, NC 28144, ³151 W Main Ave, Taylorsville, NC 28681, ⁵8530 Sherrills Ford Rd, Salisbury, NC 28147, ⁶444 Bristol Dr, Statesville, NC 28677, ⁷15 Cabarrus Ave W, Concord, NC 28027, ⁸1175 S Brady Ave # 2, Newton, NC 28658, ⁹2727 Old Concord Rd,

HORTICULTURE

Sailsbury NC 28146, ¹⁰416 Executive Dr,
Wilkesboro, NC 28697.
(penelope_perkins@ncsu.edu)

- 10:00 Impact of Postharvest and Processing of Fruits and Vegetables on Nutritional Security.** Bhimanagouda S. Patil*, G.K. Jayaprakasha, Jashbir Singh and Pratibha Acharya, Vegetable and Fruit Improvement Center, Department of Horticultural Sciences, USDA National Center of Excellence, Texas A&M University, College Station, TX 77843. (b-patil@tamu.edu)
- 10:15 Effect of Ethylene De-greening Treatment on Fruit Quality and Postharvest Storage Life of HLB-affected Mandarin Cultivars.** Faisal Shahzad^{1*}, Jeffrey K. Brecht², Yu Wang¹, Fred Gmitter¹, Mark A. Ritenour³ and Tripti Vashisth¹, ¹700 Experiment Station Rd, Citrus Research and Education Center, Lake Alfred, FL 33850, ²Horticulture Sciences Department, IFAS, Gainesville, University of Florida, FL 32611, ³Indian River Research and Education Center, Fort Pierce, University of Florida, FL 34945-3138. (amiabu@ufl.edu)
- 10:30** Preliminary investigation of role of rootstock cultivar on metabolite redox control in "Aztec Fuji" apple. Floyd M. Woods*, Elina Coneva, Dylan Teel, and Nylan Holmes, Department of Horticulture, Auburn University, Auburn, AL 36849-5408. (woodsfm@auburn.edu).

ANNUAL BUSINESS MEETING AND AWARDS PROGRAM

Building: Omni

Room: Commonwealth 3

Time: 11:00 12:30

Presiding: Bodie Pennisi, President

WORKING GROUPS

(Contact Chairs for Agenda and order of business meeting and presentations if not given)

Watermelon Research Group

Presiding: Daniel Engle, Chair

engel@purdue.edu

Building: Omni

Room: Olmsted 3

Friday: 1:00-5:00

Saturday: 8:30-5:00

Friday, January 31, 2020

1:00 Introductions: All in attendance

HORTICULTURE

- 1:45 Effects of Early Grafted Watermelons on Three Commercial Watermelon Cultivars Using Row Covers and Colored mulches.** Dr. Richard L. Hassell, Clemson University, Coastal Research and Education Center, Charleston, SC USA
- 2:00 Effects of Hybrids Generated from Rootstock (Carolina Strongback) on Earliness, Fruit Quality, and Yields Grafted on Cultivar Sweet Dawn.** Dr. Richard L. Hassell, Clemson University, Coastal Research and Education Center, Charleston, SC USA
- 2:20 Performance of Grafted Watermelons at Reduced Density in Indiana.** Weijing Guan, Purdue University.
- 2:40 Discoveries in cell wall architecture of watermelon with hollow heart.** Marlee A. Trandel*¹, Penelope Perkins-Veazie¹, Suzanne Johanningsmeier², Jonathan Schultheis³ and Chris Gunter North Carolina State University, Plants for Human Health Institute, North Carolina State University.
- 3:00 20 minutes break**
- 3:20 Particle Films and Growth Regulators for Stress Reduction in Watermelons.** Gordon C. Johnson*, Department of Plant and Soil Sciences, University of Delaware, Elbert N. and Ann V. Carvel Research and Education Center, 16483 County Seat Highway, Georgetown, DE 19947. (gcjohn@udel.edu)
- 3:35 Break**
- 3:55 A First in the Produce Industry: The Collection and Grower Access to Global Watermelon Research-**Bob Morrissey, National Watermelon Association.
- 4:15 Watermelon Makes Headlines – 2019.** Mark Arney, Executive Director of the National Promotion Board
- 4:35 Adjourn**
- Saturday, February 1, 2020**
- 8:30 Introductions: All in attendance**
- 9:15 Regional Watermelon Production Updates**
Florida, Georgia, Carolinas,
Delaware/Maryland, Mid-West, West USA
- 9:45 Variety updates from Seed Companies**
- 10:00 2019 Seedless Watermelon Evaluation in Georgia.**
- 10:15 2019 South Carolina Seedless and Mini Watermelon Variety Trial Results.**
- 10:30 20 Minutes Break**

HORTICULTURE

10:50 2019 Watermelon Variety Evaluation in Indiana

11:05 Standard and Mini Seedless Watermelon Variety Trials Conducted by University of Delaware Cooperative Extension in 2019. Gordon Johnson* and Emmalea Ernest, Department of Plant and Soil Sciences, University of Delaware, Elbert N. and Ann V. Carvel Research and Education Center, 16483 County Seat Highway, Georgetown, DE 19947. (gcjohn@udel.edu)

11:20 A new tool to help growers selecting watermelon varieties and pollinizers. Andre Luiz Biscaia Ribeiro da Silva, Ph.D., University of Georgia.

11:35 Lunch Break

1:30 Quantitative trait loci (QTL) associated with resistance to major diseases of watermelon identified by the CucCAP team. Sandra Branham, Pat Wechter, Shaker Kousik, Kai-shu Ling, and Amnon Levi.

1:50 Is There Light at the End of the Gummy Stem Blight Tunnel? Cecilia McGregor^{1*}, Winnie Gimode², Lincoln Adams², and Jorge Reyes¹, ¹Department of Horticulture, University of Georgia, 1111 Miller Plant Science Bldg., Athens, GA, 30302, ²Institute of Plant Breeding Genetics and Genomics, University of Georgia, 1111 Miller Plant Science Bldg., Athens, GA, 3030630602. (cmcgre1@uga.edu)

2:10 A web application designed to search for pest management solutions for watermelon and other vegetables. Dan Egel, Dept. of Botany and Plant Pathology, Purdue University

2:40 Management of Fusarium wilt of watermelon transplants in the greenhouse. Dan Egel, Dept. of Botany and Plant Pathology, Purdue University

WRDG Business

3:00 Hot Topics
Website
New vice-chair selection
Upcoming meetings

4:00 Adjourn

Southern Fruit Workers

Presiding: Rachel Itle
ashi@uark.edu

Building: Omni
Room: Olmsted 2
Friday: 9:00 am – 5:00 pm

HORTICULTURE

Horticulture Administrators

Presiding: Dean Kopsell, Chair
dean.kopsell@ufl.edu

Building: Omni

Room: Clifton

Friday: 1:00 pm – 5:00 pm

National Sweetpotato Working Group

Presiding: Lina Quesada

Location: Does not meet with SRASHS this year
Meets with US Sweetpotato Council
January 24-25
Nashville, TX

SAAS Meetings

SAAS Board Meeting

Bldg/Room: Omni Commonwealth 3

Time: 2:30 PM–3:30 PM

SAAS General Business Meeting

Bldg/Room: Omni Commonwealth 3

Time: 4:00 PM–4:30 PM

SAAS Social/Super Bowl Party

Place: Griff's Restaurant

Time: 5:00 PM – until

RURAL SOCIOLOGY

**Southern Rural Sociological Association
51st Annual Meeting**

***Pathways for Equity in Development: Exploring
the Past and
Informing the Future through the Rural Social
Sciences***

Louisville, KY

February 1-3, 2020

Concurrent with Southern Association of Agricultural
Scientists (SAAS)

Program at a Glance

Abbreviations

Organizations

Southern Association of Agricultural
Scientists: SAAS
Southern Rural Sociological Association:
SRSA

Saturday, February 1, 2020

2: 00 pm Preconference Field trip to Buffalo Trace,
Frankfort, KY

Sunday, February 2, 2020

7:45 am – 3:30 pm, Omni Hotel- Second Street
Prefunction: Registration

10:00 am – 4:00 pm, Omni Hotel-Olmsted 4: Poster
Session

8: 00 am – 9: 00 am, Omni Hotel-Olmsted 6: SRSA
Executive Committee Meeting

9:15 am – 10:35 am, Omni Hotel-Olmsted 5, Session
1 – Behavior, Culture & Identity

9: 15 am – 10:35 pm, Omni Hotel-Olmsted 6, Session
2 – Disparities in Health & Social Issues

9:15 am – 10:35 pm, Omni Hotel-Olmsted 7, Session
3 – Church, Religion, Communities

10:45 am –12:00 pm, Omni Hotel-Olmsted 5, Session
4 – Farm Risk, Decision Making, and Voting Behavior

10:45 am – 12:00 pm, Omni Hotel-Olmsted 6,
Session 5 – Migration, Farm Workers, and Workforce
Development

RURAL SOCIOLOGY

10:45 am- 12:00 pm, Omni Hotel-Olmsted 7, Session
6 – Emerging technologies & Practices

12:00 pm to 1:20 pm Lunch (on your own)

1:30 pm – 2:50 pm, Omni Hotel-Olmsted 5, Session 7
– Small-scale Marketing Constraints and
Opportunities

1:30 pm – 2:50 pm, Omni Hotel-Olmsted 6, Session 8
– Education & Outreach Services

1:30 pm – 3:10 pm, Omni Hotel-Olmsted 7, Session 9
– Food Insecurity & Food Systems, and Impacts

3:00 pm – 4: 00 pm, Omni Hotel-Olmsted 4: Posters
Viewing

4:00 pm – 4:30 pm, Omni Hotel -Commonwealth 3:
SAAS General Business Meeting

5:00 pm, Griff's 133W Liberty St: SAAS Social &
Super Bowl Party

Monday, February 3, 2020

7:45 am – 3:00 pm, Omni Hotel- Street Prefunction:
Registration

8:00 am – 9:00 am, Omni Hotel-Olmsted 6: Pre-
Organized panel

9:00 am – 3:00 pm, Omni Hotel-Olmsted 4: Poster
Session

9:15 am – 11: 00 am, Omni Hotel-Olmsted 5, Session
10 – Community Development, Resilience &
Sustainability

9:15 am – 11:00 am Omni Hotel-Olmsted 6, Session
11 – Theory, Research Methods, and Practices

11:30 am – 1:00 pm, Omni Hotel, Commonwealth 1:
SRSA Awards Luncheon and Presidential Address

1:30 pm – 2:30 pm Omni Hotel-Olmsted 6, Session
12 – Education, Rurality & Quality of Place

2:40 pm – 3: 20 pm, Omni Hotel-Olmsted 6, SRSA
Journal & Open Discussion

3:30 pm – 4:30 pm, Omni Hotel, Omni Hotel-Olmsted
6: SRSA Business Meeting

5:00 pm – 6:00 pm, Omni Hotel, Omni Hotel-Olmsted
6: SRSA Executive Council Meeting

6:30 pm: TBD: SRSA Presidential Reception

RURAL SOCIOLOGY

Detailed Program

Sunday, February 2, 2020

9:15 am – 10:35 am, Omni Hotel-Olmsted 5, Session 1 – Behavior, Culture & Identity

Moderator: Marcus Bernard

"My Name's Cletus": Place and Rural Children's Response to Urbanormative Media

Julia M. Miller, University of Kentucky

Cultural and Individual Shame in Appalachia

MaryAnn Thrush, Lincoln Memorial University

Lesbians Love the Land: An Exploration of the Literature Regarding LGBTQ+ Farmers and Sustainability

Alessandra Del Brocco, University of Kentucky

More than Race: Black Farmers in the Rural South

Marcus Bernard, Kentucky State University; Rosalind Harris, University of Kentucky

9: 15 am – 10:35 pm, Omni Hotel-Olmsted 6, Session 2 – Disparities in Health & Social Issues

Moderator: Patricia H. Dyk

Comparing the Effects of Economic and Policy Characteristics on Diabetes, Heart Disease and Stroke Mortality in the American South: A Spatial Analysis Using Geographically Weighted Regression

Michael J. Swain, University of Florida; Glenn D. Israel, University of Florida

Early Childhood Malnutrition and Gender in Nigeria

Aramide Kazeem, University of West Georgia
John M. Musalia, Western Kentucky University

An Alternative Approach to Teaching Social Inequality

Brooklynn J. Wynveen, Sam Houston State University

Challenges Accessing Healthcare: Insights from Rural Low-Income Mothers

Patricia H. Dyk, University of Kentucky; Heidi Radunovich, University of Florida; Yoshie Sano, Washington State University; Ann

RURAL SOCIOLOGY

Berry, University of Tennessee; Katherine Counts, University of Kentucky

9:15 am –10:35 pm, Omni Hotel-Olmsted 7, Session 3 – Church, Religion, and Communities

Moderator: Robert Zabawa

Ayuda en el Camino de la Muerte: Benevolence, Churches, and the Caravan of Migrants

Elijah Cox, Lee University

Religion and Happiness: Data from Two Rural Texas Studies

Kristen Gustafson, Sam Houston State University; Gene L. Theodori, Sam Houston State University

The Relationship between the Church, Land Ownership and Heir Property for the African American Community in Macon County, Alabama

Kara Woods, Tuskegee University; Dr. Robert Zabawa, Tuskegee University and Dr. Souleymane Fall; Tuskegee University

10:45 am –12:00 pm, Omni Hotel-Olmsted 5, Session 4 – Farm Risk, Decision Making, and Voting Behavior

Moderator: Bilal Jones

Demographic Characteristics of Risk Aversive Farmers in Rural Alabama

Lila B. Karki, David N.O. Tackie, Uma Karki, and Raymon Shange Tuskegee University

Does Extension Agent/Client Homophily Affect Customer Satisfaction and Perceived Benefits?

Jyothi Swaroop Bommidi, University of Florida; Glenn D Israel, University of Florida

An analysis of food desert residents' interest in modifying intake of major food nutrients: a Multidimensional Scaling approach.

Terrence Thomas, North Carolina A&T State University; Cihat Gunden, Ege University; Befikadu Legesse, Smart-Eco Consulting,

An Analysis of the voting shift in Kentucky's General Election for Governor from 2015-2019

Bilal Jones, Kentucky State University, Buddhi Gyawali, Kentucky State University, Jeremy Sandifer, Kentucky State University

RURAL SOCIOLOGY

10:45 am – 12:00 pm, Omni Hotel-Olmsted 6,
Session 5 – Migration, Farm Workers, and Workforce
Development

Moderator: John Green

Patterns of Out-Migration from the Mississippi Delta

Vanessa Parks, University of Mississippi;
Jamiko Deleveaux, University of Mississippi;
Lynn C. Woo, University of Mississippi; John
J. Green, University of Mississippi

The Value of Social Networks and Social Capital: Minorities and Migrants in Kentucky Appalachia

Jennifer Lanham, Campbellsville University

Hidden Masculinity: Gendered Actions and Symbolic Power among Seasonal Farm Workers

Kevin S. Alejandrez, University of Kentucky

Workforce Development in the Gulf Coast and Delta Regions of Mississippi: Insights and Lessons Learned to Inform Systems Change

John J. Green, University of Mississippi;
Stephanie Poiroux, University of Mississippi

10:45 am – 12:00 pm, Omni Hotel-Olmsted 7,
Session 6 – Emerging Technologies & Practices

Moderator: Brooklynn J. Wynveen

Student Support for Wind Energy in the United States: Real Division or Overhyped Partisanship?

Jessica Crowe, Southern Illinois University,
Carbondale

Societal, ethical and economic implications of new agricultural technologies in the 21st Century

Enefiok Ekanem, Tennessee State
University; Mary Mafuyai, Tennessee State
University

Reframing Socio-technological Possibilities in Rural Farmscapes: The Critical Convergence of Disability and Human-centered Design for Farmworker Health and Mobility

Kim Niewolny, Virginia Tech; Garland Mason,
Virginia Tech

RURAL SOCIOLOGY

The Impact of Natural Resource Extraction by Multinational Corporations on Regional Economic Development: A Comparative Case Study of Oil in Sudan and Forestry in Alabama

Dalal Alkordi, Youssouf Diabate, Robert
Zabawa and Godfrey Vincent; Tuskegee
University Integrative Public Policy and
Development Ph.D. Program

12:00 PM to 1:20 PM Lunch (on your own)

1:30 pm – 2:50 pm, Omni Hotel-Olmsted 5, Session 7
– Small-scale Marketing Constraints & Opportunities

Moderator: David Tackie

Challenges and Opportunities at Farmers Markets: A Case of Small Producers in Alabama's Black Belt

Jasmine Ratliff, Tuskegee University

Building Food Justice Markets: Opportunities and Challenges in the Southeast Region

Keiko Tanaka, University of Kentucky; Karen
Rignall, University of Kentucky; Heather
Hyden, University of Kentucky; Margarita
Valencia, University of Tennessee at
Knoxville; Carlos Trejo-Pech, University of
Tennessee at Knoxville; Teya Cuellar, Peace
Corps; Nathaniel Messer, University of
Kentucky; and Alessandra Del Brocco,
University of Kentucky

Eco-Labeled Seafood as Part of the Sustainability Solution: Private Sector and Environmental NGO Viewpoints and Actions in the Canadian Context

Anthony Winson, University of Guelph; Jin
Young Choi, Sam Houston State University

A Comparative Analysis of Selected Farm, Economic, and Marketing Characteristics of Small Livestock Producers in Three Southeastern States of the U.S.

David Tackie, Tuskegee University; Jannette
Bartlett, Tuskegee University; Nicole Nunoo,
Virginia Polytechnic Institute and State
University

RURAL SOCIOLOGY

1:30 pm – 2:50 pm, Omni Hotel-Olmsted 6, Session 8
– Extension & Outreach services & Opportunities

Moderator: Marion Simon

What two sisters can do with one acre when assisted by Extension

Tehran Jewell*, Kentucky State University
and Marion Simon, Kentucky State University

Holding and Sales of Live Catfish: an Economic Opportunity

Richard Bryant* Kentucky State University,
Siddhartha Dasgupta, Kentucky State University

Understanding variations in ecological productivity of farmland-what farmers need to know

Smriti Kandel, Kentucky State University;
Buddhi Gyawali, Kentucky State University;
Jeremy Sandifer, Kentucky State University

From Hemp to Tobacco and Back: Perspectives of Kentucky State University's Extension Agents on the "New" Hemp Initiative

Marion Simon, Kentucky State University;
Austin Wright, Kentucky State University;
Laura Rogers, Kentucky State University

1:30 pm – 3:10 pm, Omni Hotel-Olmsted 7, Session 9
– Food Insecurity, Food Production and Impacts

Moderator: Douglas H. Constance

Can Small-Scale African American Farmers Help Alleviate Food Insecurity in the Alabama Black Belt?

Folashade Adalumo-Ntam*, Robert Zabawa,
Souleymane Fall and Raymon Shange;
Tuskegee University Integrative Public Policy
and Development Ph.D. Program

Influence of Food Attributes on Purchasing Behavior of Food Desert Residents: A Multidimensional Scaling Approach

Terrence W. Thomas, North Carolina
Agricultural and Technical State University;
Freda Elikem Dorbu, North Carolina
Agricultural and Technical State University;
Kurt Taylor, North Carolina Agricultural and
Technical State University

RURAL SOCIOLOGY

Food Insecurity Awareness and Resources at the University of Mississippi
Summer Jefferson; Anne Cafer; Georgianna
Mann, University of Mississippi

Food Sovereignty - Food Security- Food Safety - American Farmers: Where do they intersect in a sustainable world?

Cynthia Rice, Kentucky State University;
Buddhi Gyawali, Kentucky State University;
Marion Simon, Kentucky State University;
Shawn Lucas, Kentucky State University;
Leigh Whittinghill, Kentucky State University

Beef Production and Climate Change: The Industry Response

Douglas H. Constance, Sam Houston State
University; George Apreza, Sam Houston
State University

3:00 pm – 3:50 pm, Omni Hotel-Olmsted 4: Posters
Viewing

4:00 pm – 4:30 pm, Omni Hotel - Commonwealth 3:
SAAS General Business Meeting

5:00 pm, Griff's 133W Liberty St: SAAS Social &
Super Bowl Party (across the street from hotel)

Monday, February 3, 2020

7:45 am – 3:00 pm, Omni Hotel-Second Street
Prefunction: Registration

8:00 am – 9:00 am, Omni Hotel-Olmsted 6: Pre-
Organized Panel

9:00 am – 3:00 pm, Omni Hotel-Olmsted 4: Poster
Session

9:15 am – 11:00 am, Omni Hotel-Olmsted 5, Session
10 – Community Development, Resilience &
Sustainability

Moderator: Anne Cafer

Rethinking Sustainable Community Development: Incorporating Cultural and Social Capital

Nicole Nunoo, Virginia Polytechnic Institute
and State University; Robert Zabawa,
Tuskegee University; Souleymane Fall,
Tuskegee University; David Tackie,
Tuskegee University; Joseph Essamuah-
Quansah, Tuskegee University; Tasha
Hargrove, Tuskegee University; Kim
Niewolny, Virginia Polytechnic Institute and
State University

RURAL SOCIOLOGY

Utilizing community diagnostics data to examine community development and vitality: A rural case study

Abigail Borron, Catherine Jones, Maria Martinez, Anna Strickland, Keith Atkins, Kevan Lamm, & Katie Sanders – University of Georgia

Are They Ready? Assessing Community Resilience in a Rural Florida County

Angela B. Lindsey, University of Florida; Dale Pracht, University of Florida; Randall Cantrell, University of Florida

Mapping Resilience in the Rural South: A Mixed-Methods Investigation of Resilience Building in the MS Delta.

Anne Cafer, University of Mississippi; Jasmine Nyugen, University of Mississippi; James Hawkins, University of Mississippi; Anna Conner, University of Mississippi; Emily Shy, University of Mississippi

9:15 am 11:00 am Omni Hotel-Olmsted 6, Session 11 – Theory, Research Methods, and Practices

Moderator: Clayton Smith

Neoclassical Economics Dismissal of the Collective in Cooperatives: Producing conceptual absence with “vaguely defined property rights”

Tom Gray, USDA, Co-op. Programs & Co-op Center, University of Saskatchewan

Follow-up contact effectiveness in social surveys: An analysis of survey contact protocols

Glenn D. Israel, University of Florida, Gainesville; Harsha Elizabeth James, University of Florida, Gainesville

More than Altruism: An Examination of Dr. Martin Luther King Jr.’s Involvement in the Chicago Campaign and Protest of the Vietnam War

Stephanie Poiroux, University of Mississippi; Dr. Willa Johnson, University of Mississippi

Prolegomena to an Integrated Field Theory

D. Clayton Smith, Western Kentucky University

11:30 am – 1:00 pm, Omni Hotel, Commonwealth 1: SRSA Awards Luncheon and Presidential Address

RURAL SOCIOLOGY

1:30 pm – 2:30 pm Omni Hotel-Olmsted 6, Session 12 – Education, Rurality & Quality of place

Moderator: Edwin Chavous

Building Participation among College Students for the 2020 Census

Jamiko Deleveaux, University of Mississippi; Randy Morgan, University of Mississippi

Place-based Determinants Impacting the Spatial Distribution of Overdose Across Kentucky Counties: An Exploratory Analysis

Cameron McAlister, University of Kentucky; Julie N. Zimmerman, University of Kentucky; Janet P. Stamatel, University of Kentucky

Does it Really Cost Less to Live in a Rural Area? Evidence from Kentucky

Julie N. Zimmerman, University of Kentucky; Karen Rignall, University of Kentucky; Cameron McAlister, University of Kentucky

2:40 pm – 3: 20 pm, Omni Hotel-Olmsted 6, SRSA Journal and Open Discussion

The Journal of Rural Social Sciences: Evolution and Future Prospects

John J. Green, University of Mississippi Center for Population Studies; Elizabeth Young Sweeney, University of Mississippi Center for Population Studies

3:30 pm – 4:30 pm, Omni Hotel, Omni Hotel-Olmsted 6: SRSA Business Meeting
(All members are encouraged to attend.)

5: 00 pm – 6:00 pm, Omni Hotel, Omni Hotel-Olmsted 6: SRSA Executive Council Meeting

6:30 pm: TBD: SRSA Presidential Reception

Posters

1. Beyond the Dinner Table: Immigrant Labor in Poultry Processing

Jayla Perry, Sam Houston State University; Jin Young Choi, Sam Houston State University

RURAL SOCIOLOGY

2. **After the Harvest: Results of Food Safety Issues**
Cynthia Rice, Kentucky State University;
Buddhi Gyawali, Kentucky State University;
Marion Simon, Kentucky State University;
Shawn Lucas, Kentucky State University;
Leigh Whittinghill, Kentucky State University
3. **Are Rural Schools Doing Enough?: Addressing Mental Health Issues of High School Students**
Erika Minnix, Sam Houston State University;
Jin Young Choi, Sam Houston State University
4. **Exploring diversity in healthcare leadership**
Katherine Counts, University of Kentucky
5. **Farmer's concerns and practices: Responses of farmers on current issues**
Cynthia Rice, Kentucky State University;
Buddhi Gyawali, Kentucky State University;
Marion Simon, Kentucky State University;
Shawn Lucas, Kentucky State University;
Leigh Whittinghill, Kentucky State University
6. **Food Justice through the Youth Scholar Enhancement Program**
Nathaniel Messer, University of Kentucky
7. **Outreach and Community Engagement for the 2020 Census: Insights from Mississippi and Beyond**
John J. Green, University of Mississippi; Lynn Woo, University of Mississippi; Heather Hanna, Mississippi State University; Steve Turner, Southern Rural Development Center/Mississippi State University
8. **The Farm (Family) Dog: Is this a new social issue?**
Marion Simon, Kentucky State University;
Shelley Spiggle, Kentucky State University
9. **Working with Limited-Resource Future Homeowners**
Edwin Chavous, Kentucky State University;
Marion Simon, Kentucky State University

RURAL SOCIOLOGY

10. **Using Agriculture Production and Food Safety Demonstrations to Develop Leaders: Case Study of Four African American Farmers**
Marion Simon, Kentucky State University;
Tehran Jewell, Kentucky State University
11. **Educating Socially Disadvantaged groups in Kentucky for their participation in Federal Programs, KSU experience and lessons learned**
Buddhi Gyawali, Cynthia Rice and Marion Simon, Kentucky State University
12. **A New Taste of Rehab**
Laura Rogers and Marion Simon, Kentucky State University
13. **Socially Disadvantaged Groups (SDG): Identification, Technical Assistance, Service and Education with Pathways to SDG Populations**
Buddhi Gyawali, Cynthia Rice, Marion Simon, Kentucky State University
14. **Using Drones to Assist with Small Farm Management**
William Rogers and Marion Simon, Kentucky State University

Officers of the Southern Rural Sociological Association

President: Jin Young Choi, Department of Sociology, Sam Houston State University, Box 2446, Huntsville, TX 77341-2446, Phone: 936-294-3424, Email: jyc002@shsu.edu

President Elect: David Nii O. Tackie, Agricultural and Resource Economics, Department of Agricultural and Environmental Sciences, Tuskegee University, 204 Morrison-Mayberry Hall, Tuskegee, AL 36088, Phone: 334-727-8813, Email: dtackie@tuskegee.edu

Past President: John J. Green, Center for Population Studies and Department of Sociology and Anthropology, The University of Mississippi, Room 537 Lamar Hall, University, MS 38677-1848, Phone: 662-915-7295, Email: jjgreen@olemiss.edu

Program Chair: Buddhi Gyawali, College of Agriculture, Communities & the Environment Systems, Kentucky State University, 400 East Main St., 225 Cooperative Extension Building, Frankfort, KY 40601, Phone: 502-597-6029, Email: buddhi.gyawali@kysu.edu

RURAL SOCIOLOGY

Program Chair Elect: Anne Cafer, The University of Mississippi, Room 543 Lamar Hall, P.O. Box 1848, MS 38677-1848, Tel: 662-915-7433, Email: amcafer@olemiss.edu

Secretary-Treasurer: Robert Zabawa, Agricultural and Resource Economics, Department of Agricultural and Environmental Sciences, Tuskegee University, 201 Campbell Hall, Tuskegee, AL 36088, Phone: 334-727-8114, Email: rzabawa@tuskegee.edu

Journal Editor: John J. Green, Center for Population Studies and Department of Sociology and Anthropology, The University of Mississippi, Room 537 Lamar Hall, University, MS 38677-1848, Phone: 662-915-7295, Email: jrss@olemiss.edu

2019-2020 SAAS OFFICERS

EXECUTIVE COMMITTEE

President: Paul Patterson, Auburn University, Pmp0003@auburn.edu

President-Elect: Tim Cross, University of Tennessee, tlcross@utk.edu

Member-at-Large: Wayne Ebelhar, Mississippi State University, wayne.ebelhar@msstate.edu

Secretary/Treasurer: Mark Legendre, LSU AgCenter, mlegendre@agcenter.lsu.edu

Past President: Dr. Thomas Coon, Oklahoma State University, thomas.coon@okstate.edu



ASSOCIATION OFFICERS

Agricultural Communications

President: Tobin Redwine, Texas A&M University, tredwine@tamu.edu

Vice President & Program Chair: Annie Specht, The Ohio State University, specht.21@osu.edu

Secretary: Shuyang Qu, Iowa State University, squ@iastate.edu

Treasurer: Ricky Telg, University of Florida, rwtelg@ufl.edu

Graduate Student Rep: Lacey Roberts, Texas A&M University, lacey.roberts10@tamu.edu

Past President: Abigail Borron, University of Georgia, aborron@uga.edu

2019-2020 SAAS OFFICERS

Agricultural Economics

President: Krishna Paudel, Louisiana State University, kpaudel@agcenter.lsu.edu

President-Elect: Tim Woods, University of Kentucky, tim.woods@uky.edu

Secretary & Co-Program Chair: Nathan Smith, Clemson University, nathan5@clemson.edu

Treasurer & Co-Program Chair: Jeffrey Jordan, University of Georgia, jjordan@uga.edu

Past President: Deacue Fields III, University of Arkansas, dcfields@uak.edu

Agricultural Education

President: D. Barry Croom, University of Georgia, dbcroom@uga.edu

President-Elect: Eric Rubenstein, University of Georgia, erubenstein@uga.edu

Secretary: Elena Legendre, University of Georgia, elegend@uga.edu

Past President: Barbara Kirby, North Carolina State University, kirby@ncsu.edu

Agronomy

President: Jason Krutz, Mississippi State University, jkrutz@msstate.edu

Vice President: Nithya Rajan, Texas A&M University, nrajan@tamu.edu

Secretary/Treasurer: Song Cui, Middle Tennessee State University, song.cui@mtsu.edu

Past President: Julie Howe, Texas A&M University, j-howe@tamu.edu

Biochemistry & Biotechnology

(Not meeting with SAAS this year.)

President: Dr. Jeffrey O. Boles, Tennessee Technology University, jboles@tntech.edu

Program Chair: Dr. S. K. Ballal, Tennessee Technology University, skballal@tntech.edu

2019-2020 SAAS OFFICERS

ASSOCIATION OFFICERS (cont'd):

Horticultural Science

President: Bodie Pennisi, University of Georgia, bpennisi@uga.edu

President-Elect: Amy Wright, Auburn University, wrigham@auburn.edu

Secretary/Treasurer: David Reed, Texas A&M University, wdreed@tamu.edu

Past President: Eric Stafne, Mississippi State University, stafne@msstate.edu

Rural Sociological

President: Jin Young Choi, Sam Houston State University, jyc002@shsu.edu

President-Elect: David Nii O. Tackie, Tuskegee University, ntackie@mytu.tuskegee.edu

Program Chair: Buddhi Gyawali, Kentucky State University, buddhi.gyawali@kysu.edu

Program Chair Elect: Anne Cafer, The University of Mississippi, amcafer@olemiss.edu

Secretary-Treasurer: Robert Zabawa, Tuskegee University, rzabawa@tuskegee.edu

Past President: John Green, The University of Mississippi, jjgreen@olemiss.edu

MEETING ROOM INFORMATION

Meeting Rooms Alphabetical

Omni Louisville Hotel

Barley	Level 3
Barrel	Level 3
Butchertown	Level 2
Charred	Level 3
Cherokee Triangle	Level 2
Clifton	Level 2
Commonwealth 1-8	Level 2
Copper	Level 3
Crescent Hill	Level 2
Finishing	Level 3
Germantown	Level 2
Germantown Prefunction Area	Level 2
Hillerich	Level 2
Malt	Level 3
Nulu	Level 2
Oak	Level 3
Old Louisville	Level 2
Olmsted 1-7	Level 2
Olmsted Prefunction	Level 2
Rye	Level 3
Second Street Prefunction	Level 2
Wheat	Level 3

MEETING ROOM INFORMATION

Meeting Floor Diagrams

Omni Louisville Hotel - Level 2

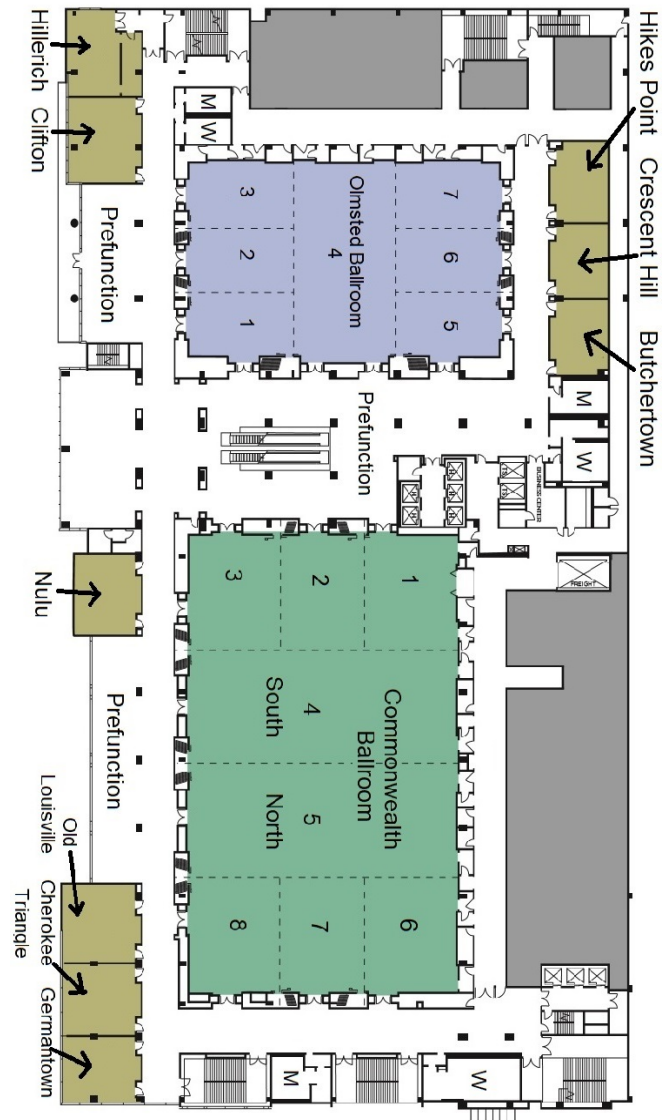

MEETING ROOM INFORMATION

NOTES:

Meeting Floor Diagrams

Omni Louisville Hotel - Level 3

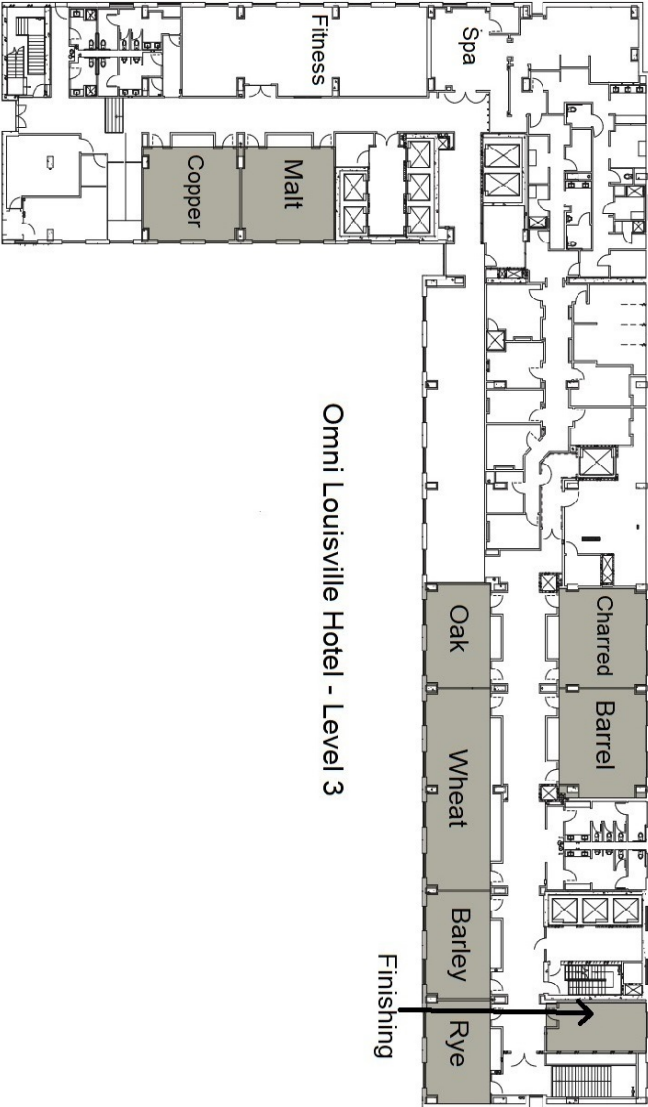

SAAS ANNUAL RECEPTION
Sponsored by

**SOUTHERN FARM BUREAU LIFE
INSURANCE COMPANY**

An affiliate of the following ten state Farm Bureaus:

Arkansas Farm Bureau Federation

Randy Veach, President
P.O. Box 31, Little Rock, AR 72203-0031

Florida Farm Bureau Federation

John Hodlick, President
5700 SW 34th Street, Gainesville, FL 32608

Georgia Farm Bureau Federation

Gerald Long, President
1620 Bass Road, Macon, GA 31210

Kentucky Farm Bureau Federation

Mark Haney, President
P.O. Box 20700, Louisville, KY 40250-0700

Louisiana Farm Bureau Federation

Ronald Anderson, President
P.O. Box 95005, Baton Rouge, LA 70895-9005

Mississippi Farm Bureau Federation

Mike McCormick, President
6311 Ridgewood Road, Jackson, MS 39215

North Carolina Farm Bureau Federation

Larry Wooten, President
P.O. Box 27427, Raleigh, NC 27611-7427

South Carolina Farm Bureau Federation

Harry Ott, President
P.O. Box 754, Columbia, SC 29202

Texas Farm Bureau

Russell Boening, President
P.O. Box 2689, Waco, TX 76702-2389

Virginia Farm Bureau Federation

Wayne F. Pryor, President
P.O. Box 27552, Richmond, VA 23261



**Southern Association
of
Agricultural Scientists**

Upcoming Meeting Locations

SAAS 2021 – Irving, TX (Feb 4-9)

SAAS 2022 – Mobile, AL (Feb 3-8)

***Conference participants are encouraged to write
and thank their state Federation for the support of
the SAAS Social and Reception.***